

Parcel No. _____

93084873

WARRANTY DEED

DEC 15 4 11 PM '93

THIS INDENTURE WITNESSETH; That MARIE VAN SLYKE-BEAN (Grantor)
of Lake County, in the State of Indiana, CONVEY S
AND WARRANT S to PENNY M. HUDDLESTON (Grantee)

of Lake County, in the State of Indiana, for the sum
of Ten Dollars (\$ 10.00) and other
valuable consideration; the receipt and sufficiency of which is hereby acknowledged, the following
described real estate in Lake County, State of Indiana:

Lot 113 in Fashion Terrace, Unit No. 5, in the City of
Crown Point, as per plat thereof recorded in Plat
Book 41 page 9 and re-recorded in Plat Book 41 page 10
in the Office of the Recorder of Lake County, Indiana.

KEY NO.: This document is the property of
the Lake County Recorder!

DEC 15 1993

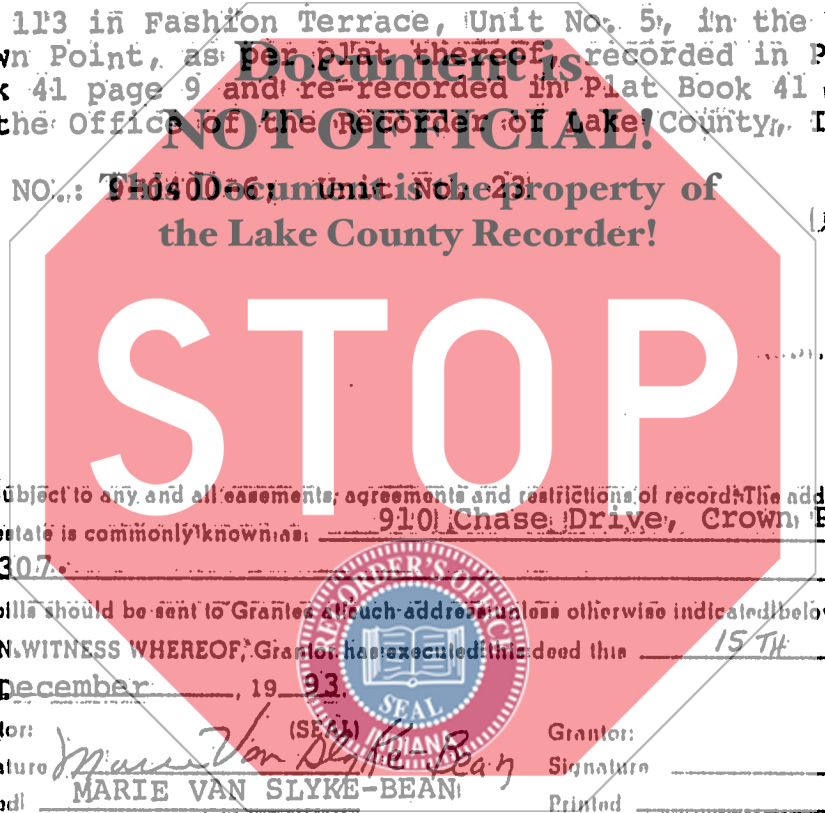

Subject to any and all easements, agreements and restrictions of record. The address of such
real estate is commonly known as: 910 Chase Drive, Crown Point, IN
46307.

Tax bills should be sent to Grantee at such address unless otherwise indicated below.

IN WITNESS WHEREOF, Grantor has executed this deed this 15TH day of
December, 19 93.

Grantor: MARIE VAN SLYKE-BEAN (SEAL) Grantor: _____ (SEAL)
Signature: MARIE VAN SLYKE-BEAN Signature: _____
Printed: MARIE VAN SLYKE-BEAN Printed: _____

STATE OF INDIANA)
COUNTY OF LAKE) SS ACKNOWLEDGMENT

Before me, a Notary Public in and for said County and State, personally appeared: _____
MARIE VAN SLYKE-BEAN
who acknowledged the execution of the foregoing Warranty Deed, and who, having been duly
sworn, stated that any representations therein contained are true.

Witness my hand and Notarial Seal this: 15TH day of December, 19 93.

My commission expires: 4-15-95 Signature: JAMES R. BIELEFELD
Printed: JAMES R. BIELEFELD, Notary Public
Resident of Lake County, Indiana.

This instrument prepared by: JAMES R. BIELEFELD, Attorney at Law.

Return deed to: JAMES R. BIELEFELD, P.O. BOX 717, CROWN POINT
INDIANA 46307. PENNY M. HUDDLESTON, 910 Chase Drive,
Send tax bills to: Crown Point, Indiana 46307.

01123

700