

THIS FORM HAS BEEN PREPARED FOR USE IN THE STATE OF INDIANA BY LAWYERS ONLY. THE SELECTION OF A FORM OF INSTRUMENT, FILLING IN BLANK SPACES, STRIKING OUT PROVISIONS, AND INSERTION OF SPECIAL CLAUSES, MAY CONSTITUTE THE PRACTICE OF LAW WHICH SHOULD ONLY BE DONE BY A LAWYER.

Tax Key No. 4-82-3

Mall tax bills to:

# WARRANTY DEED

1609 TERRACE DRIVE  
SCHERERVILLE, INDIANA 46375  
This indenture witnesseth that

CARL E. BEIER AND MARGERY E. BEIER, husband and wife

93083474

of Lake County in the State of Indiana

Convey and warrant to

GREGORY A. JILLSON AND REVA JILLSON, husband and wife

of Lake County in the State of Indiana

for and in consideration of Ten (\$10.00) Dollars and other good and valuable consideration the receipt whereof is hereby acknowledged, the following Real Estate in Lake County in the State of Indiana, to wit:

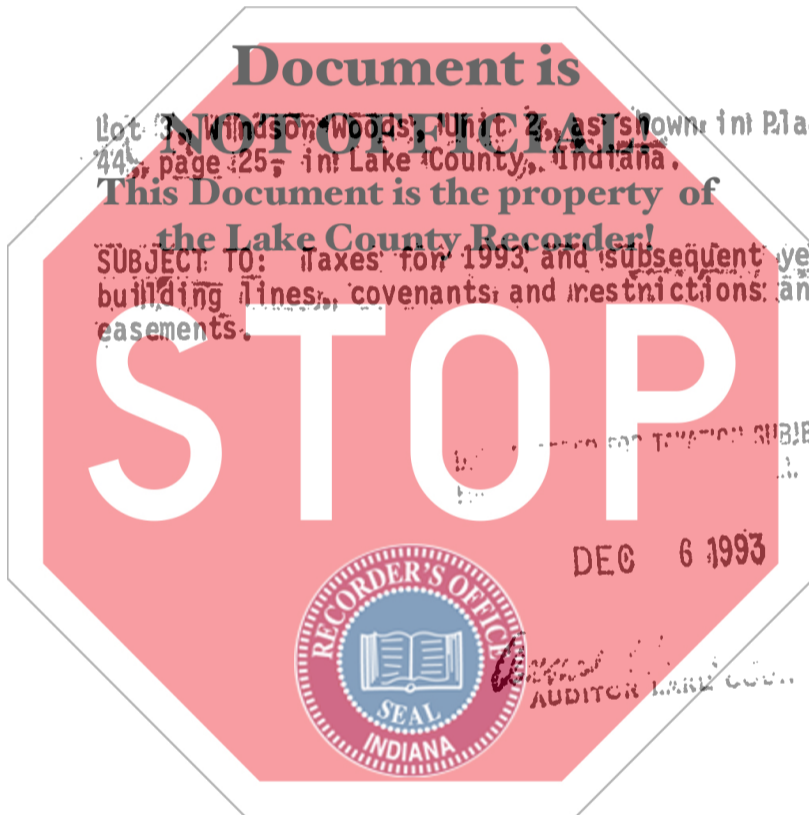

State of Indiana, Lake County, ss: Dated this 3rd Day of December 1993

Before me, the undersigned, a Notary Public in and for said County and State, this 3rd day of December 1993 personally appeared:

Carl E. Beier  
CARL E. BEIER

Margery E. Beier  
MARGERY E. BEIER

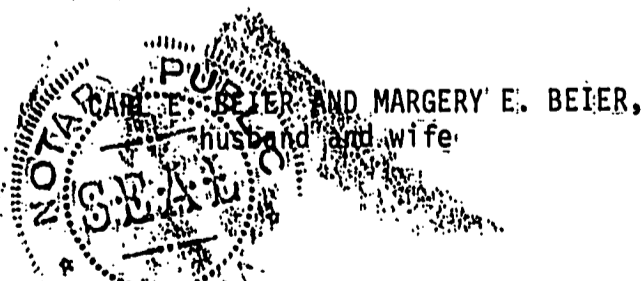

And acknowledged the execution of the foregoing deed. In witness whereof, I have hereunto subscribed my name and affixed my official seal. My commission expires March 5, 1995

Vincent Lunica  
VINCENT LUNICA Notary Public

Resident of LAKE County

This instrument prepared by RICHARD A. ZUNIGA, 162 WASHINGTON STREET, LOWELL, IN 46356 Attorney at Law

100 Washington Street  
Lowell, Indiana 46355  
Tel: 917 or 686-0100

LAKE COUNTY INDIANA  
FILED FOR RECORD