

9045 STATE RD 49 N
WHEATFIELD IN 46392

THIS FORM HAS BEEN PREPARED FOR USE WITHIN THE STATE OF INDIANA. THE SELECTION OF A FORM OF INSTRUMENT, FILLING IN BLANK SPACES, STRIKING OUT PROVISIONS, AND INSERTION OF SPECIAL CLAUSES, MAY CONSTITUTE THE PRACTICE OF LAW AND SHOULD ONLY BE DONE BY A LAWYER.

Mail tax bills to:
Josephine J. Beach
93082083

Tax Key No. _____

WARRANTY DEED

This indenture witnesseth that BETTY L. GOLDSMITH, an adult woman,

of Brown County in the State of Indiana

Convey and warrant to JOSEPHINE J. BEACH, an adult woman,

STATE OF INDIANA, S.S. NO. LAKE COUNTY FILED FOR RECORD
DEC 7 11 24 AM '93
SAR RECORDER
OFFICE

of Kendall County in the State of Illinois

for and in consideration of One Dollar (\$1.00) and other valuable consideration, the receipt whereof is hereby acknowledged, the following Real Estate in Lake County in the State of Indiana, to wit:

MY UNDIVIDED 1/4 INTEREST IN AND TO THE FOLLOWING DESCRIBED REAL ESTATE:

(Legal Description attached hereto and made a part hereof as Exhibit "A")

Subject to any utility easements, roads or rights of way, existing or of record, affecting said Lake County

Subject to a Contract For The Sale of Real Property between Wrel C. Emory and Irene L. Emory, as Sellers, and Verne L. Rosenthal and Joanne E. Rosenthal, as Buyers, dated April 16, 1970 and recorded July 3, 1979, as Instrument No. 537037, in the office of the Recorder of Lake County, Indiana, and the amendment thereof dated February 25, 1982 and recorded April 21, 1982, as Instrument No. 666242, in the office of the Recorder of Lake County, Indiana.

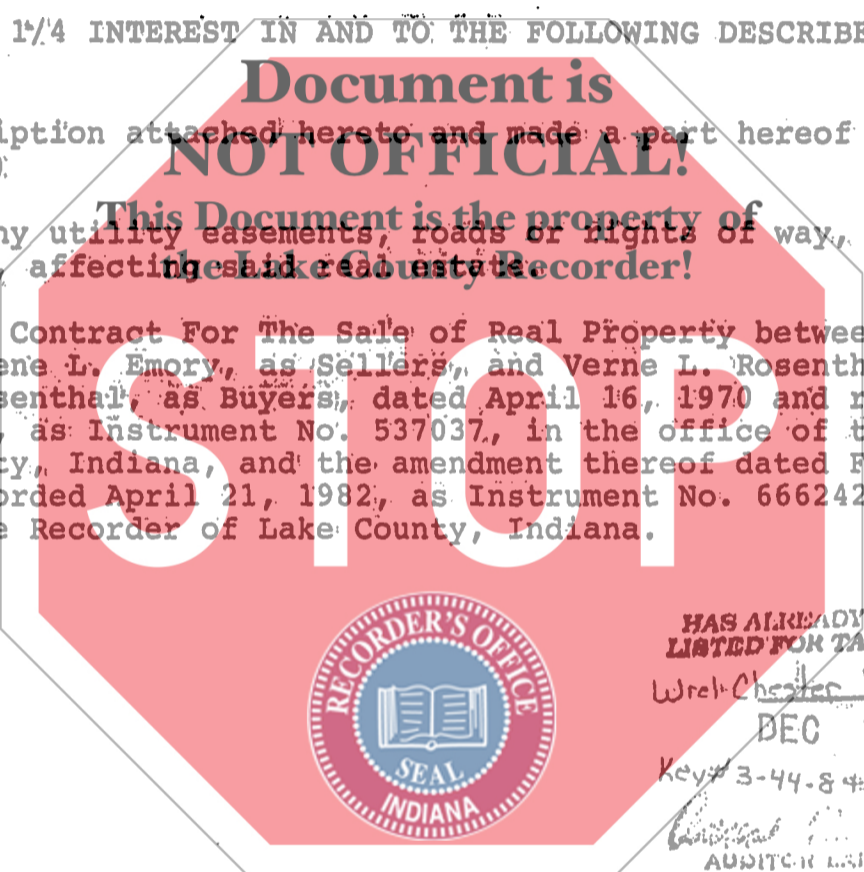

HAS ALREADY BEEN LISTED FOR TAXATION
Wrel Chester Emory
DEC 7 1993
Key# 3-44-8 + Key# 3-48-1
Auditor Lake County

State of Indiana, County, ss:
Before me, the undersigned, a Notary Public in and for said County and State, this _____ day of _____ 19 93
personally appeared:

BETTY L. GOLDSMITH, an adult woman,

Dated this 20 Day of Nov 1993

Betty L. Goldsmith
BETTY L. GOLDSMITH

And acknowledged the execution of the foregoing deed. In witness whereof, I have hereunto subscribed my name and affixed my official seal. My commission expires 7-14-1994

David White
Notary Public

Printed Name: _____
Resident of SASSEL County.

This instrument prepared by RAYMOND W. GRAY, Nashville, In. 47448 Attorney at Law J. P. D.

00537

EXHIBIT "A"

The South half of the East half of Section 5, Township 33 North, Range 8 West of the Second Principal Meridian, containing 156.95 acres, more or less, in Cedar Creek Township, Lake County, Indiana; excepting therefrom, however, a 10-acre tract out of the Northwest corner thereof, having frontage of approximately 330 feet on County Road 10, and 1320 feet North to South, previously sold to Daniel and Betty Lynch.

Also, the North half of the Northwest quarter of Section 9, Township 33 North, Range 8 West of the Second Principal Meridian, containing 80 acres, more or less; and part of the South half of the Southwest quarter of Section 4, Township 33 North, Range 8 West of the Second Principal Meridian, described as follows:
Beginning, at the Southwest corner of said Section;
thence East along the South line thereof to the West line of the road running North and South through the center of said Section;
thence North along the West line of said road 11.91 feet to a point on the centerline of a fence as now established;
thence Westerly along said centerline of said fence to a point on the West line of said Section;
thence South along the West line of said Section 39 feet, more or less, to the place of beginning, containing 1.55 acres, more or less, in Lake County, Indiana,
containing altogether 81.55 acres, more or less.

Kry#3-48-1

