

18171 Wring(h)

GM Tied Crown Point

# 9308194 SATISFACTION OF MORTGAGE

This Certifies, That a certain Mortgage executed by ..... Richard D. Wring .....

to Lake Mortgage Company, Inc.

on 10th day of February, 1993, calling for \$ 80,000.00 and recorded

in Mortgage Record No. .... page Doc 93010383 Lake County,

State of Indiana, has been fully paid and satisfied, and the same is hereby released.

WITNESSE our hand and seal this 26th day of October, 1993.

ATTEST: Susan M. Bristow By: Michael J. Howard  
Susan M. Bristow, Secretary Michael J. Howard, Treasurer

State of Indiana, Lake County, ss:

Before me, the undersigned, a Notary Public in and for said County, this 26th

day of October, 1993, personally appeared

Susan M. Bristow and Michael J. Howard, respectively

Secretary and Treasurer

acknowledged the execution of the annexed satisfaction of mortgage.

Witness my hand and official seal.

Donna S. Rust Notary Public.  
Donna S. Rust

My Commission expires 11-18-96

County of Residence: Lake

This instrument was prepared by: Deana M. Darnstaedt, Lake Mortgage Co

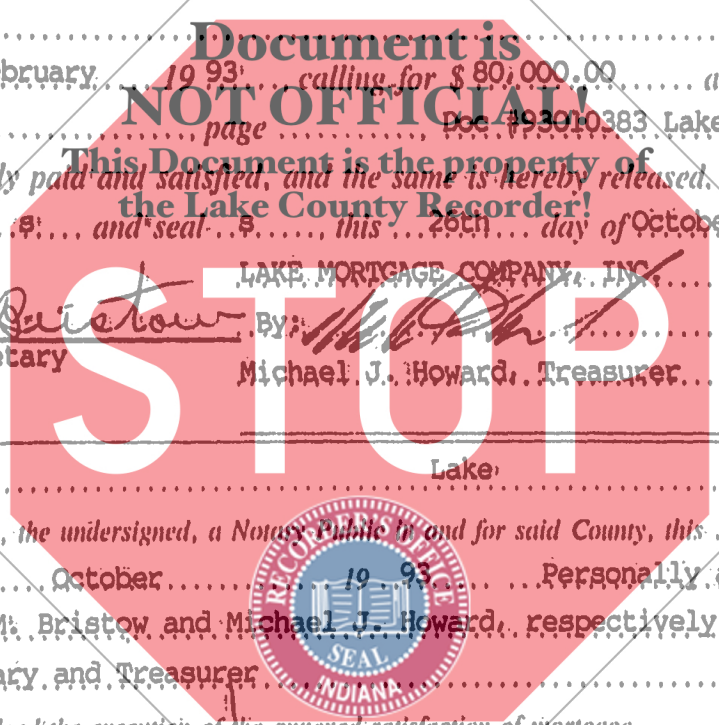

PART OF TRACT 13 IN PHASE TWO OF PEBBLE BROOKS, A PLANNED UNIT DEVELOPMENT IN CROWN POINT, AS PER PLAN THEREOF, RECORDED IN PLAT BOOK 72 PAGE 36, IN THE OFFICE OF THE RECORDER OF LAKE COUNTY, INDIANA, DESCRIBED AS FOLLOWS: COMMENCING AT THE NORTHWEST CORNER OF SAID TRACT; THENCE SOUTH 67 DEGREES 00 MINUTES 06 SECONDS WEST ALONG THE NORTH LINE OF SAID TRACT; 70.45 FEET TO THE TRUE POINT OF BEGINNING; THENCE CONTINUING SOUTH 67 DEGREES 00 MINUTES 06 SECONDS EAST, ALONG THE NORTH LINE OF SAID TRACT; 28.08 FEET; THENCE SOUTH 22 DEGREES 59 MINUTES 54 SECONDS WEST, PARALLEL WITH THE WEST LINE OF SAID TRACT, 98.90 FEET TO A POINT ON THE CURVED SOUTHERLY LINE OF SAID TRACT; THENCE WESTERLY, ALONG THE CURVED SOUTHERLY LINE OF SAID TRACT, ON A CURVE CONCAVE TO THE NORTH AND HAVING A RADIUS OF 180.0 FEET, AN ARC DISTANCE OF 19.95 FEET TO A POINT OF TANGENT IN SAID SOUTHERLY LINE; THENCE NORTH 67 DEGREES 00 MINUTES 06 SECONDS WEST, ALONG SAID SOUTHERLY LINE 8.19 FEET; THENCE NORTH 22 DEGREES 59 MINUTES 54 SECONDS EAST, PARALLEL WITH THE WEST LINE OF SAID TRACT, 100.00 FEET TO THE POINT OF BEGINNING. THE WEST LINE OF SAID TRACT, 100.00 FEET TO THE POINT OF BEGINNING.

702

EC 11/19/93  
HCH  
STATE OF INDIANA  
NOTARY PUBLIC  
DECEMBER 1993

