

4115 4651812D  
Bowman, Hunt, Boccia & McPhee  
1000 E 80th Ave, Suite 500 N  
Merrillville, IN 46410

93081726

DISCLOSURE FORM EXEMPT DUE TO FORECLOSURE

This Indenture, Made this 5TH day of NOVEMBER A. D. 19 93

between STEPHEN R. STIGLICH Sheriff of Lake County, in the State of Indiana, of the first part and MIDLAND MORTGAGE CORPORATION, AS ASSIGNEE OF MAGNA MORTGAGE CO., f/k/a THE MILLIKIN MORTGAGE CO., AS ASSIGNEE OF DONALD WEBBER MORTGAGE CO., INC.

of the County of Lake and State of Indiana of the second part. WITNESSETH:

THAT WHEREAS, At the CONTINUOUS Term of the Lake SUPERIOR COURT A.D. 19 93 MIDLAND MORTGAGE CORPORATION, AS ASSIGNEE OF MAGNA MORTGAGE CO, f/k/a THE MILLIKIN MORTGAGE CO., AS ASSIGNEE OF DONALD WEBBER MORTGAGE CO., INC.

recovered by judgment of said Court, in a certain action therein against ROSALBA CARBAJAL, SILBERIO SALAS, JOHN AND MARY DOE WHOSE TRUE CHRISTIAN NAMES ARE UNKNOWN

the sum of FORTY ONE THOUSAND THREE HUNDRED AND FIFTY EIGHT Dollars and NINETY Cents, for ITS damages; together with the further sum of THIRTEEN Dollars and NO Cents, for ITS costs in that behalf expended; and a decree for the sale of all the interest, estate, right and title of the defendant ROSALBA CARBAJAL, SILBERIO SALAS, ET AL.,

In and to certain Real Estate, described therein as follows, to wit: THE WESTERLY 12-1/2 FEET OF LOT 5 AND THE EASTERLY 25 FEET OF LOT 6, BLOCK 3, REDIVISION OF HELBERG'S OAK RIDGE ADDITION TO HAMMOND, AS SHOWN IN PLAT BOOK 3, PAGE 23, IN LAKE COUNTY, INDIANA. COMMONLY KNOWN AS: 1146 SIBLEY ST, HAMMOND, IN 46320

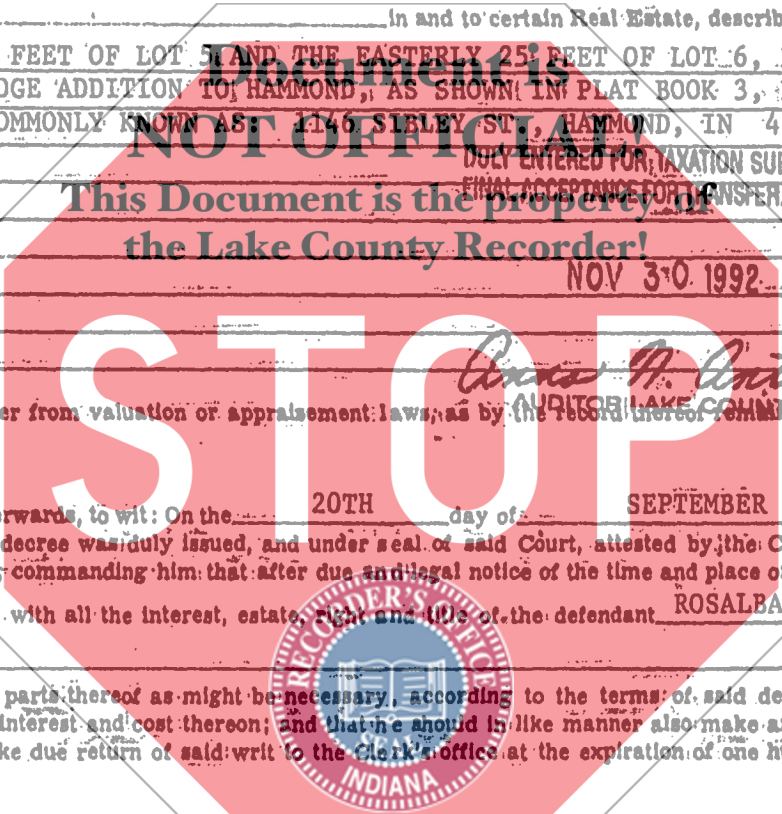

STATE OF INDIANA  
FILED IN  
NOV 30 1992  
2 1 PM '93  
S. STIGLICH

All without any relief whatever from valuation or appraisal laws, as by the record thereof appears.

AND WHEREAS, Afterwards, to wit: On the 20TH day of SEPTEMBER a copy of said judgment and decree was duly issued, and under seal of said Court, attested by the Clerk thereof, directed to the Sheriff of the County of Lake, commanding him that after due and legal notice of the time and place of making the same, he should sell the land above described, with all the interest, estate, right and title of the defendant ROSALBA CARBAJAL, SILBERIO SALAS, ET AL.,

therein, or so much and such parts thereof as might be necessary, according to the terms of said decree, to pay and satisfy the judgment aforesaid, with the interest and cost thereon; and that he should in like manner also make and return all interest and accruing costs thereon, and make due return of said writ to the Clerk's office at the expiration of one hundred and eighty days from the date of the same.

AND WHEREAS Said copy of judgment and order of sale, on the 21ST day of SEPTEMBER A.D. 19 93, came to the hands of STEPHEN R. STIGLICH then the Sheriff of said County, to be executed, and the said

STEPHEN R. STIGLICH as said Sheriff as aforesaid, having legally advertised the same, did on the 5TH day of NOVEMBER A.D. 19 93, at the Court House door in Crown Point in the County aforesaid, between the hours prescribed by law, at public auction, expose to sale the rents, profits, issues and income, of said estate of ROSALBA CARBAJAL, SILBERIO SALAS, ET AL.,

together with all the rights, title and interest in fee simple of the said ROSALBA CARBAJAL, SILBERIO SALAS, ET AL., in and to said estate, and the said MIDLAND MORTGAGE CORPORATION, AS ASSIGNEE OF MAGNA MORTGAGE CO., f/k/a THE MILLIKIN MORTGAGE CO., AS ASSIGNEE OF DONALD WEBBER MORTGAGE CO., INC.

did then and there bid the sum of FORTY ONE THOUSAND THREE HUNDRED AND SEVENTY ONE Dollars and NINETY Cents, and no person bidding more, the same was in due form openly struck off and sold to the said MIDLAND MORTGAGE CORPORATION AS ASSIGNEE OF MAGNA MORTGAGE CO., f/k/a THE MILLIKIN MORTGAGE CO., AS ASSIGNEE OF DONALD WEBBER MORTGAGE CO., INC. for the said sum of FORTY ONE THOUSAND THREE HUNDRED AND SEVENTY ONE Dollars and NINETY Cents ITS being

the highest bidder, and that being the highest price bid for the same

01892  
9.00

Chicago Title Insurance Company

NOW THEREFORE, to confirm to said MIDLAND MORTGAGE CORPORATION, AS ASSIGNEE OF MAGNA MORTGAGE CO., f/k/a THE MILLIKIN MORTGAGE CO., AS ASSIGNEE OF DONALD WEBBER MORTGAGE CO., INC.

the sale so made as aforesaid, the said STEPHEN R. STIGLICH as Sheriff as aforesaid, in consideration of said sum of FORTY ONE THOUSAND THREE HUNDRED AND SEVENTY ONE Dollars and NINETY Cents, to him in hand paid by said MIDLAND MORTGAGE CORPORATION, AS ASSIGNEE OF MAGNA MORTGAGE CO., f/k/a THE MILLIKIN MORTGAGE CO., AS ASSIGNEE OF DONALD WEBBER MORTGAGE CO., INC. the receipt whereof is hereby acknowledged, as

provided by law hath GRANTED, BARGAINED AND SOLD, and doth by these presents GRANT, BARGAIN, SELL, CONVEY AND CONFIRM to the said THE MILLIKIN MORTGAGE CO., AS ASSIGNEE OF theirs and assigns FOREVER, all the following Real Estate situate in the County of Lake and State of Indiana, to wit: THE WESTERLY 12-1/2 FEET OF LOT 5 AND THE EASTERLY 25 FEET OF LOT 6, BLOCK 3, REDIVISION OF HELBERG'S OAK RIDGE ADDITION TO HAMMOND, AS SHOWN IN PLAT BOOK 3, PAGE 23, IN LAKE COUNTY, INDIANA. COMMONLY KNOWN AS: 1146 SIBLEY ST., HAMMOND, IN 46320



MIDLAND MORTGAGE CORPORATION, AS ASSIGNEE OF MAGNA MORTGAGE CO., f/k/a THE MILLIKIN MORTGAGE CO., AS ASSIGNEE OF DONALD WEBBER MORTGAGE CO., INC. heirs and assigns, forever, in as full and ample a manner as the same was held by ROSALBA CARBAJAL, SILBERIO SALAS, ET AL., immediately before the execution of the mortgage mentioned in said decree, foreclosing the same.

IN WITNESS WHEREOF, The said STEPHEN R. STIGLICH as Sheriff as aforesaid, has hereunto set his hand and seal, the day and year above written. (Seal) Sheriff, Lake County, Indiana.

State of Indiana, Lake County, ss: BEFORE ME, DONNA M. GILLAM, in and for said County, personally came STEPHEN R. STIGLICH, Sheriff of said County, and acknowledged the foregoing conveyance to be his voluntary act and deed as such sheriff.

MY COMM: EXPIRES JANUARY 30, 1995 IN WITNESS WHEREOF, I hereunto subscribe my name, and affix my official seal of office, this 5TH day of NOVEMBER A.D. 1993. Donna M. Gillam DONNA M. GILLAM - LAKE COUNTY

THIS INSTRUMENT PREPARED BY NATALIE TIGA

STEPHEN R. STIGLICH Sheriff of Lake County

TO MIDLAND MORTGAGE CORPORATION 1031 W. MORSE BLVD, STE. 350 WINTER PARK, FL 32789

DEED ON DECREE

Received for Record

This \_\_\_ day of \_\_\_ at \_\_\_ o'clock \_\_\_ M.

and recorded in Record page \_\_\_

Recorder for Lake County

Duly Entered for Taxation

19 Auditor