

Route 2 Box 170
Watseka IL
60970

93080547

WHEREAS, CAROL HASSELBRING

the 29TH day of NOVEMBER 19 93, produce to the undersigned;

ANNA N. ANTON Auditor of the County of Lake, in the State of Indiana, ONE (1)

certificate of purchase, in writing, bearing date the 5TH day of OCTOBER 1992, signed by

ANNA N. ANTON, who at the last mentioned date was the Auditor of said County, from which cer-

tificate it appears that CAROL HASSELBRING did,

on the 5TH day of OCTOBER 1992, purchase at public auction at the door of the Court-

House in said County, the tract, parcel or lot of land lastly in this indenture described, and which lot was

sold to CAROL HASSELBRING for the sum of

SEVEN HUNDRED THIRTY EIGHT Dollars and 25/100 Cents,

being the amount due on the following tracts or lots of land returned delinquent in the name of

JOHN E., STAMPER

1989 PAY 1990 & PREVIOUS; 1990 PAY 1991; 1991 PAY 1992

for the non-payment of taxes, costs and charges for the years 19 and 19, namely:

CLASS IN: N: 120 FT. OF THE S310FT. OF W: 79.32 FT. OF THE E. 739.32 FT.
KEY # 01-39-24-1-18 BY G.S. & ADJ. TO THE S. R/W OF THE E.J. & ERR. IN THE SW SW
S: 31 T. 36 R. 8. 218AC. SUBJ. TO EASEMENT \$738.25

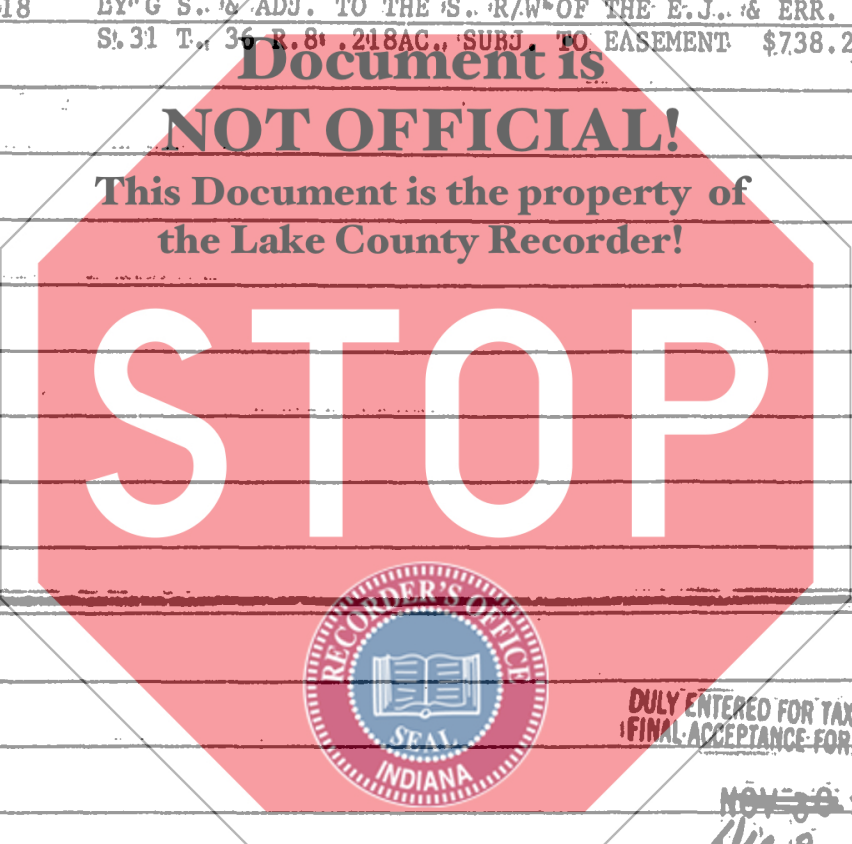

STATE OF INDIANA
FILED FOR RECORD
DEC 2 18 54 AM '93
SARAH J. COLLIER
RECORDER



DULY ENTERED FOR TAXATION SUBJECT TO FINAL ACCEPTANCE FOR TRANSFER

NOV 30 1993

Anna N. Anton
AUDITOR LAKE COUNTY

which said lands have been recorded among other tracts in the office of said Auditor, as delinquent for the non-payment of taxes, costs and charges due for the last year aforesaid and a true copy of said record transmitted to the office of the Auditor of State, in manner and form as prescribed by law, and legal publication made of the sale of said lands, and it appearing that the said CAROL HASSELBRING CERTIFICATE # 104 is the legal owner of said certificate of purchase.

00087

110

and the time fixed by law for redeeming the land therein described having now expired, the said _____

JOHN E. STAMPER

nor any person in HIS

behalf having paid or tendered the amount due the said CAROL HASSELBRING

on account of the aforesaid purchase, and for the taxes

by HER since paid; and the said CAROL HASSELBRING

having demanded a deed for the tract of land mentioned said certificate, and which was the least quantity of the tract above described that would sell for the amount due thereon for taxes, costs and charges above specified; and it appearing from the records of said County Auditor's Office, that the aforesaid lands were legally liable for taxation, and have been duly assessed and properly charged on the Duplicate with the taxes for the years 89 PAY 90 & PREVIOUS; 90 PAY 91; 91 PAY 92 19____ and 19____

THEREFORE, this Indenture, Made this 2ND day of DECEMBER 1993

between THE STATE OF INDIANA, ANNA N. ANTON, Auditor of said County, of the first part, and the said CAROL HASSELBRING

of the second part, WITNESSETH, That the said party of the first part, for and in consideration of the premises, has granted, bargained and sold unto the said party of the second part, HER heirs and assigns forever the tract or parcel of land mentioned in said certificate, situate in the County of Lake and State of Indiana, and described as follows:

KEY# 01=39=24=118 N. 120 FT. OF THE S 310 FT OF W. 79.32 FT. OF THE E. 739.32 FT. LY'G S: & ADJ. TO THE S. R/W OF THE E.J. & ERR. IN THE SW SW S31 T36 R8 .218 AC. SUBJ TO EASEMENT

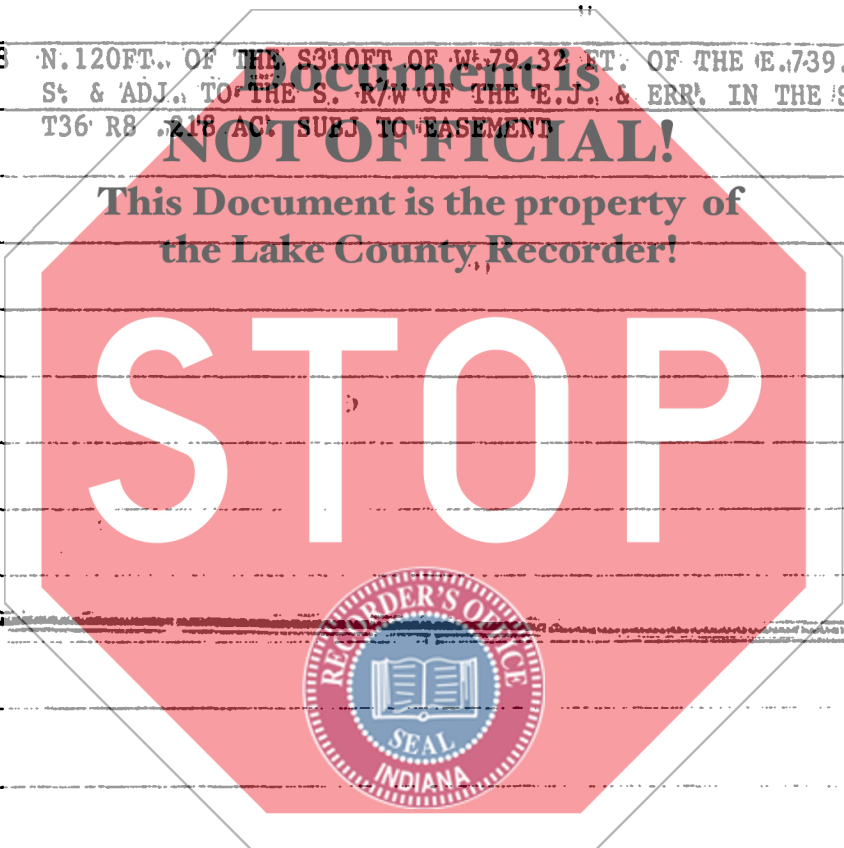

TO HAVE AND TO HOLD the said last mentioned tract or parcel of land, with the appurtenances thereto belonging, to the said party of the second part, HER heirs and assigns forever, in as full and ample a manner as the said Auditor of said County is empowered by law to sell the same.

In Testimony Whereof: The said ANNA N. ANTON Auditor of the said County of Lake, has hereunto set his hand and affixed the seal of the Board of County Commissioners, the day and year last above written.

Anna N. Anton
Auditor Lake County, Indiana
ANNA N. ANTON

Attest: Mary Kay Katma Choy Hays
Treasurer Lake County
IRENE HOLINGA
Irene Holinga
Treasurer



STATE OF INDIANA }
COUNTY OF LAKE } ss:



Before me, the undersigned, ROBERT C. ANTICH, in and for said county, this day, personally came the above named ANNA N. ANTON Auditor of said county, and acknowledged that he signed and sealed the foregoing deed for the uses and purposes therein mentioned.

In witness whereof, I have hereunto set my hand and seal this 2ND day of DECEMBER, 1993

Robert C. Antich
by Paula B. Wood Clerk, Lake Circuit Court
Lake County, Indiana
Exec. Dep. ROBERT C. ANTICH