

MAIL TAX BILLS TO: 93056487

Violet Buncich
6907 Madison Street
Merrillville, IN 46410

QUITCLAIM DEED

THIS INDENTURE WITNESSETH, that MARY ROSE SEBER
("Grantor") of Lake County in the State of INDIANA QUITCLAIM(S) to VIOLET BUNCICH,
6907 Madison Street, Merrillville, Indiana 46410
of Lake County in the State of Indiana
in consideration of ~~ROVE AND AFFECTION~~ and in consideration, the receipt and sufficiency of which are hereby acknowledged, the following described real estate in Lake County, in the State of Indiana:

STATE OF INDIANA / S.S. NO. LAKE COUNTY FILED FOR RECORD AUG 30 10 30 AM '93

PARCEL ONE: One acre out of the following described real estate: Part of the West Half of Lot One of 40 acre lots, described as commencing at a point 7 rods 12 1/2 feet South of the Northwest corner of said Lot One, and running thence East 42 rods, thence South to a point 76 rods South of the North line of said Lot, thence West 42 rods to the West line of said lot, thence North to the place of beginning, containing 17.95 acres, more or less, in Section 16, Township 35 North, Range 8 West of the Second Principal Meridian; said One tract herein conveyed being described as commencing 58.05 feet South of the Northwest corner of said above described 17.95 acre tract, thence East 693 feet to the East line of said above tract, thence South 62.85 feet, thence West 693 feet to the West line of said tract, thence North to the place of beginning, containing one acre;

PARCEL TWO: The North .92 acre of the following described real estate: A part of the West Half of Lot One (1) of 40 acre lots, described as commencing at a point 7 rods 12 1/2 feet South of the Northwest corner of said Lot One (1), and running thence East 42 rods, thence South to a point 76 rods South of the North line of said lot; thence West 42 rods to the West line of said lot, thence North to the place of beginning, containing 17.95 acres, more or less, in Section 16, Township 35 North, Range 8 West of the Second Principal Meridian, the tract herein conveyed being described as commencing at the Northwest corner of said hereinabove described 17.95 acre tract, and running thence East 693 feet to a point, thence South 58.05 feet to a point, thence West 693 feet to a point, thence North 58.05 feet to the place of beginning, containing .92 acre;

commonly known as 6907 Madison Street, Merrillville, Indiana 46410

KEY: 15-111-25440

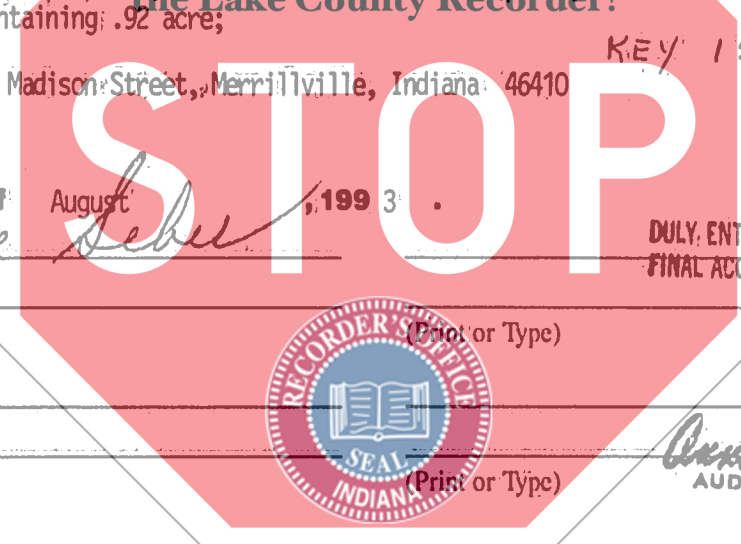

Dated this 19th day of August, 1993.
Mary Rose Seber
MARY ROSE SEBER
(Print or Type)

DULY ENTERED FOR TAXATION SUBJECT TO FINAL ACCEPTANCE FOR TRANSFER.

AUG 27 1993

Dana H. Antea
AUDITOR LAKE COUNTY
(Print or Type)

STATE OF INDIANA
COUNTY OF Lake SS:

Before me, the undersigned, a Notary Public in and for said County and State, this 19th day of August 1993, personally appeared: MARY ROSE SEBER and acknowledged the execution of the foregoing deed. In witness whereof, I have hereunto subscribed my name and affixed my official seal.

My commission expires: August 27, 1994
Resident of LAKE County
Signature *Bernice J. Olszowski*
Printed Bernice J. Olszowski, Notary Public

STATE OF
COUNTY OF SS:

Before me, the undersigned, a Notary Public in and for said County and State, this ___ day of 199_, personally appeared: and acknowledged the execution of the foregoing deed. In witness whereof, I have hereunto subscribed my name and affixed my official seal.

My commission expires: _____ Signature _____
Resident of _____ County Printed _____, Notary Public

This instrument prepared by Charles E. Daugherty 6 East 67th Ave. Attorney at Law
Merrillville, Indiana 46410
Attorney Identification No. 4701-45

MAIL TO: Charles E. Daugherty
6 East 67th Avenue
Merrillville, IN 46410

01692 700