

Mail tax bills to:
6520 Kansas Avenue
Hammond, IN. 46323

HO 468278 1-0
Tax Key No. 32-4-13 and 14

WARRANTY DEED

93054400

Chicago Title Insurance Company

This indenture witnesseth that THEODORE SURMA and JACQUALYN U. SURMA, Husband and Wife

of Lake County in the State of Indiana

Convey and warrant to ROBERT M. HASKELL and ROBERTA L. HASKELL, Husband and Wife

of Lake County in the State of Indiana

for and in consideration of Ten Dollars (\$10.00) and other valuable consideration the receipt whereof is hereby acknowledged, the following Real Estate in Lake County, in the State of Indiana, to-wit:

Lots 13, 14 and the North 5 feet of Lot 15, Block 2,
the Baldwin Addition to Gary, in the City of Hammond,
as shown in Plat Book 10, page 35, in Lake County, Indiana.

Document is NOT OFFICIAL!

This Document is the property of the Lake County Recorder!

DULY ENTERED FOR TAXATION SUBJECT TO FINAL ACCEPTANCE FOR TRANSFER.

AUG 18 1993

Commonly known as: 6520 Kansas Street, Hammond, IN 46323

Anna M. Anton
AUDITOR LAKE COUNTY

Subject to all terms, conditions, easements, limitations and restrictions of record.

Subject to all past and future real estate taxes.

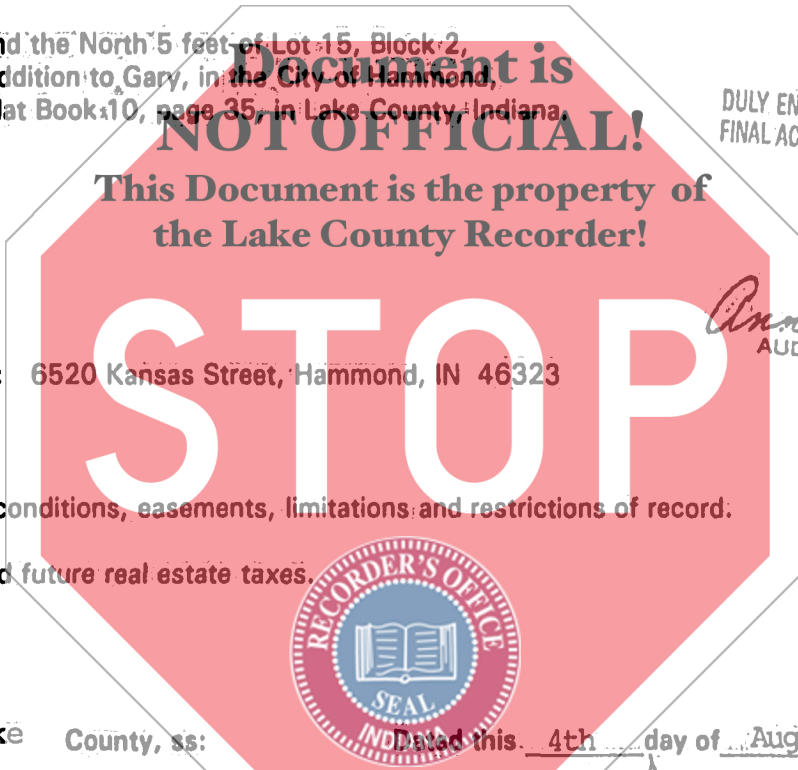

State of Indiana, Lake County, ss: Dated this 4th day of August, 1993

Before me, the undersigned, a Notary Public in and for said County and State this 4th day of August 19 93 personally appeared:

Theodore Surma (Seal)
THEODORE SURMA

Jacquelyn U. Surma (Seal)
JACQUALYN U. SURMA

THEODORE SURMA and JACQUALYN U. SURMA,
Husband and Wife



And acknowledged the execution of the foregoing deed. In witness whereof, I have hereunto subscribed my name and affixed my official seal. My commission expires: 12-17-1993

Roberta S. Tate
Notary Public Roberta S. Tate

Resident of Porter County

This instrument prepared by: JOHN M. SEDIA, #237-45, 2633-45th St. Highland, IN 46322 Attorney at Law
219/924-0770

Mail to:

00495

900