

THAT PART OF THE WEST HALF OF THE SOUTHWEST QUARTER OF SECTION 21, TOWNSHIP 36 NORTH
RANGE 9 WEST OF THE SECOND PRINCIPAL MERIDIAN, DESCRIBED AS FOLLOWS: BEGINNING AT A
POINT ON THE CENTER LINE OF RIDGE ROAD 302.5 FEET SOUTHEASTERLY OF THE WEST LINE OF
SAID SECTION; THENCE SOUTHEASTERLY ALONG THE CENTER LINE OF RIDGE ROAD 100.84 FEET;
SOUTH PARALLEL WITH THE WEST LINE OF SAID SECTION 240 FEET; THENCE WEST PARALLEL

467355 9ml
5064 BANK OF HIGHLAND/202937/SM/NW

SATISFACTION OF MORTGAGE

93051210

This Certifies, That a certain Mortgage executed by PAUL J. MEDEMA AND

MICHELE M. MEDEMA, HUSBAND AND WIFE.....

to BANK OF HIGHLAND

2611 HIGHWAY AVENUE, HIGHLAND, IN 46322

on 8TH day of JANUARY 19 93 calling for \$ 50,000.00

in Mortgage Record No. 93000707. This Document is the property of FAKE

State of Indiana, has been fully paid and satisfied, and the same is hereby released.

WITNESS MY hand and seal, this 16TH day of JULY 19 93

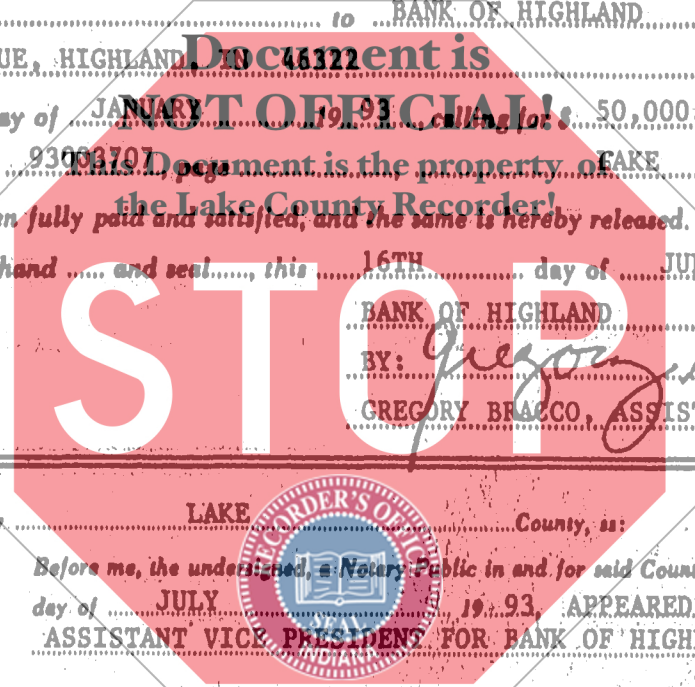

SAMUEL DONLIGH
RECORDER
Aug 5 1 24 PM '93
FILED FOR REC'D
LAKE COUNTY

State of Indiana

LAKE County, as:

Before me, the undersigned, a Notary Public in and for said County, this 16TH
day of JULY 19 93, APPEARED GREGORY BRACCO,
ASSISTANT VICE PRESIDENT FOR BANK OF HIGHLAND AND

acknowledged the execution of the annexed satisfaction of mortgage.

Witness my Hand and official seal.

Cynthia Ondas
CYNTHIA ONDAS

Notary Public.

COUNTY OF RESIDENCE: LAKE

My Commission expires 4/15/94

This instrument prepared by: GREGORY BRACCO, ASSISTANT VICE PRESIDENT.

Chicago Title Insurance Company

100
of

100.84 FEET, THENCE NORTH PARALLEL WITH THE WEST LINE OF SAID SECTION 240 FEET TO
THE PLACE OF BEGINNING, IN LAKE COUNTY, INDIANA.