

THIS FORM HAS BEEN PREPARED FOR USE WITHIN THE STATE OF INDIANA. THE SELECTION OF A FORM OF INSTRUMENT, FILLING IN BLANK SPACES, STRIKING OUT PROVISIONS, AND INSERTION OF SPECIAL CLAUSES, MAY CONSTITUTE THE PRACTICE OF LAW AND SHOULD ONLY BE DONE BY A LAWYER.

MAIL TAX BILLS TO: 93049232

TAX KEY NO: 15-326-2

5824 GRANT PLACE
MERRILLVILLE, IN 46410

QUIT-CLAIM DEED

This indenture witnesseth that CHARLES V. SULLIVAN AND EARNESTINE M. SULLIVAN;
HUSBAND AND WIFE

of LAKE County in the State of INDIANA

Releases and quit claims to: CHARLES V. SULLIVAN

of LAKE County in the State of INDIANA
for and in consideration of TEN DOLLARS (\$10.00) AND OTHER GOOD AND VALUABLE CONSIDERATION
the receipt whereof is hereby acknowledged, the following Real Estate in LAKE County
in the State of Indiana, to wit:

LOT 2 IN BLOCK 6 IN COUNTRY CLUB SECOND ADDITION - SEC. "E", AS PER PLAT THEREOF, RECORDED IN PLAT BOOK 331 PAGE 9, IN THE OFFICE OF THE RECORDER OF LAKE COUNTY, INDIANA; COMMONLY KNOWN AS 5824 GRANT PLACE, MERRILLVILLE, IN 46410.

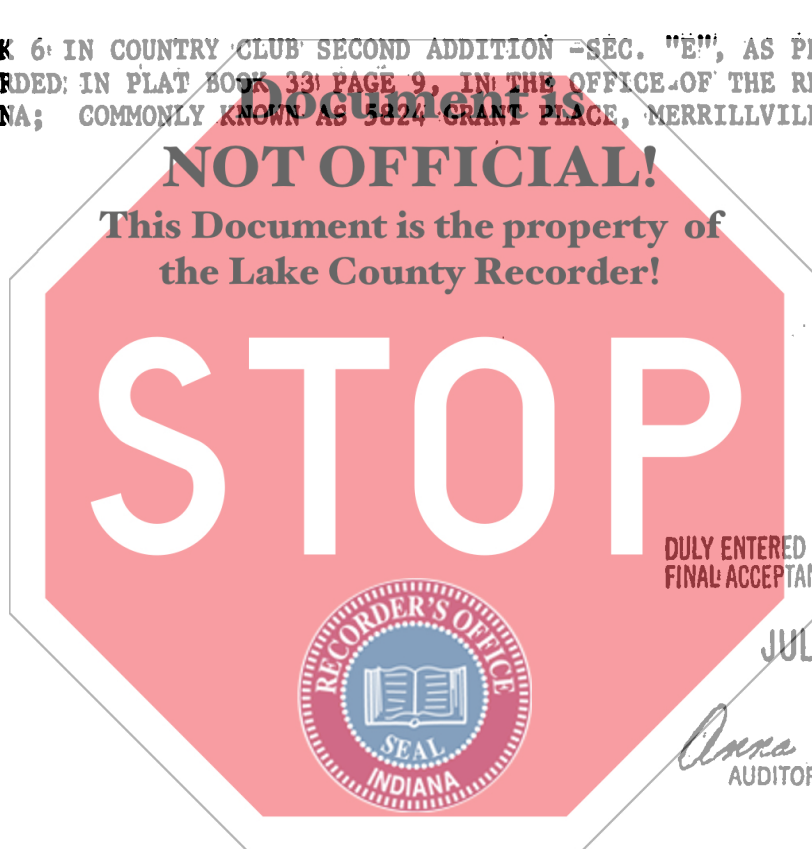

SAMUEL J. JACOBS
RECORDER

JUL 29 10 10 AM '93

FILED FOR RECORD

STATE OF INDIANA S. NO.

DULY ENTERED FOR TAXATION SUBJECT TO FINAL ACCEPTANCE FOR TRANSFER

JUL 27 1993

Anna M. Anton
AUDITOR LAKE COUNTY

State of Indiana, LAKE County, ss:
Before me, the undersigned, a Notary Public in and for said County and State, this 12TH day of JULY 19 03 personally appeared:

CHARLES V. SULLIVAN AND EARNESTINE M. SULLIVAN,
HUSBAND AND WIFE

Dated this 12TH Day of JULY 19 93

Charles V. Sullivan

CHARLES V. SULLIVAN

Earneistine M. Sullivan

EARNESTINE M. SULLIVAN

And acknowledged the execution of the foregoing deed. In witness whereof, I have hereunto subscribed my name and affixed my official seal. My commission expires 10-2-93 19

Paula Barrett
PAULA BARRETT
Notary Public

Resident of LAKE County

This instrument prepared by MARK S. LUCAS, LUCAS, HOLCOMB & MEDREA, EASTON, Attorney at Law
COURT, 300 E. 90TH DRIVE, MERRILLVILLE, INDIANA 46410

MAIL TO:

00640 700
7-16-93