

THIS FORM HAS BEEN APPROVED BY THE INDIANA STATE BAR ASSOCIATION FOR USE BY LAWYERS ONLY. THE SELECTION OF A FORM OF INSTRUMENT, FILLING IN BLANK SPACES, STRIKING OUT PROVISIONS AND INSERTION OF SPECIAL CLAUSES, CONSTITUTES THE PRACTICE OF LAW AND MAY ONLY BE DONE BY A LAWYER:

Tax #46-421-7,8,9,11 & 47

Mail tax bills to:

2424 Marshall St.

Gary, IN:

93048201

# WARRANTY DEED

COMMUNITY TITLE COMPANY

FILE NO. X 6341

This indenture witnesseth that CITY OF GARY, DEPARTMENT OF REDEVELOPMENT

of Lake County in the State of Indiana

Convey and warrant to MOSE C. CRENSHAW and MARY A. CRENSHAW, Husband and Wife as Tenants by the Entireties  
4139 Monroe Street  
Gary, IN 46408

of Lake County in the State of Indiana

for and in consideration of Two Thousand (\$2,000.00) Dollars and other valuable consideration the receipt whereof is hereby acknowledged, the following Real Estate in Lake County in the State of Indiana, to wit:

Lots 7, 8, 9, 10, 11, and 12, Block 5, Ridgemoor Real Estate Co.'s 2nd Addition in Gary, Lake County, Indiana. Key No. 46-421-7, 8, 9, 11 and 47

Subject to taxes for 1993 payable in 1994, and thereafter.

Subject to easements, assessments, restrictions and rights of way of record.

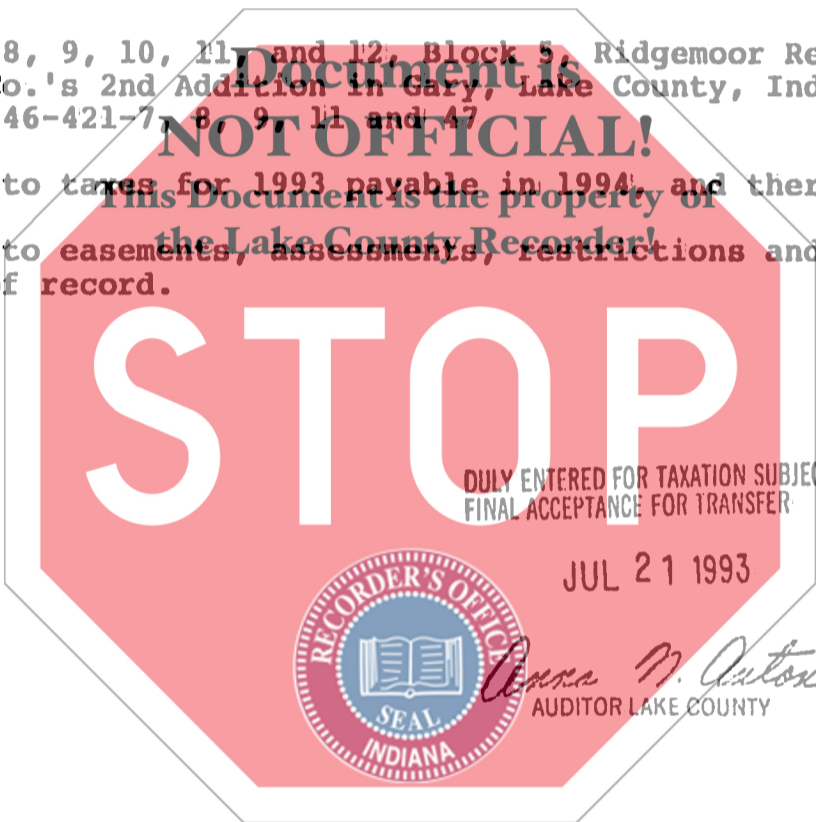

STATE OF INDIANA  
LAKE COUNTY  
RECORDED  
JUL 26 1 02 PM '93

State of Indiana, Lake County, ss:  
Before me, the undersigned, a Notary Public in and for said County and State, this 12th day of July 19 93 personally appeared:

Troy Montgomery, as its Vice President  
and Emma D. Robinson, as its Secretary

Dated this 12th Day of July 1993  
CITY OF GARY, DEPARTMENT OF REDEVELOPMENT  
BY: Troy Montgomery Seal  
TROY MONTGOMERY, Vice President  
BY: Emma D. Robinson Seal  
EMMA D. ROBINSON, Secretary

And acknowledged the execution of the foregoing deed. In witness whereof, I have hereunto subscribed my name and affixed my official seal. My commission expires May 14 19 97

Luci L. Horton  
Luci L. Horton Notary Public

Resident of Lake County.

This instrument prepared by Julian B. Allen  
437 Connecticut St., Gary, IN 46402  
(219) 886-2888

Parcel No. 62-6A & B

00503 700 CM

MAIL TO: