

93045393

3

ASSIGNMENT OF RIGHT-OF-WAY EASEMENTS

KNOW ALL MEN BY THESE PRESENTS that ARCO Pipe Line Company, a Delaware corporation with offices at 15600 John F. Kennedy Boulevard, Suite 300, Houston, Texas 77032 ("APL"), in consideration of the sum of One and No/100 Dollars (\$1.00) and other good and valuable consideration to it in hand paid by NORCO Pipeline, Inc., an Arkansas corporation, whose mailing address is 280 North College, Suite 500, P. O. Box 1503, Fayetteville, Arkansas 72702 ("Assignee"), the receipt of which is hereby acknowledged, does hereby grant, sell, assign, convey, and set over to Assignee, its successors and assigns, all of the rights, title, interest and estate of APL in, to and under the right-of-way easements covering land located in Lake County, Indiana, a schedule of which is marked Exhibit "A," attached hereto and made a part hereof (the "Easements").

TO HAVE AND TO HOLD the same unto Assignee, its successors and assigns, forever; it being understood that this assignment is subject to the respective terms and conditions of each Easement hereby assigned.

APL represents that it is the owner of the Easements but with respect to the Easements makes no further warranties, either expressly or impliedly, except as set forth in the Sale and Purchase Agreement between APL and Continental Ozark, Inc. dated September 2, 1992.

Assignee hereby accepts this Assignment of Right of Way Easements and agrees to keep and perform all the conditions and covenants in each Easement required to be kept and performed by APL from and after the effective date of this Assignment.

This Assignment has been executed on the date or dates of the acknowledgments hereto but shall be effective for all purposes as of November 2, 1992.

Attest:

ARCO Pipe Line Company

Lavern W. Strecker
Lavern W. Strecker
Assistant Secretary



Norman R. Bennett
By *Norman R. Bennett*
Norman R. Bennett
Vice President

Approved as to Form
JAC
Legal Department

-APL

Attest:

NORCO Pipeline, Inc.

Joyce Eubanks
Joyce Eubanks
Assistant Secretary

By *Jim H. Boyd*
Jim H. Boyd
Vice President

- Assignee

JUL 14 8 55 AM '93
SARAH ELLIOTT
RECORDER

STATE OF INDIANA, S.S. NO.
LAKE COUNTY
FILED FOR REC. 670020

1102

STATE OF KANSAS)
) SS
COUNTY OF MONTGOMERY)

Before me, Mildred L. Russell, a Notary Public, this 26th day of October, 1992, personally appeared ARCO Pipe Line Company, by Norman R. Bennett and Lavern W. Strecker, its Vice President and Assistant Secretary respectively, and acknowledged the execution of the foregoing instrument.

In witness whereof, I have hereunto set my hand and fixed my seal the date and year above written.

Mildred L. Russell
Mildred L. Russell
Notary Public, Montgomery
County, Kansas

My commission expires:
February 7, 1996

STATE OF KANSAS)
) SS
COUNTY OF MONTGOMERY)

Document is
NOT OFFICIAL!

This Document is the property of
the Lake County Recorder!

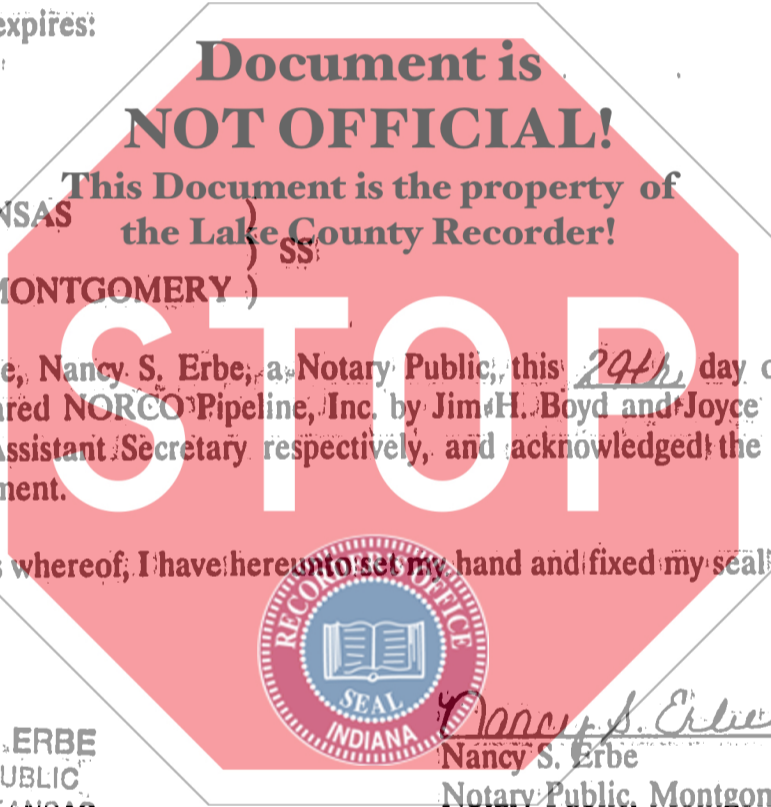

Before me, Nancy S. Erbe, a Notary Public, this 29th day of October, 1992, personally appeared NORCO Pipeline, Inc. by Jim H. Boyd and Joyce Eubanks its Vice President and Assistant Secretary respectively, and acknowledged the execution of the foregoing instrument.

In witness whereof, I have hereunto set my hand and fixed my seal the date and year above written.

NANCY S. ERBE
NOTARY PUBLIC
STATE OF KANSAS

Nancy S. Erbe
Nancy S. Erbe
Notary Public, Montgomery
County, Kansas

My commission expires:
September 30, 1995

This instrument was prepared by John A. Kendall, Senior Attorney, ARCO Pipe Line Company, Houston, Texas.

Line No.	Grantors	Grantee	Property Description	Date	Instrument Recorded	
					Book	Page
16 & 18	Warner P. Christenson, Trustee Roy W. Christenson, Trustee George M. Fishtorn, Trustee	Sinclair Refining Company	<p><u>Description of Maple Street</u> A strip of land 50 feet in width measured at right angles to the Northerly right of way line of the Joliet & Northern Indiana Railroad Company and extending from the East street line of Kennedy Avenue to a line 467.11 feet Easterly of said Kennedy Avenue measured along the Northerly right of way of said Joliet & Northern Indiana Railroad Company;</p> <p><u>Description of Meadow Lane</u> A strip of land 60 feet in width being the East 60 feet of the West 470 feet, and extending from the North line of the SE/4 of Section 4, Township 35 North, Range 9 West of the 2nd principal meridian to the North line of the Joliet & Northern Indiana Railroad Company right of way.</p> <p>Key No. 13-1-17 & 45</p>	Jan. 6, 1944	366	560

