

21

Peter Georges
3577 West Lakeshore Dr.
→ P.O. Box 139
Crown Point 46307

93043218

OFFER AND CONTRACT

Hobart Bldg. Corp.

for

the construction and equipping of a new elementary school building
and renovations and/or improvements to certain facilities
for the School City of Hobart
Lake County, Indiana

SAMUEL
RECORD

JUL 1 10 21

STATE OF INDIANA/S.S.NO.
LAKE COUNTY
FILED FOR RECORD

THIS OFFER, is made this 18th day of MARCH, 1993, by LEE COMPANY INC., P.O. Box No. 567, Terre Haute, Indiana 47808-0567 hereinafter called "CONTRACTOR" and upon acceptance of this Offer in accordance with the terms hereof by the Hobart Bldg. Corp., Fort Wayne, Indiana 46802, an INDIANA CORPORATION, hereinafter call "OWNER", this Offer shall be and become a Contract binding upon Contractor and Owner.

The Contractor and the Owner, for the consideration stated herein, agree as follows:



ARTICLE I. SCOPE OF WORK

The Contractor shall perform everything required to be performed and shall provide and furnish at Contractor's sole cost and expense all the labor, materials, tools, expendable equipment, transportation services, bonds, and insurance requirements required to perform and to complete in a workmanlike manner, all the work required for

PHYSICAL EDUCATION EQUIPMENT FOR THE NEW ELEMENTARY SCHOOL

in strict accordance with the Contract Documents, including any or all addenda prepared by Fanning/Howey Associates, acting, and in the Contract Documents, referred to as the "Architects," and Toth-Ervin, Inc., acting, and in the Contract Documents referred to as the "Project Managers," whose drawings, specifications and other Contractual Documents above mentioned are hereby made a part of this contract, and the Contractor shall do everything required by the Contract and other documents constituting a part thereof.

The Contractor specifically acknowledges that all of the aforesaid Contract Documents have been duly placed on file by Owner with the School City of Hobart, Lake County, Indiana, and were available to Contractor and any other interested persons upon request for public inspection, and that Contractor is specifically bound by the terms of such Contract Documents.

ARTICLE II. CONTRACT PRICE

The Owner shall pay the Contractor for the performance of this Contract, subject to any agreed additions or deductions provided therein, in current funds, the contract price of TWENTY FOUR THOUSAND TWO HUNDRED DOLLARS (\$24,200.00). This price to include all requirements under the Base Bid, Contract Number(s) 15, PHYSICAL EDUCATION EQUIPMENT and No Alternate Bids said Alternates to consist of substitutes, deductions, or additions of certain portions of the work, as set forth in the proposal. Payments are to be made to the contractor in accordance with, and subject to the provisions embodied in the documents made a part of this Contract.

2/16/02

ARTICLE III. TIME OF COMPLETION

The Contractor hereby extends to the Owner the unconditional right to accept the offer herein extended by the Contractor at any time within one hundred twenty (120) days from the date of bid receipt, the acceptance of same to be signified by the execution of this instrument by the Owner and notice to the Contractor of said acceptance. Upon the giving of said notice by Owner, Contractor agrees to commence the work to be performed under this contract in strict compliance with the detailed schedules set forth in the Contract Documents and to faithfully and diligently prosecute and execute the work in all detail, ready for continuous and successful operation, in such fashion that the entire project shall be completed in every respect ready for occupancy as per detailed schedules set forth or required to be prepared in the contract documents, unavoidable delays excepted.

In case the Contractor shall fail to complete the work or any part thereof according to the terms of this Contract, or in the event at any given time the Contractor is unable to furnish evidence satisfactory to Architect disclosing Contractor's ability to perform on a timely basis, then, in such case, the Owner reserves the right and is hereby authorized upon Seventy-Two (72) Hours notice to the Contractor and his surety, to declare this Contract forfeited and to relet the unfinished portion thereof in the manner provided by law; and such person or persons to whom such work shall have been relet shall be and are hereby authorized to complete said portion of the work without hindrance from the Contractor. The Contractor shall be liable, in case of nonperformance of this Contract, or any part thereof, and hereby agrees to pay said owner as damages, all the costs, charges, and expenses attending such reletting, (including reasonable additional Architect's fees and Project Manager's fees), and also such sums or amounts as it shall cost to complete the said Contract over and above the amounts hereby agreed for the various items therefor.

Said damages shall bear interest at a rate per annum which is one percentum in excess of the prime interest rate then charged by (TO BE ADVISED), Indiana or the maximum rate allowed by law, whichever is lesser, and shall be increased by an amount equal to a like rate of interest computed on the total advancements and payments made by the Owner commencing the day following the scheduled completion date. Notwithstanding anything herein contained to the contrary such damages exclusive of interest shall not exceed the amount retained by the Owner, plus any other sums due the Contractor, as further referenced and provided by Article VI.

ARTICLE IV. COMPONENT PARTS OF THIS CONTRACT

This Contract consists of the following component parts, referred to herein as the Contract Documents, all of which are as fully a part of this Contract as if herein set out; or, if not attached, as if hereto attached:

- (1) Specifications consisting of:
General Conditions and Supplemental Conditions
Specifications for Workmanship and Materials
- (2) Addenda Nos. ONE-2/19/93, TWO-2/24/93, THREE-2/26/93
- (3) Construction Drawings
- (4) Drawings and descriptions submitted by the Contractor and approved by the Architect
- (5) This Contract
- (6) Subcontractor/Material Suppliers List (reviewed by Architect/Engineer)

ARTICLE V. CONTRACT PROVISION

The Contractor covenants and agrees to pay all damages for injury to real or personal property, or for any injury or death sustained by any person growing out of any act or deed or omission of the Contractor or of his employees or any of his subcontractors or their employees, irrespective of any other provision of this Contract.

The Contractor agrees to indemnify and save harmless the Owner and any lessee of Owner, their agents and employees, and the Trustee, from and against all loss and expenses (including costs and attorneys' fees) by reason of liability imposed by law upon the Owner or lessee, or Trustee, for damages because of bodily injury, including death at any time resulting therefrom sustained by any person or persons and on account of damage to property, including loss of use thereof, arising out of or in consequence of the performance of this work, provided such injury to persons or damage to property is due or claimed to be due to negligence of the contractor, his subcontractors, employees or agents. The term Owner shall be construed to include any and all successors to the currently named Owner, irrespective of how such succession occurred and/or who or what the successor(s) is or are. The term lessee shall specifically include the School City of Hobart, their assigns and successors.

NOT OFFICIAL!
This Document is the property of

ARTICLE VI. PAYMENT OF CONTRACT SUM Recorder!

Payment(s) to the Contractor will be made each month (starting when work commences) in an amount equal to ninety (90%) percent of the contract values of the work done and materials permanently in place and stored on the site at the close of the preceding month, as determined by the Architect and as so certified to the Owner. Approval for said payments must first be authorized by the Architect, the Project Manager/Construction Manager and then approved by the School City of Hobart Board of School Trustees, or their authorized representative, at their regularly scheduled meetings or as otherwise specified and thereafter the Owner will make payment within five (5) days after receipt of all approvals.

The Contractor may request in writing, directed to the Owner, Architect, and Project Manager to approve no further retainage when fifty percent (50%) of the Contract amount has been attained. Approval will be considered in accordance with the Supplemental Conditions.

The provisions of Indiana Code 36-1-12-14 (f) are hereby waived and payment of any retained percentages will be made when all punch list items are certified complete by Architect, Project Manager/Construction Manager and accepted by Owner. In the event that the completion date for each portion of the work is not met or other damages have accrued, Contractor shall pay to Owner upon said final payment, an amount equal to the aforesaid damages plus the interest as provided in the said Article III above, and said retainage, together with all other sums to which the Contractor might be or become entitled, may be applied against the same.

ARTICLE VII. NO-LIEN CONTRACT

The parties hereto do hereby covenant and agree that no lien shall attach to the real estate by the Contractor, subcontractors, mechanics, journeymen, laborers, or persons performing labor upon or furnishing materials or machinery for the work provided for under the terms of this Contract, and for the purpose of complying with the provision of Indiana Code 32-8-3 as amended, the parties agree that this Contract may be recorded with the Recorder of Lake County,

Indiana. Contractor shall require all subcontractors, materialmen or other parties contracting with Contractor for this project to acknowledge this no-lien provision.

ARTICLE VII. LOCATION OF PREMISES

The buildings and work to be performed under this Contract shall be on land located in Lake County, Indiana, more particularly described in Exhibit "A" attached hereto and incorporated herein by reference.

ARTICLE IX. SUBSEQUENT OWNER

The parties now contemplate that the Owner shall, as soon as possible, convey the real estate to ~~(TO BE ADVISED)~~ Trustee, _____, Indiana and therefor, the parties now covenant and agree that any such conveyance shall in no way affect the no-lien provisions of this contract which are expressly made for the benefit of the Owner herein, and any subsequent Owner as hereinabove contemplated.

NOT OFFICIAL!

This Document is the property of
the Lake County Recorder!

ARTICLE X. TERMINATION PROVISION

Contractor further agrees if "Notice to Proceed" as provided for in the Contract Documents is not issued by Owner to contractor within Thirty (30) Days after acceptance by Owner of said Contract, this contract shall be voidable by Owner without liability.

ARTICLE XI. BENEFITS SHALL SURVIVE

IT IS FURTHER AGREED AND UNDERSTOOD BY AND BETWEEN THE PARTIES HERETO, that the building to be constructed and the work to be performed under this Contract are for the occupancy and use by the School City of Hobart, Lake County, Indiana, and the Contractor hereunder expressly agrees that all the Contractor's obligations, including guarantees, bonds and performance standards shall inure directly in favor of said School City of Hobart, Lake County, Indiana in its own name and right without the necessity of joining any other party of this Contract.

ARTICLE XII. ASSIGNMENT

Contractor hereby approves and consents to the assignment by Owner to the School City of Hobart, of that portion of this Contractor's Offer and Contract, and the Performance Payment and Maintenance Bond with Owner, to the extent that this Offer and Contract pertains to the facilities building to be constructed upon real estate owned by the School City of Hobart.

FURTHER, Contractor hereby approves and consents to the assignment by Owner to ~~(TO BE ADVISED)~~ Trustee, of this Contractor's Offer and Contract, and the Performance Payment and Maintenance Bond with Owner, and Contractor shall be obligated and bound to Trustee as set forth in Contractor's Contract with Owner, which Contract is incorporated herein by reference.

To each of the conditions and obligations of this Contract, the undersigned Contractor, binds itself, its successors, and assigns.

In witness whereof, the Contractor has executed this Offer and Contract the date and year first above written.

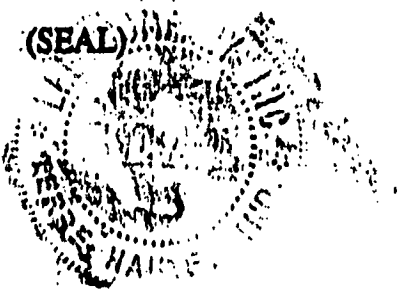

LEE COMPANY, INC.
Contractor

By: Daniel A. Senseman

Daniel S. Senseman, President
Printed Signature & Title

ATTEST:

BY: Robert D. Senseman

Robert D. Senseman, Ass't. Sec'y.
Printed Signature & Title

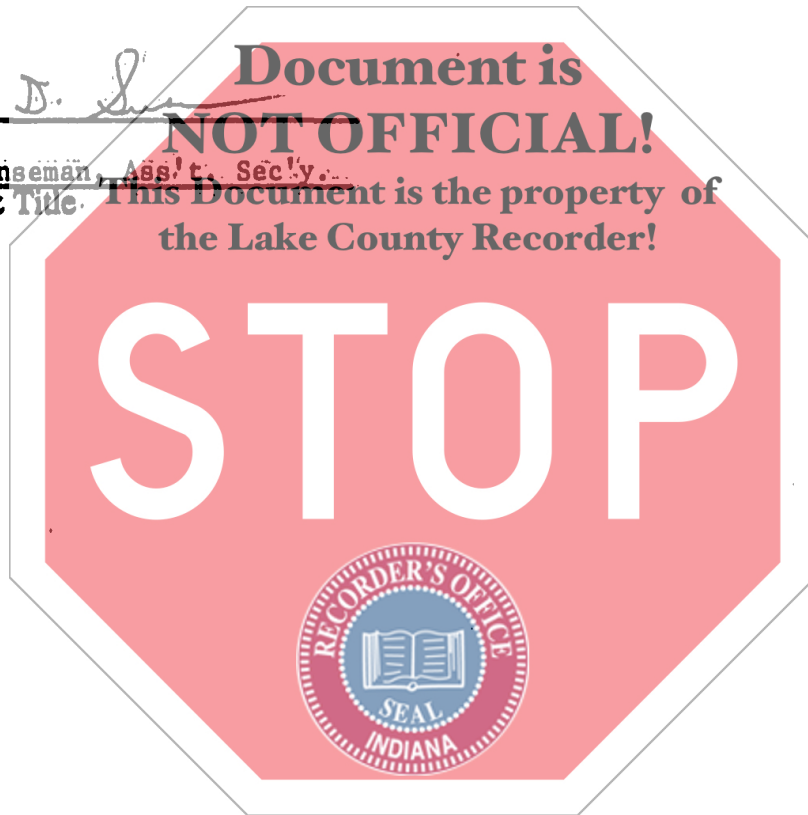

STATE OF INDIANA)
) SS:
COUNTY OF)

Before me, a Notary Public, in and for the aforesaid State and County, this 26th day of April, 1993, personally appeared Daniel S. Senseman and Robert D. Senseman personally known to me to be the President and Ass't. Sec'y. of the Contractor herein acknowledged the execution of the foregoing offer for, on behalf of, and in the name of said contractor as its voluntary act and deed.

Diana Conn
Notary Public Diana Conn

(SEAL)

Printed Signature

My Commission Expires 8/5/96
Residing in Vigo County.

The foregoing is hereby accepted this 28 day of July, 1993, which shall be construed as the date of the Contract.

Document is NOT OFFICIAL!
This Document is the property of
HOBART BLDG. CORP.
of the Lake County Recorder!

By: Thomas B. Summers
Thomas B. Summers, President

ATTEST:

O. Roderick Wilson
O. Roderick Wilson, Secretary

STATE OF INDIANA)
) SS:
COUNTY OF ALLEN)

Before me, a Notary Public, in and for the aforesaid State and County, this 28 day of July, 1993, personally appeared THOMAS B. SUMMERS and O. RODERICK WILSON, personally known to me as the President and Secretary, respectively, of Hobart Bldg. Corp., and acknowledged the foregoing acceptance of said offer as its voluntary act and deed.

Jenny L. Baker
Notary Public

(SEAL)

Jenny L. Baker
Printed Signature

My Commission Expires: January 8, 1994
Residing in Allen County

This Instrument Prepared by: Richard D. Robinson
Attorney-at-Law
215 E. Berry Street
Fort Wayne, IN 46802

CORPORATE RESOLUTION

BE IT RESOLVED, that the proposed Offer and Contract (the "Contract") with Hobart Bldg. Corp. (hereinafter "Owner") as Owner, and this corporation, as contractor, for the construction and equipping of a new elementary school building and renovations and/or improvements to certain facilities for the School City of Hobart, CONTRACT NO. 15 in the form submitted to this Board is hereby approved.

BE IT FURTHER RESOLVED, THAT THIS Contractor shall furnish performance, payment and maintenance bonds (the "Bond") in the amount of one hundred-fifty per cent (150%) of the amount of the contract to Owner and to such other parties as owner may designate, with a good and sufficient surety acceptable to owner, and the Bonds and such surety shall be in the usual form acceptable in the State of Indiana for work of the nature covered by the Contract. The Bonds and such surety are hereby approved.

BE IT FURTHER RESOLVED, that Daniel S. Senseman, or

(1. Name of Officer)

Robert D. Senseman

(2. Name of Officer)

or **NOT OFFICIAL!**

(3. Name of Officer)

This Document is the property of the Lake County Recorder!

(4. Name of Officer)

(1. Office Held)

Ass't. Sec'y.

(2. Office Held)

(3. Office Held)

(4. Office Held), respectively of this Contractor be and each is hereby authorized and directed individually, and without any other officer attesting thereto, to execute, acknowledge and deliver the Contract and the Bond for and on behalf of and in the name and as the act of this Contractor with such changes therein not inconsistent with this resolution and not substantially adverse to this Contractor as may be approved by the officer, and that such are not substantially adverse to this Contractor, shall be conclusively evidenced by the execution of the Contract and the Bond by such officer.

CERTIFICATION



I, Robert D. Senseman, hereby certify:
(Print your name).

Ass't.

1. That I am the duly elected Secretary of LEE COMPANY, INC.

(the "Contractor") and as such am authorized to execute and deliver this Certificate and have in my possession and under my direct supervision, records and minutes of the meetings of the Board of Directors of the Contractor.

2. The foregoing is a true, correct and complete copy of the resolutions duly adopted by the Contractor's Board of Directors and a meeting duly convened and held on March 11, 1993 at which a quorum was present and acting throughout, which resolutions have not been altered, amended or repealed, have been in full force and effect at all times since the date of their adoption and are in full force and effect on the date hereof.

3. Each person, who as an officer of the Contractor, executed the Contract and the Performance, Payment and Maintenance Bonds authorized by said resolution, was duly elected or appointed, qualified and acting as such officer at the time of such execution and delivery of the Contract and the Performance, Payment and Maintenance Bond, and the signatures of such persons appearing on the Contract and the Performance, Payment and Maintenance Bond are their true and genuine signatures. The Contract and the Performance, Payment and Maintenance Bond, as executed, were in substantially the form presented to said Board of Directors as referred to in said resolutions.

Dated: April 26, 1993.

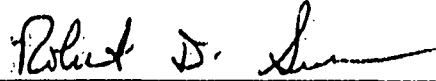

(Signature of Secretary)

Ass't.

Document is

Robert D. Senseman

Printed Name of Secretary

Ass't.

NOT OFFICIAL

This Document is the property of
the Lake County Recorder!

STOP



SECTION 00500:- ATTACHMENT

The Supplementary and other Conditions of the Contract are those contained in the Project Manual dated February 1, 1993, and are as follows:

Document	Title	Pages
Project Manual Volume I	New Elementary School	

SEE ATTACHED TABLE OF CONTENTS

The Specifications are those contained in the Project Manual dated as above, and are as follows: (Either list the Specifications here or refer to an exhibit to this Agreement.)

Section	Title
Project Manual Volume II	Dated February 1, 1993
SEE ATTACHED TABLE OF CONTENTS	
Project Manual Volume III	Dated February 1, 1993
SEE ATTACHED TABLE OF CONTENTS	

The Drawings are as follows, and are dated February 1, 1993 unless a different date is shown below. (Either list the Drawings here or refer to an exhibit attached to this Agreement.)

Number	Title
-	Cover
-	Index Sheet
-	Survey
GD1.1	Sitework
G1.0 - G1.1	Sitework
G2.1	Sitework
G3.1 - G3.4	Sitework
G4.1 - G4.2	Sitework
L1.1	Sitework
SU1.1 - SU1.2	Sitework
SU2.1	Sitework
A1.1 - A1.5	Architectural
A2.1	Architectural
A3.1 - A3.3	Architectural
A4.1 - A4.2	Architectural
A5.1 - A5.7	Architectural
A6.1	Architectural



SECTION 00500 - ATTACHMENT

Number	Title	Date
A7.1 - A7.7	Architectural	
A8.1 - A8.2	Architectural	
A9.1 - A9.4	Architectural	
A10.1	Architectural	
FS.1 - PS.5	Food Service	
S1.1 - S1.6	Structural	
S2.1 - S2.7	Structural	
S5.1	Structural	
P1.1	Plumbing	
P2.1 - P2.4	Plumbing	
P3.1 - P3.2	Plumbing	
P4.1	Plumbing	
M1.1	Mechanical	
M2.1 - M2.6	Mechanical	
M3.1 - M3.4	Mechanical	
M5.1 - M5.3	Mechanical	
M6.1	Mechanical	
E1.1	Electrical	
E2.1	Electrical	
E3.1	Electrical	
E4.1 - E4.4	Electrical	
E5.1 - E5.4	Electrical	
E6.1	Electrical	
E7.1	Electrical	
E8.1 - E8.4	Electrical	

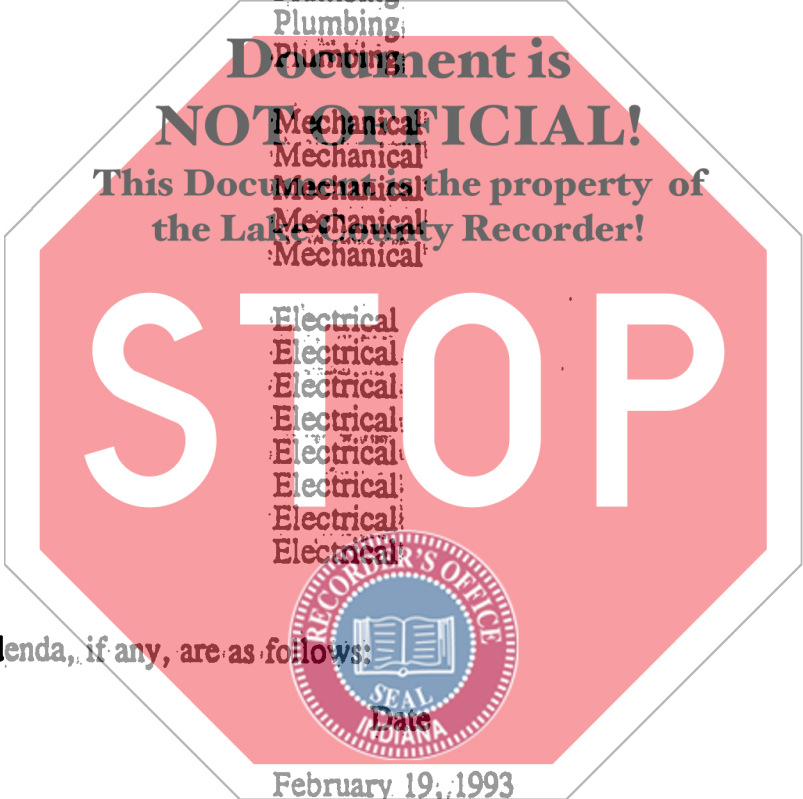

The Addenda, if any, are as follows:

Number	Date
No. 1	February 19, 1993
No. 2	February 24, 1993
No. 3	February 26, 1993

Portions of Addenda relating to bidding requirements are not part of the Contract Documents unless the bidding requirements are also enumerated herein.

Other Documents, if any, forming part of the Contract Documents are as follows: (List here any additional documents which are intended to form part of the Contract Documents. The General Conditions provide that bidding requirements such as advertisement or invitation to bid, Instructions to Bidders, sample forms and the Contractor's bid are not part of the Contract

SECTION 00500 - ATTACHMENT

Documents unless enumerated in this Agreement. They should be listed here only if intended to be part of the Contract Documents.)

Subcontractors & Materials List (Section 00430 as reviewed by the Architect and Engineer.)

This Agreement is entered into as of the day and year first written above and is executed in at least three (3) original copies of which one (1) is to be delivered to the Contractor, one to the Architect for use in the administration of the Contract, and the remainder to the Owner.

No lien Agreement: Contractor, for itself and all parties claiming through contractor who would be entitled to liens as provided in IC 32-8-3-1 et seq., agrees with Owner that **NO LIENS** shall attach to and hereby waives all rights to file mechanics' liens against the project real estate, which is more particularly described in Exhibit A and Exhibit B attached hereto and hereby made a part hereof, or to any improvements now existing or to be constructed thereon in favor of contractor, any subcontractor, mechanic, journeyman, laborer, material vendor, lessor of tools or machinery, or any other party or machinery for construction or improvements on the project real estate pursuant to the contract documents or pursuant to any subsequent agreement between Owner and contractor to furnish extras or additions.



SECTION 00001

TABLE OF CONTENTS

- 00001 - Title Page
Table of Contents

BIDDING REQUIREMENTS

- 00030 - Notice to Bidders
- 00100 - Instructions to Bidders
- 00120 - Supplementary Instructions to Bidders
- 00210 - Preliminary Construction Schedule
- 00220 - Soil Investigation Data
- 00300 - Supplemental Bid Proposal Form (Including Non-Collusion Bidding, Certification and Domestic Steel Affidavit)

CONTRACT DOCUMENTS

- 00430 - Subcontractors List
- 00480 - Non-collusion Affidavit
- 00500 - Agreement Forms
- 00530 - Escrow Agreement

CONTRACT CONDITIONS

- 00700 - AIA General Conditions
- 00800 - Supplementary Conditions
- 00830 - Wage Determination Schedule

SPECIFICATIONS

DIVISION 1: GENERAL REQUIREMENTS

- 01010 - Summary of the Work
- 01011 - Contract Categories
- 01020 - Allowances
- 01027 - Application for Payment
- 01028 - Change Order Procedure
- 01030 - Alternatives
- 01043 - Project Work Rules
- 01045 - Cutting & Patching
- 01050 - Field Engineering
- 01055 - Work Layout
- 01060 - Regulatory Requirements
- 01090 - Reference Standards
- 01200 - Project Meetings
- 01300 - Submittals
- 01310 - Construction Milestone Schedule
- 01370 - Schedule of Values
- 01400 - Quality Control
- 01410 - Testing Laboratory Service
- 01500 - Construction Facilities and Temporary Controls
- 01531 - Temporary Fences



SECTION 00001 - TABLE OF CONTENTS

- 01550 - Access Roads & Parking Areas
- 01560 - Construction Cleaning
- 01580 - Project Identification & Signs
- 01600 - Materials & Equipment
- 01605 - Products and Substitutions
- 01650 - Starting Systems
- 01660 - Testing, Adjusting & Balancing of Systems
- 01700 - Project Closeout
- 01710 - Cleaning

DIVISION 2 THROUGH 16

(Refer to Architectural and Engineering Specification Manuals Volumes II and III)



TABLE OF CONTENTS

VOLUME II

DIVISION 2: SITEWORK

02050	Demolition
02100	Site Preparation
02200	Earthwork
02280	Soil Treatment
02511	Asphaltic Concrete Paving
02516	Portland Cement Concrete Paving
02710	Subdrainage Systems
02720	Storm Sewerage Systems
02800	Site Improvements
02830	Fences and Gates
02862	Playground Equipment
02930	Lawns and Grasses
02950	Trees, Plants, and Ground Covers

DIVISION 3: CONCRETE

03100	Concrete Formwork
03200	Concrete Reinforcement
03300	Cast-In-Place Concrete
-	Concrete Finish Schedule

DIVISION 4: MASONRY

04100	Mortar
04125	Masonry Grout
04150	Masonry Accessories
04200	Unit Masonry
04460	Limestone

DIVISION 5: METALS

05100	Structural Metal Framing
05200	Metal Joists
05300	Metal Decking
05500	Metal Fabrications
05520	Handrails and Railings

DIVISION 6: WOOD AND PLASTICS

06100	Rough Carpentry
06200	Finish Carpentry



DIVISION 7: THERMAL AND MOISTURE PROTECTION:

07110 Sheet Membrane Waterproofing
07150 Dampproofing
07210 Building Insulation
07220 Roof and Deck Insulation
07240 Exterior Insulation and Finish System
07255 Sprayed-On Fireproofing and Insulation
07256 Spray-On Acoustical Insulation
07270 Firestopping
07310 Shingles
07600 Flashing and Sheet Metal
07724 Prefabricated Curbs
07820 Metal-Framed Skylights
07920 Sealants and Caulking

DIVISION 8: DOORS AND WINDOWS:

08110 Door and Frame Schedule
08110 Steel Door and Frames
08121 Flush Aluminum Doors and Frames
08210 Wood Doors
08521 Aluminum Windows
08710 Door Hardware
08800 Glazing
This Document is the property of
the Lake County Recorder!

DIVISION 9: FINISHES

09200 Room Finish Schedule
09215 Lath and Plaster
09215 Veneer Plaster
09250 Gypsum Board
09300 Tile
09382 Cultured Marble Window Sills
09510 Acoustical Ceilings
09550 Wood Flooring
09660 Resilient Tile Flooring
09665 Resilient Sheet Flooring
09680 Carpet
09900 Painting
09955 Vinyl-Coated Fabric Wall Covering

DIVISION 10: SPECIALTIES

10100 Visual Display Boards
10125 Projection Screens
10160 Metal Toilet Compartments
10162 Solid Plastic Toilet Compartments
10190 Cubicle Curtains and Tracks
10200 Louvers and Vents
10400 Identifying Devices
10502 Standard Lockers
10520 Fire Extinguishers and Cabinets
10652 Operable Walls
10680 Storage and Shelving Systems
10810 Toilet Accessories

DIVISION 11: EQUIPMENT

11060 Stage Curtains and Tracks
11400 Food Service Equipment
11450 Residential Equipment
- Residential Equipment Schedule
11480 Physical Education Equipment
- Physical Education Equipment Schedule
11486 Gym Divider

DIVISION 12: FURNISHINGS

12315 Media Center Casework
- Media Center Casework Schedule
12324 Educational Casework
- Educational Casework Schedule
12380 Display Casework
12690 Floor Grid and Frames

DIVISION 13: SPECIAL CONSTRUCTION - NOT USED

DIVISION 14: CONVEYING SYSTEMS - NOT USED



VOLUME III

DIVISION 15: MECHANICAL

15000	General Mechanical Requirements
15010	Firestopping
15060	Pipe and Fittings
15080	Piping Specialties
15090	Supports, Anchors, and Seals
15100	Valves
15130	Thermostatic Mixing Valves
15140	Hot Water Return Pump and Accessories
15170	Thermometers and Gauges
15200	Piping Expansion Compensation
15210	Vibration Isolation
15250	Insulation
15404	Backflow Prevention Devices
15410	Natural Gas Piping
15423	Domestic Water Heater
15450	Plumbing Fixtures and Trim
15490	Central Vacuum Cleaning System
15500	Fire Protection
15530	Refrigeration Piping
15540	HVAC Pumps and Accessories
15557	Cathodic Protection
15560	Steel Fire Box Boilers
15607	Expansion Tank and Gravity Recorder
15608	Piping Specialties - HVAC
15616	Prefabricated Chimneys/Stacks
15640	Water Treatment - HVAC
15671	Reciprocating Compressor Chiller and Air-Cooled Condenser
15752	Finned Tube Radiation
15759	Cabinet Heaters
15761	Fan Coil Units
15763	Air Handling Units and Accessories
15768	Fan-Powered Variable Volume Terminal Units
15830	Exhaust Fans
15841	Low Pressure Steel Ductwork and Accessories
15842	High Pressure Steel Ductwork
15847	Flexible Ductwork
15850	Air Distribution Devices
15855	Kitchen Hood Ventilation System
15856	VAV Linear Air Supply Diffusers and Return Slots
15901	Temperature Control System
15950	Testing and Balancing



DIVISION 16: ELECTRICAL

16010	General Provisions
16011	Temporary Work
16015	Firestopping
16050	Basic Materials and Methods
16110	Raceway
16111	Conduit
16111-S	Allowable Conduit Usage Schedule (1 pg.)
16120	Wire and Cable Power System
16121	Power System Wire Connections and Devices
16131	Pull Boxes
16134	Outlet Boxes
16134-S	Outlet Locations (1 pg.)
16140	Wiring Devices
16140-S	Schedule "A" & Schedule "B" (2 pgs.)
16150	Motors
16155	Starters, Disconnects, and Controllers
16155-S	Schedules "A", "B", and "C" (3 pgs.)
16159	Switchboards
16160	Panelboards, Distribution Panels, and Cabinets
16170	Switches
16170-S	Safety Switches Schedule (1 pg.)
16181	Fuses and Fuse Holders
16182	Circuit Breakers
16182-S	Breaker Service Schedule (1 pg.)
16190	Hangers and Supporting Devices
16400	Service and Distribution
16420	Power Factor Correction
16421	Surge Arresters
16450	Grounding
16470	Dry-Type Transformers
16470-S	Schedule "A" (1 pg.)
16500	Lighting
16501	Lamps, Ballasts, Accessories
16510	Stage Dimming System
16666	Scorekeeping Systems
16700	Communication System
16720	Security System
16721	Fire Alarm and Detection System
16730	Clock System
16740	Telephone System
16770	Central Sound System - "CS"
16775	Gym/Dining/Commons Sound System
16950	Integrated Technology
16960	Computer Network System



VOLUME II

DIVISION 2: SITEWORK

- 02050 Demolition
- 02100 Site Preparation
- 02200 Earthwork
- 02280 Soil Treatment
- 02511 Asphaltic Concrete Paving
- 02516 Portland Cement Concrete Paving
- 02710 Subdrainage Systems
- 02720 Storm Sewerage Systems
- 02800 Site Improvements
- 02830 Fences and Gates
- 02862 Playground Equipment
- 02930 Lawns and Grasses
- 02950 Trees, Plants, and Ground Covers

DIVISION 3: CONCRETE

- 03100 Concrete Formwork
- 03200 Concrete Reinforcement
- 03300 Cast-In-Place Concrete
- Concrete Finish Schedule

DIVISION 4: MASONRY

- 04100 Mortar
- 04125 Masonry Grout
- 04150 Masonry Accessories
- 04200 Unit Masonry
- 04460 Limestone

DIVISION 5: METALS

- 05100 Structural Metal Framing
- 05200 Metal Joists
- 05300 Metal Decking
- 05500 Metal Fabrications
- 05520 Handrails and Railings

DIVISION 6: WOOD AND PLASTICS

- 06100 Rough Carpentry
- 06200 Finish Carpentry



DIVISION 7: THERMAL AND MOISTURE PROTECTION

- 07110 Sheet Membrane Waterproofing
- 07150 Dampproofing
- 07210 Building Insulation
- 07220 Roof and Deck Insulation
- 07240 Exterior Insulation and Finish System
- 07255 Sprayed-On Fireproofing and Insulation
- 07256 Spray-On Acoustical Insulation
- 07270 Firestopping
- 07310 Shingles
- 07600 Flashing and Sheet Metal
- 07724 Prefabricated Curbs
- 07820 Metal-Framed Skylights
- 07920 Sealants and Caulking

DIVISION 8: DOORS AND WINDOWS

- 08110 Door and Frame Schedule
- 08120 Steel Doors and Frames
- 08210 Flush Aluminum Doors and Frames
- 08220 Wood Doors
- 08321 Aluminum Windows
- 08710 Door Hardware
- 08800 Glazing

DIVISION 9: FINISHES

- 09200 Room Finish Schedule
- 09215 Lath and Plaster
- 09215 Veneer Plaster
- 09250 Gypsum Board
- 09300 Tile
- 09382 Cultured Marble Window Sills
- 09510 Acoustical Ceilings
- 09550 Wood Flooring
- 09660 Resilient Tile Flooring
- 09665 Resilient Sheet Flooring
- 09680 Carpet
- 09900 Painting
- 09955 Vinyl-Coated Fabric Wall Covering

DIVISION 10: SPECIALTIES

- 10100 Visual Display Boards
- 10125 Projection Screens
- 10160 Metal Toilet Compartments
- 10162 Solid Plastic Toilet Compartments
- 10190 Cubicle Curtains and Tracks
- 10200 Louvers and Vents
- 10400 Identifying Devices
- 10502 Standard Lockers
- 10520 Fire Extinguishers and Cabinets
- 10652 Operable Walls
- 10680 Storage and Shelving Systems
- 10810 Toilet Accessories

DIVISION 11: EQUIPMENT

- 11060 Stage Curtains and Tracks
- 11400 Food Service Equipment
- 11450 Residential Equipment
- Residential Equipment Schedule
- 11480 Physical Education Equipment
- Physical Education Equipment Schedule
- 11486 Gym Divider

DIVISION 12: FURNISHINGS

- 12315 Media Center Casework
- Media Center Casework Schedule
- 12324 Educational Casework
- Educational Casework Schedule
- 12380 Display Casework
- 12690 Floor Grid and Frames

DIVISION 13: SPECIAL CONSTRUCTION - NOT USED

DIVISION 14: CONVEYING SYSTEMS - NOT USED



VOLUME III

DIVISION 15: MECHANICAL

15000	General Mechanical Requirements:
15010	Firestopping
15060	Pipe and Fittings
15080	Piping Specialties
15090	Supports, Anchors, and Seals
15100	Valves
15130	Thermostatic Mixing Valves
15140	Hot Water Return Pump and Accessories
15170	Thermometers and Gauges
15200	Piping Expansion Compensation
15210	Vibration Isolation
15250	Insulation
15404	Backflow Prevention Devices
15410	Natural Gas Piping
15423	Domestic Water Heater
15450	Plumbing Fixtures and Trim
15490	Central Vacuum Cleaning System
15500	Fire Protection
15530	Refrigeration Piping
15540	HVAC Pumps and Accessories
15557	Cast Iron Boilers
15560	Steel Fire Box Boilers
15607	Expansion Tank and Control Recorder
15608	Piping Specialties - HVAC
15616	Prefabricated Chimneys/Stacks
15640	Water Treatment - HVAC
15671	Reciprocating Compressor Chiller and Air-Cooled Condenser
15752	Finned Tube Radiation
15759	Cabinet Heaters
15761	Fan-Coil Units
15763	Air Handling Units and Accessories
15768	Fan-Powered Variable Volume Terminal Units
15830	Exhaust Fans
15841	Low Pressure Steel Ductwork and Accessories
15842	High Pressure Steel Ductwork
15847	Flexible Ductwork
15850	Air Distribution Devices
15855	Kitchen Hood Ventilation System
15856	VAV Linear Air Supply Diffusers and Return Slots
15901	Temperature Control System
15950	Testing and Balancing

DIVISION 16: ELECTRICAL

16010	General Provisions
16011	Temporary Work
16050	Basic Materials and Methods
16110	Raceway
16111	Conduit
16111-S	Allowable Conduit Usage Schedule (1 pg.)
16120	Wire and Cable Power System
16121	Power System Wire Connections and Devices
16131	Pull Boxes
16134	Outlet Boxes
16134-S	Outlet Locations (1 pg.)
16140	Wiring Devices
16140-S	Schedule "A" & Schedule "B" (2 pgs.)
16150	Motors
16155	Starters, Disconnects, and Controllers
16155-S	Schedules "A", "B", and "C" (3 pgs.)
16159	Switchboards
16160	Panelboards, Distribution Panels, and Cabinets
16170	Switches
16170-S	Safety Switches Schedule (1 pg.)
16181	Fuses and Fuse Holders
16182	Circuit Breakers
16182-S	Breaker Service Schedule (1 pg.)
16190	Hangers and Supporting Devices
16400	Service and Distribution
16420	Power Factor Correction
16421	Surge Arresters
16450	Grounding
16470	Dry-Type Transformers
16470-S	Schedule "A" (1 pg.)
16500	Lighting
16501	Lamps, Ballasts, Accessories
16510	Stage Dimming System
16666	Scorekeeping Systems
16700	Communication System
16720	Security System
16721	Fire Alarm and Detection System
16730	Clock System
16740	Telephone System
16770	Central Sound System - "CS"
16775	Gym/Dining/Commons Sound System
16950	Integrated Technology
16960	Computer Network System

Document is
NOT OFFICIAL!

This Document is the property of
the Hamilton County Recorder!

STOP





27 SOUTH TWELFTH STREET
 P.O. BOX NO. 847
 TERRE HAUTE, INDIANA 47608-0567
 PHONE 812 235-8155
 FAX 812 235-3587

Contractors and Furnishers of Educational, Health Care and Laboratory Equipment

FACSIMILE TRANSMITTAL COVER SHEET

TOTH ERVIN INCORPORATED

MAR - 3 1993

RECEIVED

DATE: 3/3/93

NUMBER OF SHEETS: 2 (Including Transmittal Sheet)

TO: TOTH-ERVIN, INC.

RE: SCHOOL CITY OF HOBART

FROM: Diana Conn

Fax Number: 812-235-3587

SPECIAL INSTRUCTIONS:



SECTION 00430 - SUBCONTRACTORS AND MATERIALS LIST

<u>SECTION</u>	<u>MATERIAL AND/OR EQUIPMENT</u>	<u>MANUFACTURER</u>	<u>SUPPLIER/FABRICATOR</u>	<u>INSTALLER/CONTRACTOR</u>
10680	Storage & Shelving Systems	N/A	N/A	N/A
10810	Toilet Accessories	N/A	N/A	N/A

DIVISION 11 - EQUIPMENT

11060	Stage Curtains & Tracks	N/A	N/A	N/A
11400	Food Service Equipment	N/A	N/A	N/A
11450	Residential Equipment	N/A	N/A	N/A
11480	Physical Education Equipment	PORTER ATH. EQUIP.	LEE COMPANY, INC.	LEE COMPANY, INC.
11486	Gym Divider	PORTER ATH. EQUIP.	" " "	" "

DIVISION 12 - FURNISHINGS

12315	Media Center Casework	N/A	N/A	N/A
12324	Educational Casework	N/A	N/A	N/A
12380	Display Casework	N/A	N/A	N/A
12690	Floor Grid & Frames	N/A	N/A	N/A

DIVISION 13 - SPECIAL CONSTRUCTION

NOT USED

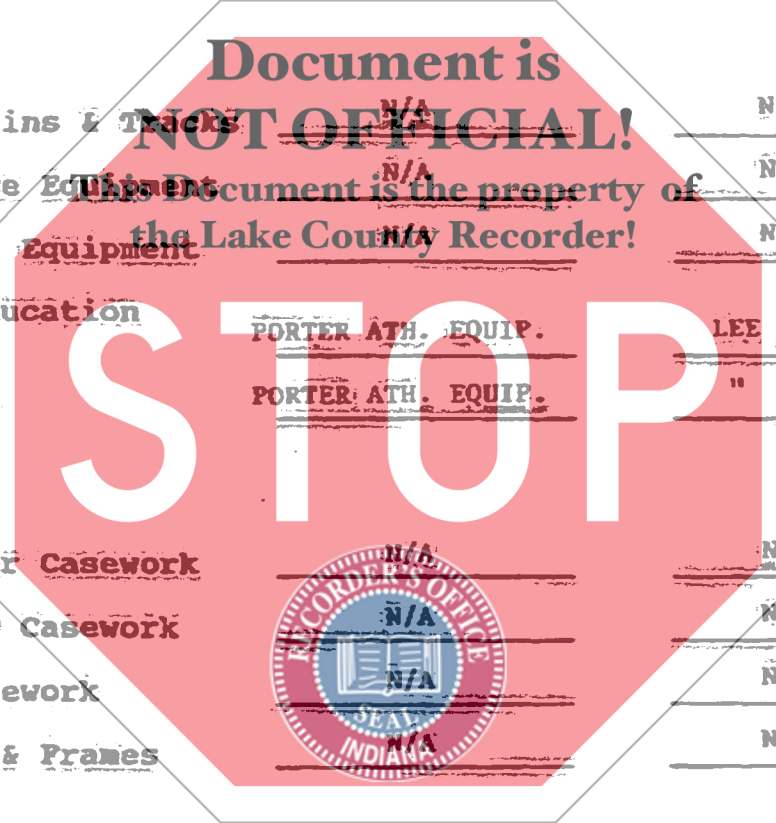

03-03-83 18:23 0512 235 3557 LEE COMPANY, INC. 002 002