

THIS FORM HAS BEEN PREPARED FOR USE WITHIN THE STATE OF INDIANA. THE SELECTION OF A FORM OF INSTRUMENT, FILLING IN BLANK SPACES, STRIKING OUT PROVISIONS, AND INSERTION OF SPECIAL CLAUSES, MAY CONSTITUTE THE PRACTICE OF LAW AND SHOULD ONLY BE DONE BY A LAWYER.

93043044

Tax Key No.: 26-36-50-113 143

Mail tax bills to:

5644 Walter Street  
Hammond, Indiana 46320

# WARRANTY DEED

This indenture witnesseth that **DOPPLER BROTHERS INVESTMENTS**

of **LAKE** County in the State of **INDIANA**

Convey and warrant to **RALPH HOOSIER and VERNA L. HOOSIER, Husband and Wife**

of **LAKE** County in the State of **INDIANA**

for and in consideration of **Ten Dollars and other good and valuable consideration**  
the receipt whereof is hereby acknowledged, the following Real Estate in **LAKE** County  
in the State of Indiana, to wit:

Lot 43 and the North 1/2 of Lot 42 in E.W. Schiller's Second Addition to the City of Hammond, as per plat thereof, recorded in Plat Book 2 page 17, in the Office of the Recorder of Lake County, Indiana.

Commonly known as: **5644 Walter Street, Hammond, Indiana 46320**

Subject to past and current year real estate taxes.

Subject to easements, restrictions and covenants of record, if any.

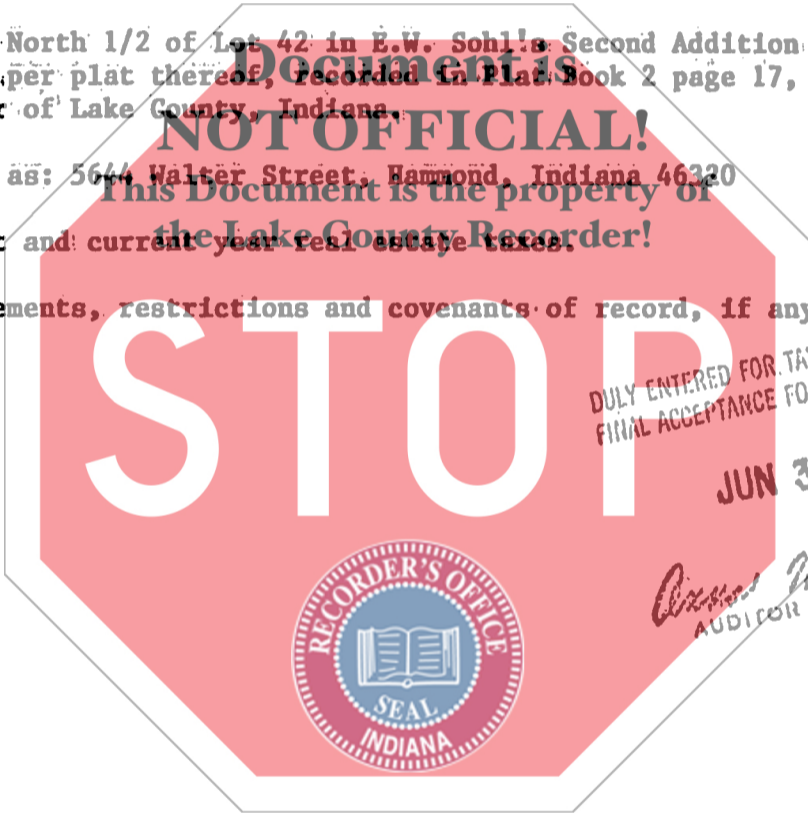

DULY ENTERED FOR TAXATION SUBJECT TO FINAL ACCEPTANCE FOR TRANSFER

JUN 30 1993

Auditor Lake County

JUN 30 4 04 PM '93

STATE OF INDIANA/S.S.M.D. CLERK OF SUPERIOR COURT

State of Indiana, **LAKE** County, ss:

Before me, the undersigned, a Notary Public in and for said County and State, this **25th** day of **June** 19 **93** personally appeared:

**FRED P. DOPPLER, SR. and THOMAS J. DOPPLER**  
Partners of Doppler Brothers Investments

BY:

Dated this **25th** Day of **June** 19 **93**

**DOPPLER BROTHERS INVESTMENTS**

*Fred P. Doppler Sr.*  
**FRED P. DOPPLER, SR., Partner**

**THOMAS J. DOPPLER Partner**

*Thomas J. Doppler*

And acknowledged the execution of the foregoing deed. In witness whereof, I have hereunto subscribed my name and affixed my official seal. My commission expires **June 7, 1996**

*Thomas G. Schiller*  
**Thomas G. Schiller Notary Public**

Resident of **LAKE** County.

This instrument prepared by **JOHN D. BRECLAW, JOHN D. BRECLAW & ASSOCIATES**  
200 West Glen Park Avenue, Griffith, Indiana 46319 (219) 972-6000 Attorney at Law

6-30-93