

93042900

WARRANTY DEED

This indenture witnesseth, That HAROLD DALE MULHOLLAND and NORMA E. MULHOLLAND, of Lake County, and State of Indiana.

Convey and Warrant

TO: EDWIN L. HAYS and BRENDA K. HAYS; husband and wife, of Lake County, in the State of Indiana for the sum of Ten Dollars (\$10.00) and Other Good and Valuable Consideration, the following described Real Estate in Lake County, in the State of Indiana, to-wit:

Lot 35, Glen Wood Addition to Hobart, Unit No. 1, as shown in Plat Book 38, page 44, in Lake County, Indiana.
Commonly Known As: 1431 Mississippi Place, Hobart, IN 46342

Subject to covenants and restrictions, easements for streets and utilities, and building lines, as contained in plat of subdivision and as contained in all other documents of record; and taxes for 1992.

In witness whereof, the said HAROLD DALE MULHOLLAND and NORMA E. MULHOLLAND have hereunto set their hands and seals this 25th day of June, 1993.

Harold Dale Mulholland
HAROLD DALE MULHOLLAND

Norma E. Mulholland
NORMA E. MULHOLLAND

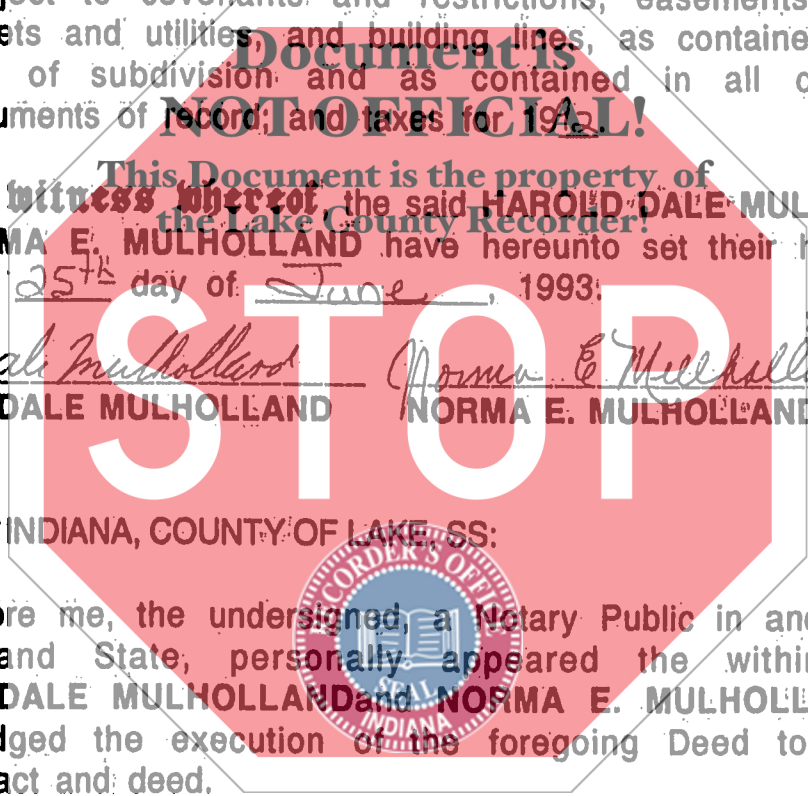

JUN 30 3 59 PM '93
SAMUEL ORLICH
RECORDER

STATE OF INDIANA/S.S.NO.
LAKE COUNTY
FILED FOR RECORD

STATE OF INDIANA, COUNTY OF LAKE, SS:

Before me, the undersigned, a Notary Public in and for said County and State, personally appeared the within named HAROLD DALE MULHOLLAND and NORMA E. MULHOLLAND who acknowledged the execution of the foregoing Deed to be their voluntary act and deed.

Witness, my hand and Official Seal this 25th day of June, 1993.

Stacy Eisenhutt
Notary Public (signature)

Stacy Eisenhutt
Notary Public (typed or printed)

DULY ENTERED FOR TAXATION SUBJECT TO:
FINAL ACCEPTANCE FOR TRANSFER.

JUN 30 1993

Clara M. Carter
AUDITOR LAKE COUNTY

My Commission Expires: January 7, 1994
County of Residence of Notary Public: Lake

This instrument prepared by John R. Sorbello, attorney at law.

J.R.S.

02:00
700
G