

TODD GORE
6416 ROBBINS
PORTAGE

THIS FORM HAS BEEN APPROVED BY THE INDIANA STATE BAR ASSOCIATION FOR USE BY LAWYERS ONLY. THE SELECTION OF A FORM OF INSTRUMENT, FILLING IN BLANK SPACES, STRIKING OUT PROVISIONS AND INSERTION OF SPECIAL CLAUSES, CONSTITUTES THE PRACTICE OF LAW AND MAY ONLY BE DONE BY A LAWYER.

Mail tax bills to 92042883

Tax Key No. 19-98-1

6416 ROBBINS
PORTAGE, IN 46368

WARRANTY DEED

This indenture witnesseth that

SHARLENE ANDERSON AKA Sharlene J. Anderson.

of LAKE County in the State of INDIANA

Convey and warrant to

R. TODD GORE, AND JANET L. GORE AND

ERNEST R. MITCHELL, AND JOYCE M. MITCHELL
County in the State of INDIANA

of PORTER for and in consideration of TEN DOLLARS (\$10.00) the receipt whereof is hereby acknowledged, the following Real Estate in the State of Indiana, to wit:

County

LOTS 1, 2, 3 AND 4 IN BLOCK 6 IN FOURTH SUBDIVISION TO EAST GARY, AS PER PLAT THEREOF, RECORDED IN PLAT BOOK 13 PAGE 27, IN THE OFFICE OF THE RECORDER OF LAKE COUNTY, INDIANA.

176100-93-69

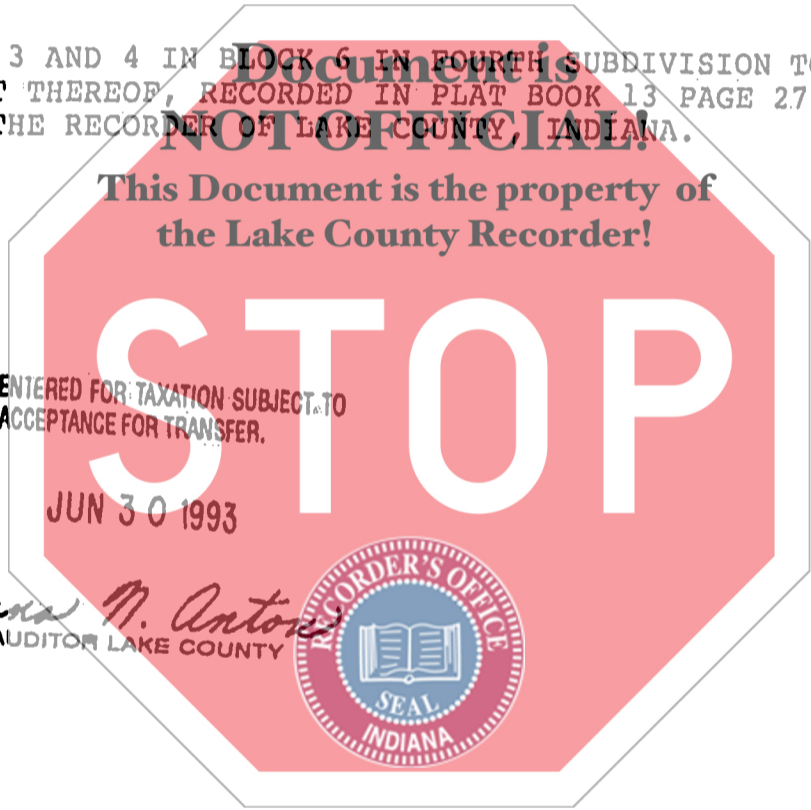

SAHUEL ORLICH
RECORDER
JUN 30 3 48 PM '93

STATE OF INDIANA RECORDER TITLE INSURANCE
LAKE COUNTY
FILED FOR RECORD Crown Point, Indiana

State of Indiana, County, ss:
Before me, the undersigned, a Notary Public in and for said County and State, this 23rd day of March 1993 personally appeared:
Sharlene Anderson
AKA Sharlene J. Anderson

Dated this 19 Day of MARCH 1993

Sharlene Anderson

SHARLENE ANDERSON

AKA Sharlene J. Anderson

And acknowledged the execution of the foregoing deed. In witness whereof, I have hereunto subscribed my name and affixed my official seal. My commission expires 5-11-1997

Gracy H Badtke
Notary Public

Resident of Porter County.

This instrument prepared by Janet L. Gore Attorney at Law