

THIS FORM HAS BEEN APPROVED BY THE INDIANA STATE BAR ASSOCIATION FOR USE BY LAWYERS ONLY. THE SELECTION OF A FORM OF INSTRUMENT; FILLING IN BLANK SPACES, STRIKING OUT PROVISIONS AND INSERTION OF SPECIAL CLAUSES, CONSTITUTES THE PRACTICE OF LAW AND MAY ONLY BE DONE BY A LAWYER.

Mall tax bills to: 93042766

Tax Key No.: 14-163-27

2600 South Hickory
Dyer, Indiana

WARRANTY DEED

This indenture witnesseth that Robert Tiberi & Patricia M. Tiberi, his Wife,
as tenants by the entirety

of Lake County in the State of Indiana

Convey and warrant to Timothy J. Salach & Rebecca L. Salach,
Husband & Wife

of Lake County in the State of Indiana
for and in consideration of \$10.00 & other good & valuable consideration
the receipt whereof is hereby acknowledged, the following Real Estate in
in the State of Indiana, to wit:

SAMUEL ORLICH
RECORDER

JUN 30 3 32 PM '93

STATE OF INDIANA/S.S.NO.
LAKE COUNTY
FILED FOR RECORD

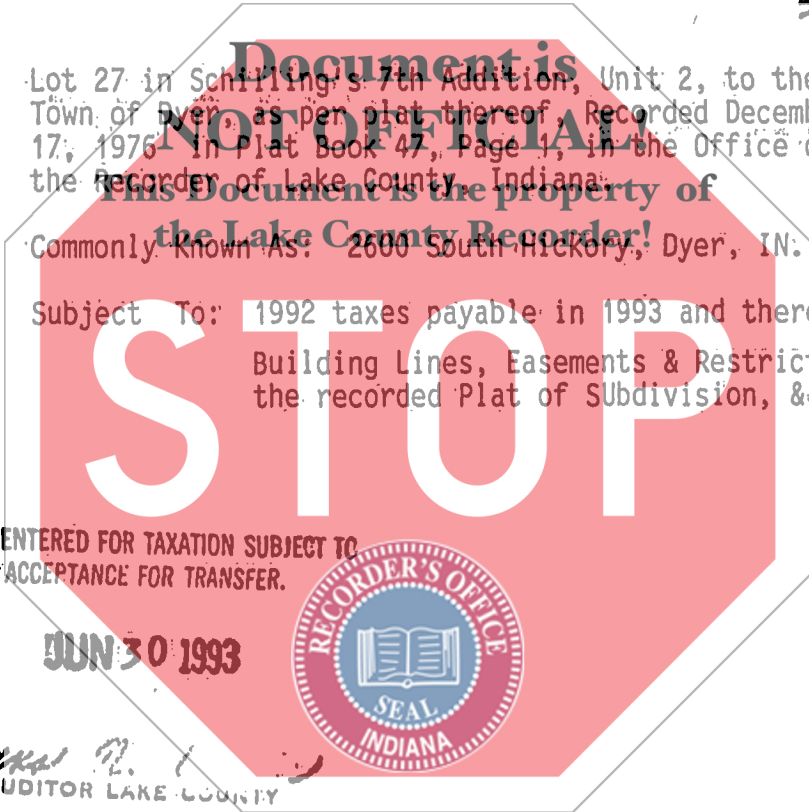

State of Indiana, Lake County, ss:

Before me, the undersigned, a Notary Public in and for said County and State, this 29th day of June 1993 personally appeared:

Robert Tiberi & Patricia M. Tiberi,
Husband & Wife

Dated this 29th Day of June 19 93

Robert Tiberi

Patricia M. Tiberi

Patricia M. Tiberi

And acknowledged the execution of the foregoing deed. In witness whereof, I have hereunto subscribed my name and affixed my official seal. My commission expires 6-30-96 1996

Timothy J. Salach
Timothy J. Salach, Notary Public
Resident of Lake County.

Tom

02144

This instrument prepared by PATRICK MCMANAMA, CROWN POINT, IN. Attorney at Law