

THIS FORM HAS BEEN PREPARED FOR USE WITHIN THE STATE OF INDIANA. THE SELECTION OF A FORM OF INSTRUMENT, FILLING IN BLANK SPACES, STRIKING OUT PROVISIONS, AND INSERTION OF SPECIAL CLAUSES, MAY CONSTITUTE THE PRACTICE OF LAW AND SHOULD ONLY BE DONE BY A LAWYER.

Mail tax bills to:  
3020 GLENWOOD  
HIGHLAND, IN 46322

Tax Key No.: 16-27263-33

# WARRANTY DEED

This indenture witnesseth that **TIMOTHY W. MURPHY AND GINGER G. MURPHY, HUSBAND AND WIFE**

of **LAKE** County in the State of **INDIANA**.

Convey and warrant to **WILLIAM E. COCHRAN**

of **LAKE** County in the State of **INDIANA**.

for and in consideration of **TEN DOLLARS (\$10.00) AND OTHER GOOD AND VALUABLE CONSIDERATION** the receipt whereof is hereby acknowledged, the following Real Estate in **LAKE** in the State of Indiana, to wit:

THE REAL ESTATE AND PREMISES COMMONLY KNOWN AS 3020 GLENWOOD, IN THE TOWN OF HIGHLAND, COUNTY OF LAKE, STATE OF INDIANA, AND MORE PARTICULARLY DESCRIBED AS FOLLOWS; TO-WIT:

LOT 33 IN BLOCK 4 IN THE HOMESTEAD GARDENS MASTER ADDITION, IN THE TOWN OF HIGHLAND, AS PER PLAT THEREOF, RECORDED IN PLAT BOOK 31 PAGE 79, IN THE OFFICE OF THE RECORDER OF LAKE COUNTY, INDIANA.

SUBJECT TO REAL ESTATE TAXES FOR 1992 PAYABLE IN 1993, TOGETHER WITH DELINQUENCY AND PENALTY, IF ANY, AND ALL REAL ESTATE TAXES DUE AND PAYABLE THEREAFTER.

SUBJECT TO RECORDED LIENS, ENCUMBRANCES, EASEMENTS, RESTRICTIONS, DITCHES AND DRAINS, HIGHWAYS AND LEGAL RIGHTS OF WAY, AND MATTERS WHICH WOULD BE DISCLOSED BY AN ACCURATE SURVEY OR INSPECTION OF THE PREMISES.

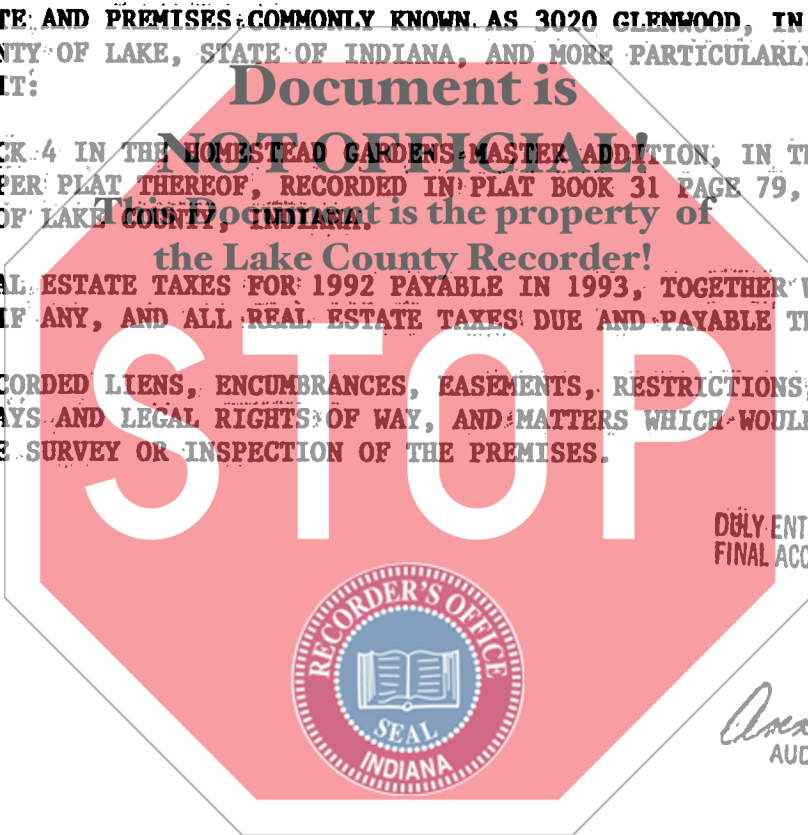

STATE OF INDIANA, S.S. NO. LAKE COUNTY FILED FOR RECORD  
JUN 30 4 09 PM '93  
SAMUEL H. ORLICH  
RECORDER

DULY ENTERED FOR TAXATION SUBJECT TO FINAL ACCEPTANCE FOR TRANSFER

JUN 29 1993

*Anne M. Anton*  
AUDITOR LAKE COUNTY

State of Indiana, **LAKE** County, ss:  
Before me, the undersigned, a Notary Public in and for said County and State, this **14TH** day of **JUNE** 19 **93** personally appeared:  
**TIMOTHY W. MURPHY AND GINGER G. MURPHY,**  
HUSBAND AND WIFE

Dated this **14TH** Day of **JUNE** 19**93**

*Timothy W. Murphy*  
TIMOTHY W. MURPHY

*Ginger G. Murphy*  
GINGER G. MURPHY

And acknowledged the execution of the foregoing deed. In witness whereof, I have hereunto subscribed my name and affixed my official seal. My commission expires **12-3** 19 **93**

*Jean Henderson*  
JEAN HENDERSON Notary Public

Resident of **LAKE** County.

1169

This instrument prepared by **THOMAS K. HOFFMAN, ONE PROFESSIONAL CENTER, CROWN POINT, IN 46307**, at *Lake*