

THIS FORM HAS BEEN PREPARED FOR USE WITHIN THE STATE OF INDIANA. THE SELECTION OF A FORM OF INSTRUMENT, FILLING IN BLANK SPACES, STRIKING OUT PROVISIONS, AND INSERTION OF SPECIAL CLAUSES, MAY CONSTITUTE THE PRACTICE OF LAW AND SHOULD ONLY BE DONE BY A LAWYER.

*Citizens Fund  
707 Ridge Street  
Hammond, IN*

93041273

Tax Key No.: 35-66-9

Mail tax bills to:

# WARRANTY DEED

Thomas H. & Diana K. Jacobson  
2512 - 171st  
Hammond, IN 46323

This indenture witnesseth that JAMES A. PAYNE, JR. and DIANA S. PAYNE,  
his wife

of LAKE County in the State of INDIANA

Convey and warrant to THOMAS H. JACOBSON and DIANA K. JACOBSON,  
husband and wife,

of LAKE County in the State of INDIANA

for and in consideration of TEN DOLLARS and other good and valuable consideration  
the receipt whereof is hereby acknowledged, the following Real Estate in Lake County  
in the State of Indiana, to wit:

Lot 5, except the North 50 feet thereof, in Block 2 in Meadow Grove Addition to Hammond, as per plat thereof recorded in Plat Book 13 page 8, in the Office of the Recorder of Lake County, Indiana.

(Commonly known as 6626 Meadow Lane, Hammond, Indiana 46324)

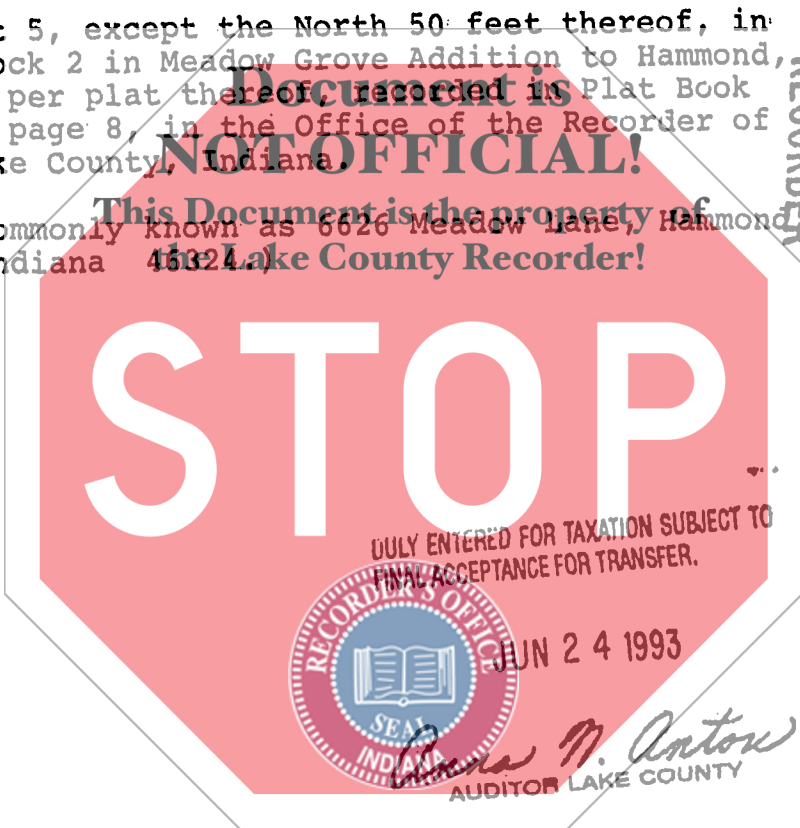

STATE OF INDIANA, S.S. NO. LAKE COUNTY FILED FOR RECORD  
JUN 28 10 52 AM '93  
SAMUEL KRILICH  
RECORDER

TICOR TITLE INSURANCE

State of Indiana, Lake County, ss: Dated this 15th Day of June 1993

Before me, the undersigned, a Notary Public in and for said County and State, this 15th day of June, 1993 personally appeared:

JAMES A. PAYNE, JR. and DIANA S. PAYNE, his wife

*James A. Payne, Jr.*  
JAMES A. PAYNE, JR.  
*Diana S. Payne*  
DIANA S. PAYNE

And acknowledged the execution of the foregoing deed. In witness whereof, I have hereunto subscribed my name and affixed my official seal. My commission expires 10/31 1993

*Judith G. Jones*  
Notary Public

Resident of LAKE County.

This instrument prepared by JOHN E. CHEVIGNY, GALVIN, GALVIN & LEENEY, 5231 Hohman Avenue, Hammond, IN 46320 Attorney at Law

MAIL TO:

177363

01256  
700  
6-18-93  
fi