

MAIL TAX BILLS TO:
3235 Glenwood Ave.
Hghd., IN. 46322

TAX KEY NO. 27-280-8

93039754

QUIT-CLAIM DEED

This indenture witnesseth that **NANCY L. MICHALEC**, a divorced woman,
of Lake County in the State of Indiana

Releases and quit claims to **STEVEN J. MICHALEC**, a divorced man,
Stephen

of Lake County in the State of Indiana
for and in consideration of Ten Dollars (\$10.00) and other good and valuable consideration
the receipt whereof is hereby acknowledged, the following Real Estate in Lake County
in the State of Indiana, to wit:

222-0-07

Lot 8 in Block 10 in Homestead Gardens Master Addition, in the Town of Highland, as
per plat thereof, recorded in Plat Book 32 page 46, in the Office of the Recorder of
Lake County, Indiana.

Commonly known as 3235 Glenwood Avenue, Highland, Indiana 46322.
the Lake County Recorder!

Subject To: all unpaid real estate taxes and assessments for 1992 payable in 1993,
and for all real estate taxes and assessments for all subsequent years.

Subject To: all easements, conditions, restrictions, covenants, limitations and building
setback lines contained in prior instruments of record, and for all building and zoning
ordinances.

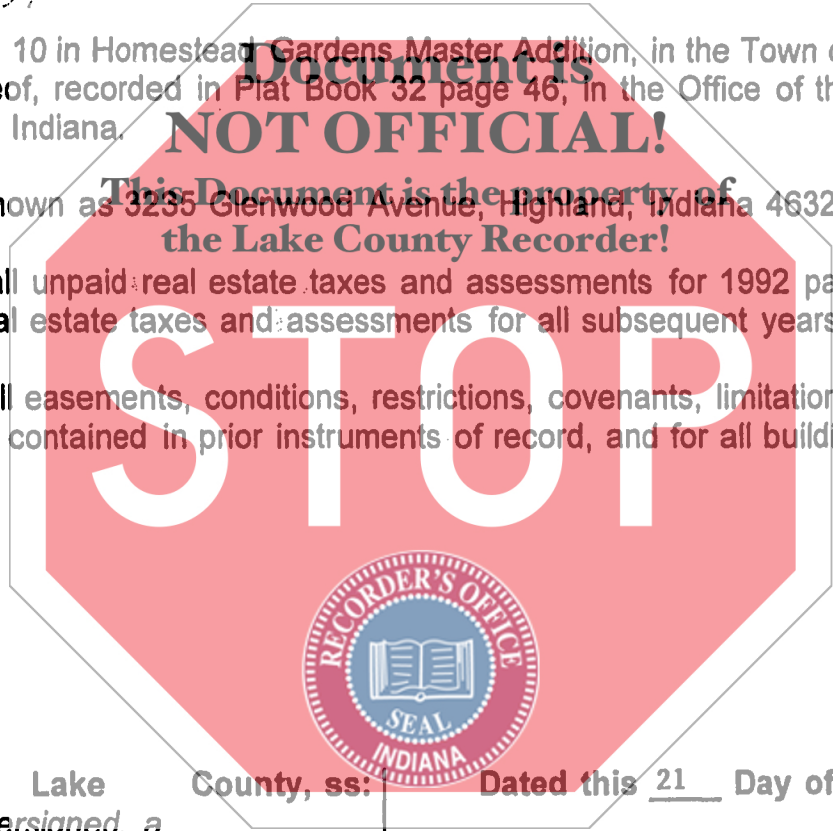

STATE OF INDIANA / S.M. NO.
LAKE COUNTY
RECORDER
JUN 17 10 49 AM '93
SAMUEL ORLICH

State of Indiana, Lake County, ss: Dated this 21 Day of MAY 1993

Before me, the undersigned, a
Notary Public in and for said
County and State, this 21
day of MAY, 19 93
personally appeared:

NANCY L. MICHALEC

Nancy L. Michalec
NANCY L. MICHALEC

And acknowledged the execution of the
foregoing deed. In witness whereof, I
have hereunto subscribed my name and
affixed my official seal.
My commission expires: JUNE 7, 1996

DULY ENTERED FOR TAXATION SUBJECT TO
FINAL ACCEPTANCE FOR TRANSFER.

JUN 17 1993
Anna M. Antos
AUDITOR LAKE COUNTY

Thomas G. Schiller
Notary Public
THOMAS G. SCHILLER

Resident of LAKE County

This instrument prepared by: Rhett L. Tauber, Esq./Anderson, Tauber & Woodward, P.C.
8935 Broadway, Merrillville, IN 46410
Phone: 219/769-1892

1149 700
6-4-93