

Return To: Henry S. Kowalczyk 5246 Hohman Ave. Hammond, IN 46320

THIS FORM HAS BEEN PREPARED FOR USE WITHIN THE STATE OF INDIANA. THE SELECTION OF A FORM OF INSTRUMENT, FILLING IN BLANK SPACES, STRIKING OUT PROVISIONS, AND INSERTION OF SPECIAL CLAUSES, MAY CONSTITUTE THE PRACTICE OF LAW AND SHOULD ONLY BE DONE BY A LAWYER.

MAIL TAX BILLS TO: Stella C. Filas, 4318 Towle Ave. Hammond, Indiana TAX KEY NO: 32-20-6

QUIT-CLAIM DEED

93034054

This indenture witnesseth that STELLA C. FILAS, a widow

of Lake County in the State of Indiana

Releases and quit claims to STELLA C. FILAS AND EUGENE J. FILAS, of Cook County, Illinois, but reserving unto herself, the said Stella C. Filas, a life estate.

of County in the State of Indiana
for and in consideration of Ten Dollars (\$10.00) and other valuable consideration.
the receipt whereof is hereby acknowledged, the following Real Estate in Lake County
in the State of Indiana, to wit: in and to

T.E. Bell's Addition, South 20 Feet of Lot 7, North 20 Feet of Lot 8, Block 1.
(Commonly known as: 4318 Towle Avenue, Hammond, Indiana)
This Document is the property of the Lake County Recorder!

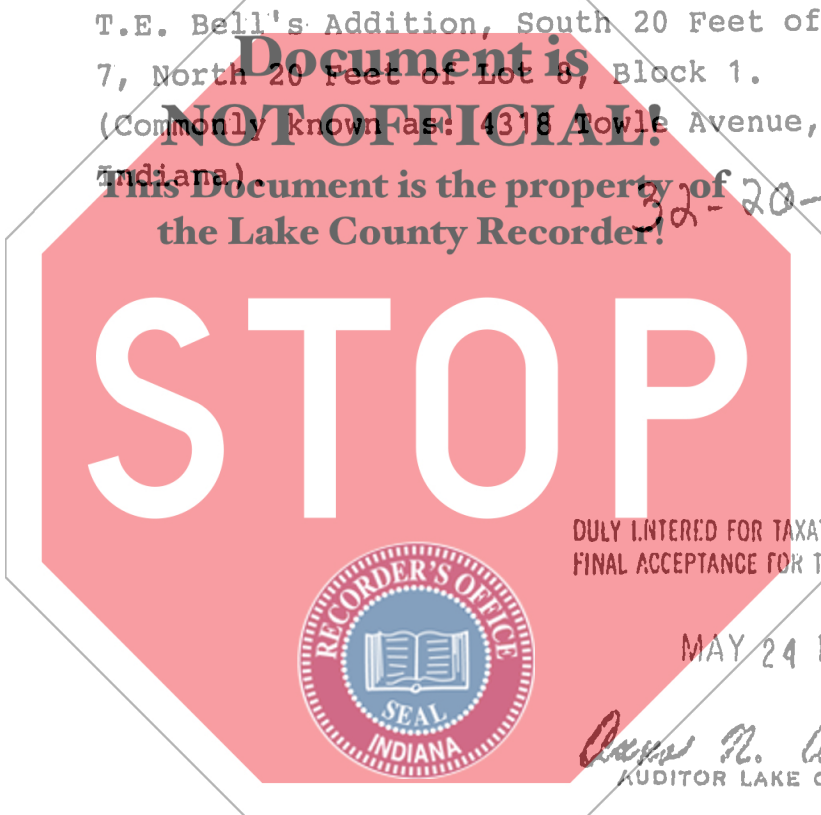

MAY 26 9 29 AM '93
SAMUEL L. MILLION
RECORDER

STATE OF INDIANA
LAKE COUNTY
FILED FOR RECORD

DULY ENTERED FOR TAXATION SUBJECT TO FINAL ACCEPTANCE FOR TRANSFER.

MAY 24 1993

Ray N. Antox
AUDITOR LAKE COUNTY

State of Indiana, Lake County, ss:
Before me, the undersigned, a Notary Public in and for said County and State, this 11th day of May 19 93 personally appeared:

Stella C. Filas, a widow

Dated this 11th Day of May 19 93

Stella C. Filas
Stella C. Filas

And acknowledged the execution of the foregoing deed. In witness whereof, I have hereunto subscribed my name and affixed my official seal. My commission expires July 23, 19 94

Henry S. Kowalczyk
NOTARY PUBLIC
Henry S. Kowalczyk, Notary Public

Resident of Lake County

00947

This instrument prepared by Henry S. Kowalczyk #5322-45-5246 Hohman Ave., Attorney at Law Hammond, Indiana 46320

MAIL TO:

700