

Tior Title Ho

THIS FORM HAS BEEN APPROVED BY THE INDIANA STATE BAR ASSOCIATION FOR USE BY LAWYERS ONLY. THE SELECTION OF A FORM OF INSTRUMENT, FILLING IN BLANK SPACES, STRIKING OUT PROVISIONS AND INSERTION OF SPECIAL CLAUSES, CONSTITUTES THE PRACTICE OF LAW AND MAY ONLY BE DONE BY A LAWYER.

Mail tax bills to:
8742 Prairie Avenue
Highland, IN 46322
93033521

WARRANTY DEED

Tax Key No.: 27-51-5

This indenture witnesseth that: **TERENCE P. GJELDUM** and **KATHRYN M. GJELDUM**,
husband and wife,

of Lake County in the State of Indiana

Convey and warrant to **MAURICE T. KLEFEKER** and **AMY F. KLEFEKER**
husband and wife,

STATE OF INDIANA/S.S.NO.
LAKE COUNTY
FILED FOR RECORD
MAY 24 11 02 AM '93
SAMUEL GREICH
RECORDER

of Lake County in the State of Indiana
for and in consideration of Ten Dollars and other good and valuable consideration
the receipt whereof is hereby acknowledged, the following Real Estate in Lake County
in the State of Indiana, to wit:

892971 / 176368

Lot 5 in Block 4 in Brantwood Second Addition to the Town of Highland, as per plat thereof recorded in Plat Book 21, page 29, in the Office of the Recorder of Lake County, Indiana. Commonly known as: 8742 Prairie Avenue, Highland, IN 46322. Subject to taxes for the year 1993 payable 1994 and subsequent years. Subject also to conditions, covenants, easements and restrictions of record.

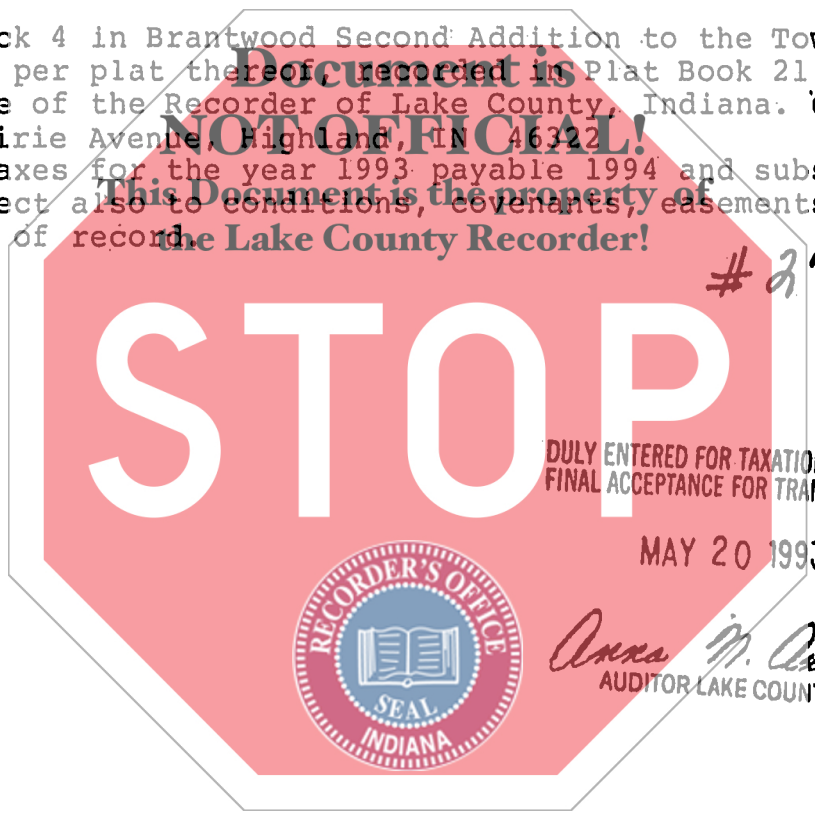

State of Indiana, Lake County, ss:
Before me, the undersigned, a Notary Public in and for said County and State, this 5th day of May 19 93 personally appeared:

Terence P. Gjeldum and Kathryn M. Gjeldum, husband and wife

Dated: this 5th Day of May 1993

x Terence P. Gjeldum Seal

x Kathryn M. Gjeldum Seal
Kathryn M. Gjeldum

And acknowledged the execution of the foregoing deed. In witness whereof, I have hereunto subscribed my name and affixed my official seal. My commission expires 10-17 1994

Linda S. Wood
LINDA S. WOOD
Notary Public

Resident of Lake County.

This instrument prepared by JOHN A. DeMATO & ASSOCIATES, P.C. Attorney at Law
5625 Hohman Avenue, Hammond, IN 46320

00588

700
5-10-93