

93019338

GRANT OF EASEMENT

3
Know All Men By These Presents, that the undersigned, Margaret L. Orange, (hereinafter "Grantor"), for consideration of Two Thousand Five Hundred (\$2,500.00) Dollars paid by Lake County Association for the Retarded, Inc., (hereinafter "Grantee"), receipt of which is hereby acknowledged, has granted, sold and conveyed and by these presents does grant, sell and convey unto Grantee an easement in the West 5 feet of Grantee's property and the right to construct and maintain an underground sanitary sewer and water line from the public sewer and water line to the Grantee's building located at 2414 Woodlane Drive, Merrillville, Lake County, Indiana, in said easement, which property of the Grantor is more particularly described as follows:

That part of the SE1/4 of the NW1/4 of the NE1/4 of the SW1/4 of Section 8, Township 35 North, Range 8 West of the 2nd P.M., described as follows: Beginning at a point 561.5 feet West of and 30.5 feet North of the Northeast corner of the SW1/4 of Section 8, Township 35 North, Range 8 West of the 2nd P.M.; thence due West along a line parallel to and 30.5 feet North of the North line of the SW1/4 of said Section 8, Township 35 North, Range 8 West of the 2nd P.M., a distance of 100 feet; thence due South a distance of 179 feet; thence North 84 Deg. 28' East a distance of 100.5 feet; thence due North 19 feet to the place of beginning, excepting the North 19 feet thereof used for right-of-way for public road in Lake County, Indiana.

In further consideration of this grant the Grantee shall repair and maintain at its cost any damages caused by the installation, maintenance or operation of said sewer and water lines and shall indemnify and hold harmless Grantor for any and all damages sustained by Grantor by reason of the negligence of the Grantee, its agents and/or employees, by reason of the installation, maintenance or operation of said sewer and water lines.

This grant of easement shall be binding upon Grantor's

Document is NOT OFFICIAL! This Document is the property of the Lake County Recorder!

FILED

MAR 29 1993

Anna N. Antreas
AUDITOR LAKE COUNTY



MAR 29 11 21 AM '93

STATE OF INDIANA
LAKE COUNTY
RECORDER OF DEEDS

1000

01552

successors in interest, heirs, administrators and assigns.

Margaret L. Orange
MARGARET L. ORANGE

STATE OF INDIANA)
) SS:
COUNTY OF LAKE)

SUBSCRIBED and SWORN to, before me, Wendy L. Lee
a Notary Public, this 11th day of March, 1993.

**Document is the property of
the Lake County Recorder!**

Wendy L. Lee
NOTARY PUBLIC

My Commission expires:
05-24-93
County of Residence:
Lake



This instrument prepared by: William H. Walden
Attorney at Law
8242 Calumet Avenue, Suite B
Munster, IN 46321

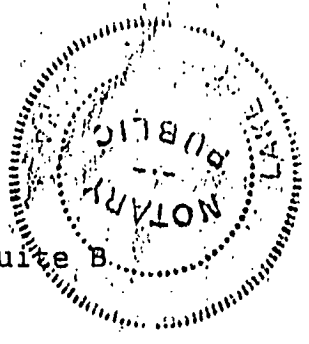

KRULL & SON CIVIL ENGINEERS AND SURVEYORS

LAKE COUNTY, INDIANA

WILLIAM J. KRULL
REGISTERED ENGINEER NO. 215

315 CENTER STREET
HOHART, INDIANA
OFFICE PHONE: 047-2508

ROBERT A. KRULL
REG. LAND SURVEYOR NO. 10516
REGISTERED ENGINEER NO. 3892

PLAT OF SURVEY

NAME OF OWNER Margaret L. Orange

STREET ADDRESS 2505 West 65th Avenue, Merrillville, Indiana

DESCRIPTION OF PROPERTY That part of the SW $\frac{1}{4}$ of the NW $\frac{1}{4}$ of the NE $\frac{1}{4}$ of the SW $\frac{1}{4}$ of Section 8, Township 35 North, Range 8 West of the 2nd P.M., described as follows: Beginning at a point 561.5 feet West of and 30.5 feet North of the Northeast corner of the SW $\frac{1}{4}$ of Section 8, Town 35 North, Range 8 West of the 2nd P.M.; thence due West along a line parallel to and 30.5 feet North of the North line of the SW $\frac{1}{4}$ of said Section 8, Township 35 North, Range 8 West of the 2nd P.M., a distance of 100 feet; thence due South a distance of 179 feet; thence North $84^{\circ}17'20''$ East a distance of 100.5 feet; thence due North 169 feet to the place of beginning, excepting the North 19 feet thereof used for right-of-way for public road in Lake County, Indiana.

NOTE: According to FIRM Community-Panel #180138-0005-B, dated October 15, 1981, the above described parcel is in Zone "C".

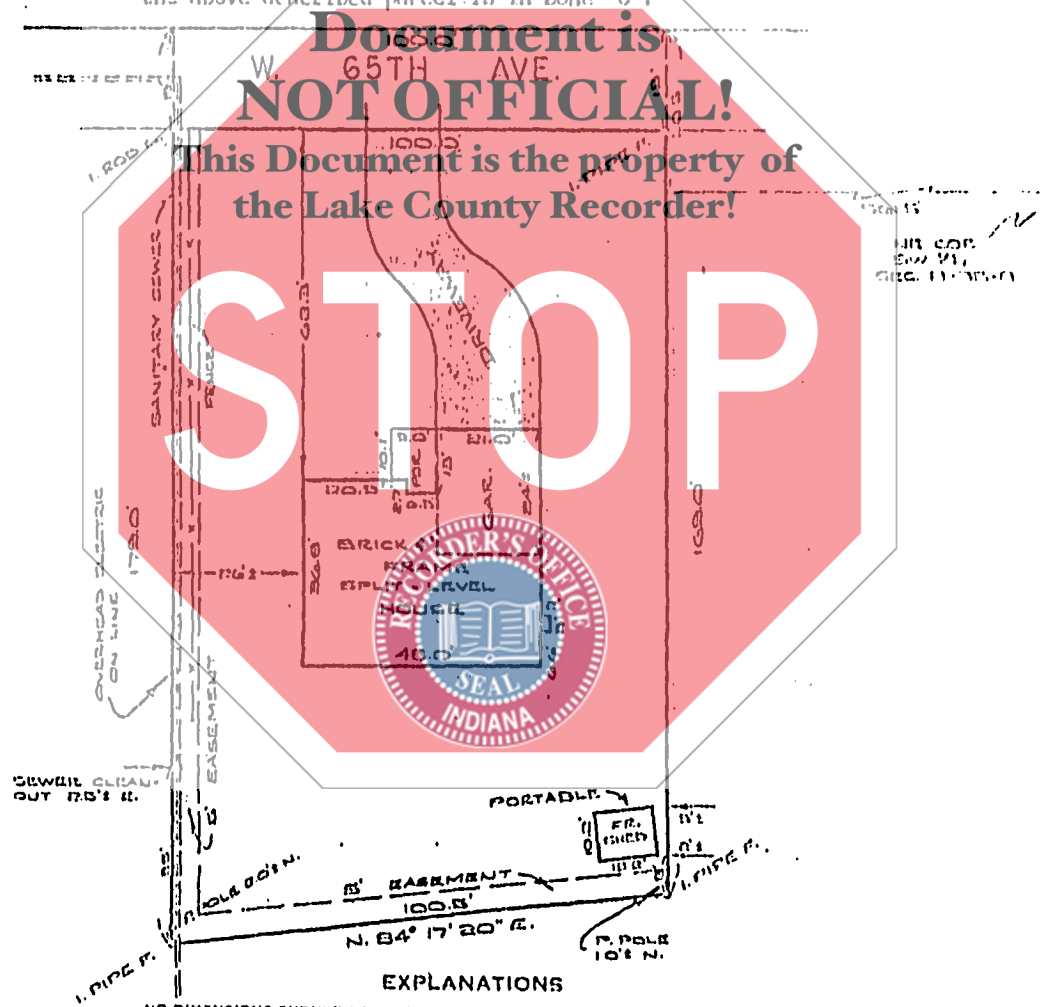

EXPLANATIONS

NO DIMENSIONS SHOULD BE ASSUMED BY SC. MEASUREMENTS UPON THE PLAT

TOP OF PLAT IS NORTH
SCALE 30 FT. = 1"

STATE OF INDIANA
COUNTY OF LAKE

HOHART, IND. September 3 1992

THIS IS TO CERTIFY THAT I HAVE SURVEYED THE ABOVE DESCRIBED PROPERTY ACCORDING TO THE OFFICIAL RECORDS AND THAT THE PLAT HERON DRAWN CORRECTLY REPRESENTS SAID SURVEY.

Robert A. Krull
Robert A. Krull, Reg. Land Surveyor #10516

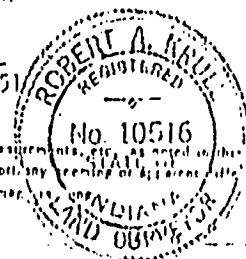

NOTE - Contractors or builders should be notified to carefully test and compare on the ground the points, measurements, etc., as noted on this plat, with the stakes, points, etc., given on the property, before building on the same, and AT THE E report any seeming or actual discrepancy between the same to the Surveyor, that misunderstanding displacement of points, etc., may be corrected before damage.

PT. SW. 1/4, SEC. 13-35-8
FIELD BOOK NO. _____ PAGE _____
ORDERED BY Atty. Walden