

93019333

Mail Tax Bills To:
3381 Anthony Dr.
Hobart, IN 46342

Key No. 18-60-24

PERSONAL REPRESENTATIVE'S DEED

PAMELA J. LEVAN is the Personal Representative of the Estate of Elaine S. Fritz, deceased. This estate is pending as Cause Number 45CO1-9203-EU-080 in Lake County, Indiana. The Personal Representative, by virtue of the power given a Personal Representative under Indiana law, for good and sufficient consideration, conveys to PAMELA J. LEVAN and VICTOR R. LEVAN, husband and wife, as tenants by the entireties, the following described real estate:

Lot 22 and the South 5.92 feet of Lot 23, Joryville Addition to the City of Hobart, Lake County, Indiana.

Commonly known as 813 1/2 Lincoln Street, Hobart, Indiana 46342.

Subject to real estate taxes and assessments for 1992 due and payable in 1993, and for all real estate taxes and assessments for all subsequent years.

Subject to all easements, conditions, restrictions, covenants, limitations and building setback lines contained in prior instruments of record, and all building and zoning ordinances.

IN WITNESS WHEREOF, PAMELA J. LEVAN, Personal Representative of the Estate of Elaine S. Fritz, deceased, has hereunto set her hand and seal this 24th day of March, 1993.

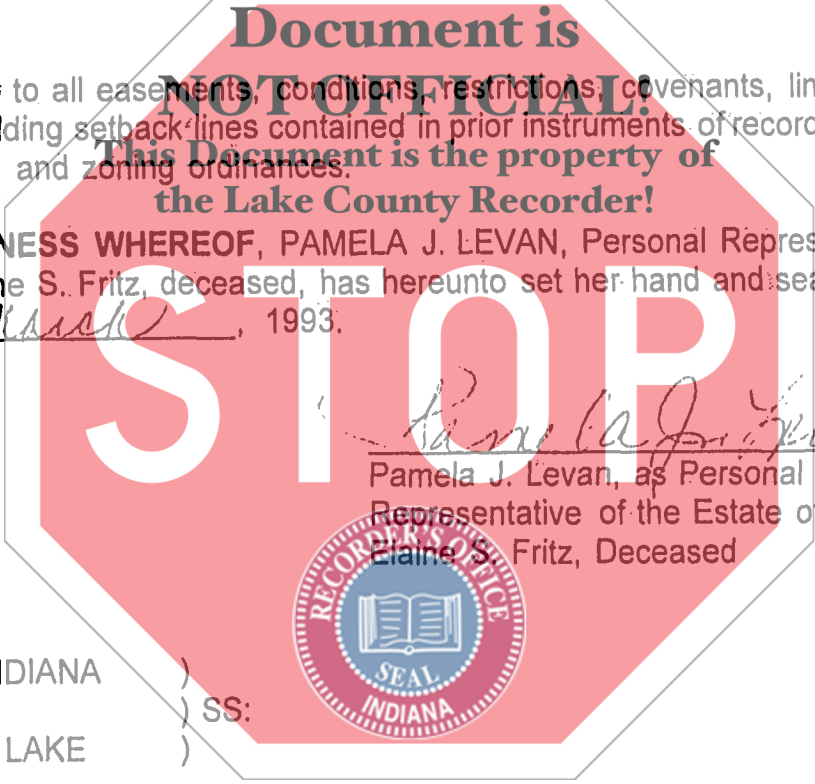

Pamela J. Levan
Pamela J. Levan, as Personal Representative of the Estate of Elaine S. Fritz, Deceased

STATE OF INDIANA
FILED
MAR 24 3 11 PM '93
RECORDED

STATE OF INDIANA)
) SS:
COUNTY OF LAKE)

Subscribed and sworn to before me, a Notary Public in and for said County and States this 24th day of March, 1993.

Denise Kessler
Denise Kessler, Notary Public

My Commission Expires: 06/25/94

County of Residence: Lake

This instrument prepared by: Richard E. Anderson
8935 Broadway
Merrillville, IN 46410

MAR 29 1993

01513

700