

MAIL TAX BILLS TO:
8215 W. 159th Ave.
Lowell, IN 46356.

FILE NO. LV 5689
EXECUTOR'S DEED
93018354

KEY NO. 1-58-29
UNIT NO. 10

KRISTINA BREWER now known as KRISTINA GOLUMBECK, as personal representative of the estate of CHARLINE GOLUMBECK, deceased, which estate is under the supervision of the Lake Superior Court of Lake County, under Cause Number: 45DO2-9108-ES-197, in the Office of the Clerk of the Lake Superior Court of Lake County, Indiana, pursuant to an order of the Lake Superior Court of Lake County, Indiana, dated on the 16th day of August, 1991, for good and sufficient consideration, conveys to: SCOTT VICTOR HEMBROFF and BARBARA GAIL HEMBROFF, the following described real estate in LAKE County, State of Indiana, to-wit:

That part of the SE1/4 of the NE1/4 of Sec. 10, Twp. 33N, R. 9 W. of 2nd P.M., more particularly described as follows: Commencing at a point on the N. line of said SE1/4 of the NE1/4, 491.65 feet W. of the NE corner of said SE1/4 of the NE1/4, being the NW corner of land conveyed to Myrtle M. Meyers by deed dated Feb. 13, 1942, and recorded Feb. 17, 1942 in Deed Record 649, page 261, thence S. on the W. line of said Myrtle M. Meyers' land, a distance of 1329.04 feet to S. line of said 1/41/4 Sec., thence W. of said S. line a distance of 420.57 feet, more or less, to the SE corner of the land conveyed to Thomas G. Braun and wife, Barbara J., by deed dated Mar. 15, 1966 and recorded Apr. 14, 1966 in Deed Record 1316 page 362, thence N. along the E. line of said Braun's land, to the SW corner of the land conveyed to Themistoklis Metevelis and wife, Thelma Mae, by deed dated April 10, 1967 and recorded April 17, 1967 in Deed Record 1343, page 493, thence E. 200 feet along the S. line of said Metevelis' land to the SE corner of said Metevelis' land, thence N. along the E. line of said Metevelis' land to the N. line of said SE1/4 of the NE1/4, thence E. along said N. line to the place of beginning in Lake County, IN.

Subject to all legal highways, right-of-way and easements;

Subject to the liens and taxes

IN WITNESS WHEREOF, the said KRISTINA GOLUMBECK, as personal representative of the estate of CHARLINE GOLUMBECK, deceased, has hereunto set her hand and seal this 29th day of January, 1993.

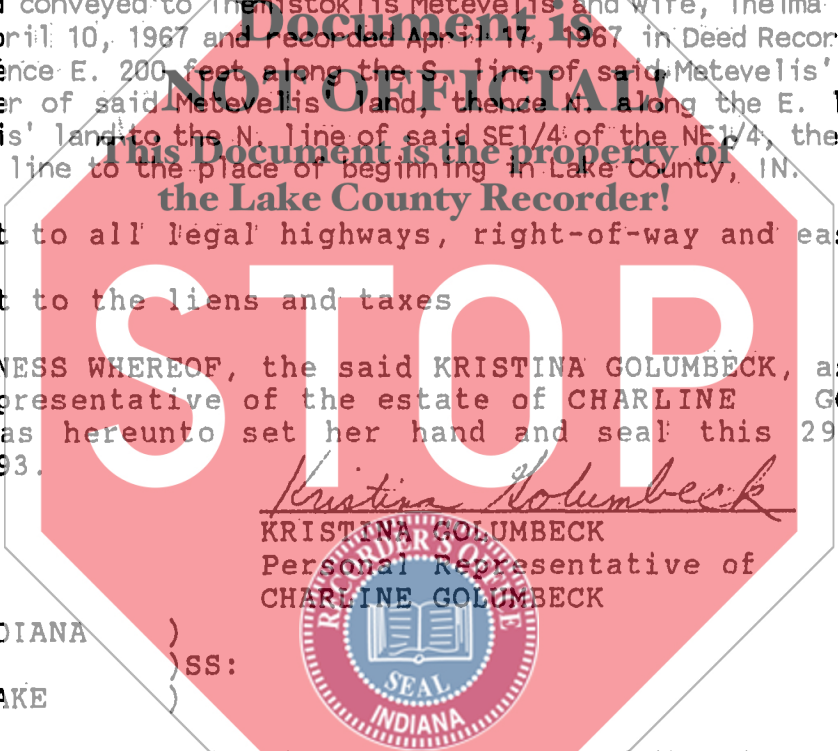

Kristina Golumbeck
KRISTINA GOLUMBECK
Personal Representative of
CHARLINE GOLUMBECK

FILED FOR REC'D
MAR 04 12 16 PM '93
SARAH J. LITCH
RECORDER

STATE OF INDIANA)
COUNTY OF LAKE) SS:

Before me, the undersigned, a Notary Public, in and for said County and State, appeared KRISTINA GOLUMBECK, as personal representative of the estate of CHARLINE GOLUMBECK, deceased, and acknowledged the execution of said deed to be her voluntary act and deed for the uses and purposes expressed therein this 29th day of January, 1993.

Lucy Harsha
LUCY HARSHA

Resident of Lake County
My Commission Expires: June 12, 1994

DULY ENTERED FOR TAXATION SUBJECT TO
FINAL ACCEPTANCE FOR TRANSFER.

EXAMINED **MAR 19 1993** APPROVED IN OPEN COURT THIS 29th DAY OF January, 1993.

Clifford E. Duggan, Jr.
AUDITOR, LAKE COUNTY

Timothy R. Sunde
JOHN O'DROBINAK, COMMISSIONER
PROBATE-ROOM TWO

Prepared by:
CLIFFORD E. DUGGAN, JR
DULL & DUGGAN
8959 Broadway
Merrillville, IN 46410

Filed in Open Court

JAN 29 1993

01003