

*Wood Ange*

# TAX TITLE DEED TO COUNTY

93016787

WHEREAS, LAKE County did, on the 18TH day of DECEMBER, 1989, produce to the undersigned, ANNA N. ANTON,

auditor of the county of LAKE, in the state of Indiana, a certificate of sale dated the 18TH day of DECEMBER, 1989, signed by ANNA N. ANTON, who,

at the date of the sale, was auditor of the county, from which it appears that said county on the 18TH day of DECEMBER, 1983, obtained, pursuant to law, the real property

described in this indenture for the sum of SEVEN THOUSAND EIGHT HUNDRED EIGHT FOUR dollars and 59/100 cents,

being the amount due on the real property for taxes, special assessments, penalties and costs for the years 1982 PAYABLE 1983 & PREVIOUS, namely:

1980 PAYABLE 1981 (ADDITIONAL AMOUNT OF TAXES ADDED TO PROPERTY

1981 PAYABLE 1982 SINCE COUNTY ACQUIRED LIEN \$20,333.67)

1982 PAYABLE 1983

Such real property has been recorded in the office of the LAKE County Auditor as

delinquent for the nonpayment of taxes, and proper notice of the sale has been given. It appearing that

LAKE County is the owner of the certificate of sale, that the time for redeeming such real property has expired, that the property has not been redeemed, that LAKE County has

demand a deed for the real property described in the certificate of sale, that the records of the LAKE

County Auditor's office state that the real property was legally liable for taxation, and that the real property has been duly assessed and properly charged on the duplicate with the taxes and

special assessments for the years 1982 PAYABLE 1983 & PREVIOUS (SEE ABOVE)

Therefore, this indenture, made this 16TH day of MARCH, 1993, between the state of Indiana, by ANNA N. ANTON, auditor of LAKE County,

of the first part, and LAKE County, of the second part, witnesseth: That the party of the first part, for and in consideration of the premises, has granted and bargained and conveyed to the party of the

second part, the real property described in the certificate of sale, situated in the county of LAKE, and state of Indiana, namely and more particularly described as follows:

UNIT 25 KEY # 43-0353-0010 801 E. RIDGE RD., GARY  
GREAT GARY REALTY CO'S 1ST ADD. ALL L.10 BL.9

**NOT-TAXABLE**

MAR 16 1993

*Anna N. Anton*  
AUDITOR LAKE COUNTY

00865

*M*

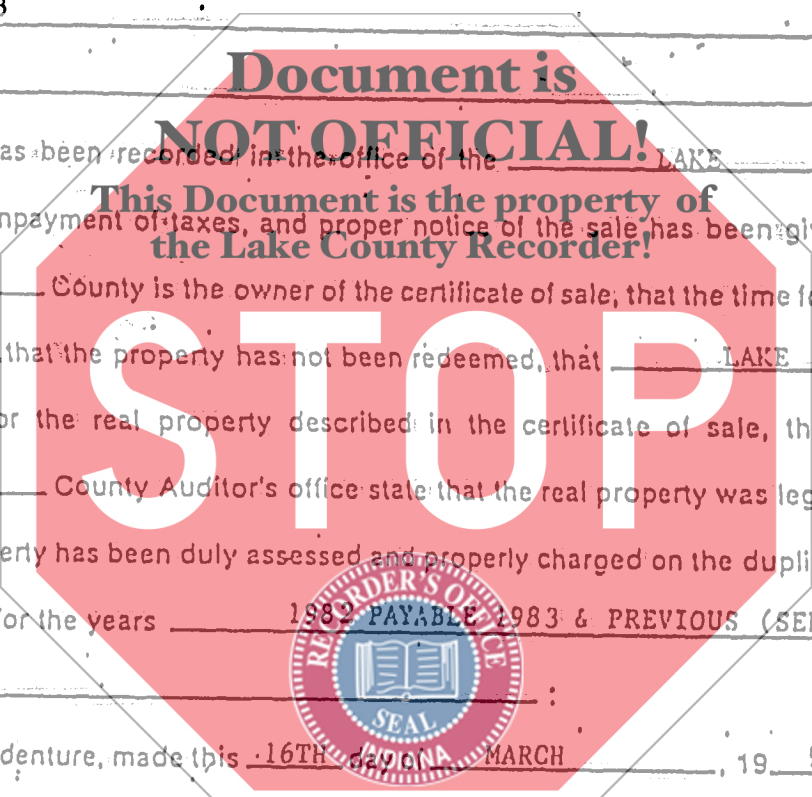

STATE OF INDIANA  
LAKE COUNTY  
RECORDER'S OFFICE  
MARCH 16 1993  
3 16 PM '93

to have and to hold such real property, with the appurtenances belonging thereto, in as full and ample a manner as the auditor of said county is empowered by law to convey the same.

In testimony, whereof, ANNA N. ANTON Auditor of LAKE County, has hereunto set his hand, and affixed the seal of the board of county commissioners, the day and year last above mentioned.

Anna N. Anton  
Auditor of LAKE County

ATTEST: Gene Helwig  
Treasurer of LAKE County

STATE OF INDIANA }  
- COUNTY OF LAKE } SS:

Before me, the undersigned, ROBERT C. ANTICH, Clerk LAKE Circuit Court, in and for said county, this day, personally came the above named ANNA N. ANTON, auditor of said County, and acknowledged that he signed and sealed the foregoing deed for the uses and purposes therein mentioned.

In witness whereof, I have hereunto set my hand and seal, this 16TH day of MARCH, 1993.

Document is the property of  
Robert C. Antich  
Circuit Court

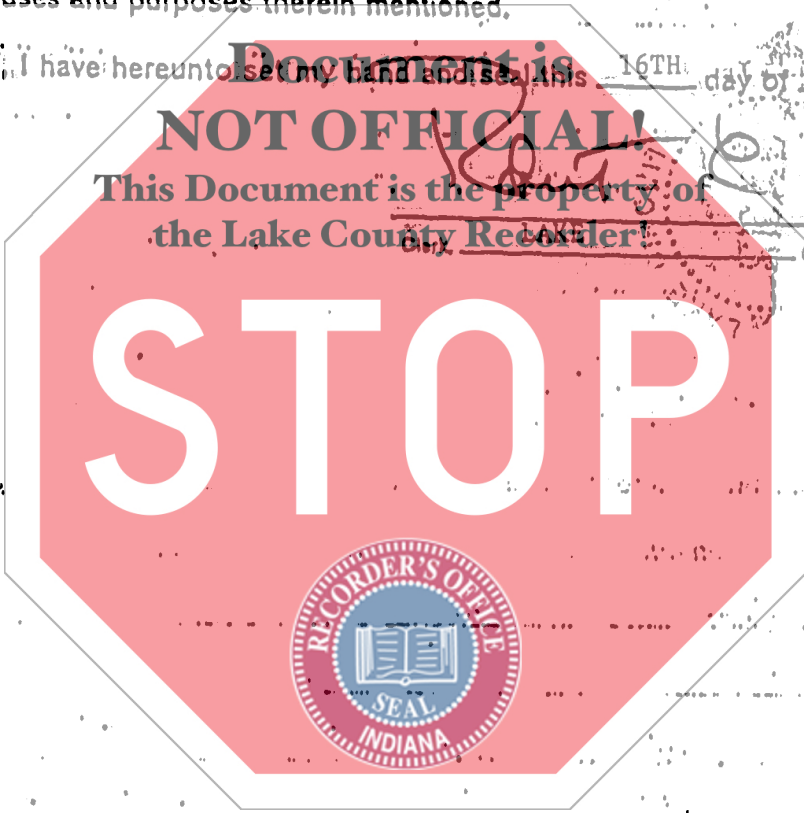

TO  
LAKE COUNTY INDIANA  
2293 N. MAIN STREET  
CROWN POINT, IN. 46307

TAX TITLE DEED  
PUBLIC SALE

Received for Record

The \_\_\_ day of \_\_\_\_\_  
A.D. 19\_\_\_, at \_\_\_ O'Clock \_\_\_ M., and recorded in

Record \_\_\_\_\_

Pages \_\_\_\_\_

Recorder of \_\_\_\_\_ County

Duly Entered for Taxation

\_\_\_\_\_ 19\_\_\_

Auditor