

P.O. Box 1076? Mon 46411

93015709 SATISFACTION OF MORTGAGE

This Certifies, That a certain Mortgage executed by Jean D. Pienta

to Lake Mortgage Co Inc

on 16th day of June 1992, calling for \$ 25,000.00 and recorded

in Mortgage Record No. Doc 9203917A, page 1, Lake County,

State of Indiana, has been fully paid and satisfied, and the same is hereby released.

WITNESS our hands and seals, this 26th day of February 1993

Susan M. Bristow
Susan M. Bristow, Secretary

By: Michael J. Howard
Michael J. Howard, Treasurer

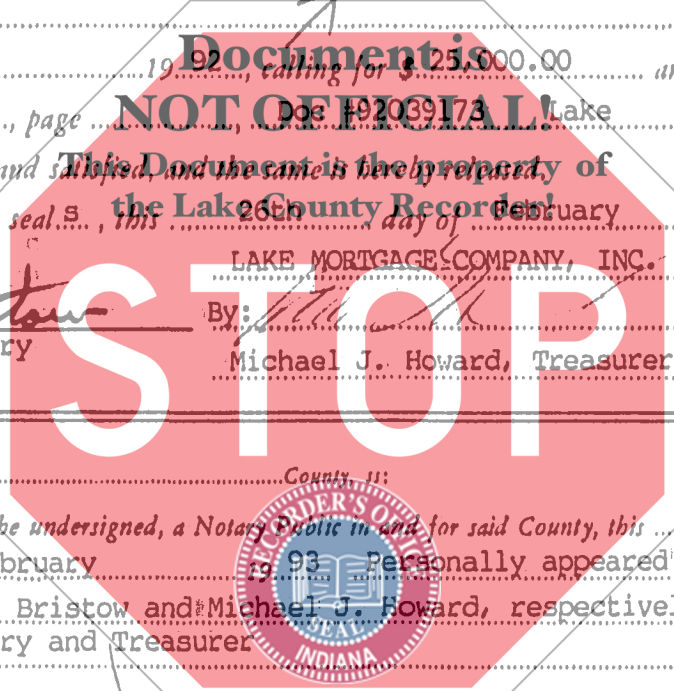

Before me, the undersigned, a Notary Public in and for said County, this 26th day of February 1993 personally appeared Susan M. Bristow and Michael J. Howard, respectively Secretary and Treasurer

acknowledged the execution of the annexed satisfaction of mortgage.

Witness my hand and official seal.
Donna S. Rust
Donna S. Rust, Notary Public.

My Commission expires 11-18-96
County of Residence: Lake
This instrument was prepared by: Deana M. Darnstaedt, Lake Mortgage Co Inc



PREPARED: Part of Tract 1 to Grant One of Rabbit Brocks, a platted
But Development in Crown Point, Indiana as shown in Plat Book 049, page
39 in the Office of the Recorder of Lake County, Indiana, which part of
said Tract 1 is described as follows: Beginning at the Northeastly
corner of said Tract 1 thence North 12° 30' East, 120 feet, along the
Northwestern line thereof, 45.00 feet thence South 54° 23' 12" East,
parallel with the Southern line of said Tract 1, 87.20 feet to a point
on the curved Southwesterly line of said Tract 1, 87.20 feet to a point
and curved Southwesterly line of a curve concave to the East and having
a radius of 68.0 feet, an arc distance of 57.93 feet to a point of
intersection with the Northern line of said Tract 1 thence North 68° 12'
58" 23" West, along the Northern line of said Tract 1, 17.04 feet thence South,
15° 23' 37" West, along the Southwesterly line of said Tract 1, 101 feet
to the point of beginning.

TRACT 9116 ORIGINAL EASEMENT (Original part of Tract 9116, Tract 1)
SECTION 16 Part of Tract 1 to Grant One of Rabbit Brocks, a platted
But Development in Crown Point, Indiana as shown in Plat Book 049, page
39 in the Office of the Recorder of Lake County, Indiana, which part of
said Tract 1 is described as follows: Commencing at the Westmost
corner of said Tract 1 thence North 53° 36' 28" East, along the
Northwestern line thereof, 45.00 feet thence South 54° 23' 12" East,
parallel with the Southern line of said Tract 1, 87.20 feet to a point
on the curved Southwesterly line of said Tract 1, 87.20 feet to the true
point of beginning thence North 48° 23' 12" West, parallel to the
Southwesterly line of said Tract 1, a distance of 50.00 feet thence North
23° 36' 28" East, a distance of 6.00 feet thence Easterly to a point on
the curved Southwesterly line of said Tract 1, 16.00 feet
Northwesterly, from the point of beginning thence Southwesterly, along
said curved Southwesterly line, on a curve concave to the East and having
a radius of 68.0 feet, an arc distance of 14.00 feet to the point of
beginning.

SUBMIT TO JIM HAYES

700