

THIS FORM HAS BEEN APPROVED BY THE INDIANA STATE BAR ASSOCIATION FOR USE BY LAWYERS ONLY. THE SELECTION OF A FORM OF INSTRUMENT, FILLING IN BLANK SPACES, STRIKING OUT PROVISIONS AND INSERTION OF SPECIAL CLAUSES, CONSTITUTES THE PRACTICE OF LAW AND MAY ONLY BE DONE BY A LAWYER.

Mall tax bills to:
9328 ORCHARD DRIVE
HIGHLAND, IN 46322

Tax Key No.: _____

WARRANTY DEED

93013908

This indenture witnesseth that
LARRY D. MCPHERON AND LINDA C. MCPHERON, HUSBAND AND WIFE

of LAKE County in the State of INDIANA

Convey and warrant to

RAYMOND L. PHEBUS, JR. AND CONSTANCE S. PHEBUS, HUSBAND AND WIFE

of LAKE County in the State of INDIANA
for and in consideration of Ten Dollars and other good and valuable consideration
the receipt whereof is hereby acknowledged, the following Real Estate in LAKE County
in the State of Indiana, to wit:

STATE OF INDIANA/S.S.H.O.
LAKE COUNTY
FILED FOR RECORD
MAR 3 11 12 AM '93
SAMUEL COLLICH
RECORDER

LOT 1 IN ORCHARD AVENUE FIRST ADDITION TO THE TOWN OF HIGHLAND, AS PER PLAT THEREOF, RECORDED IN PLAT BOOK 48 PAGE 23, IN THE OFFICE OF THE RECORDER OF LAKE COUNTY, INDIANA.
Commonly known as: 9328 ORCHARD DRIVE, HIGHLAND, IN 46322.

Subject to past and current taxes and other obligations of the property of the Lake County Recorder!
Subject to easements, restrictions and covenants of record, if any.

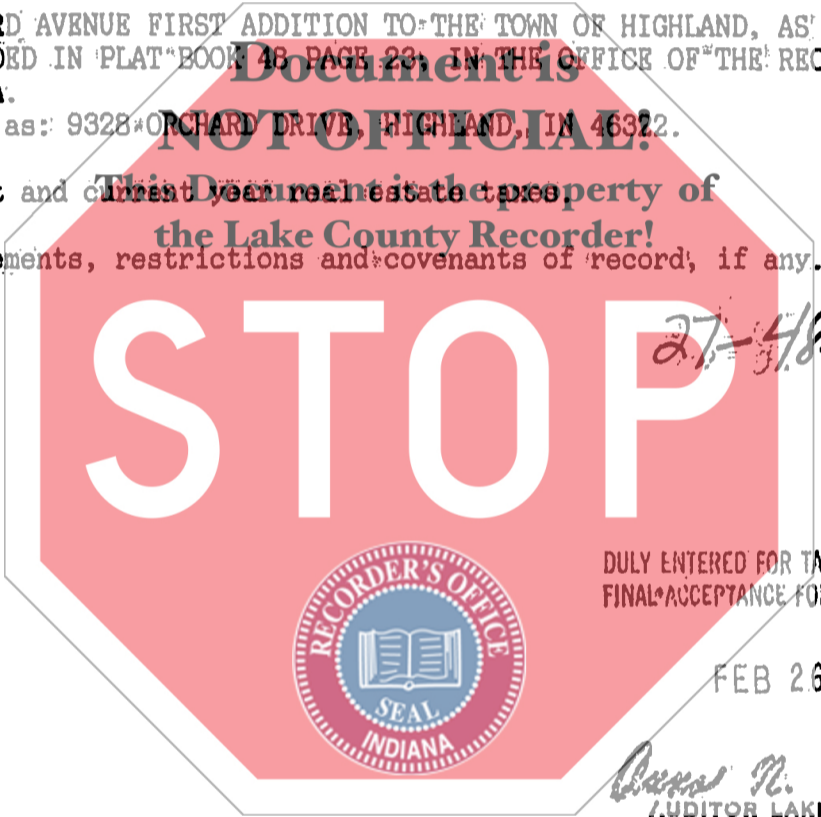

State of Indiana, Lake County, ss:
Before me, the undersigned, a Notary Public in and for said County and State, this 22nd day of February 1993 personally appeared:

LARRY D. MCPHERON AND LINDA C. MCPHERON,
HUSBAND AND WIFE

Dated this 22nd Day of February, 1993

Larry D. McPherson
LARRY D. MCPHERON
Linda C. McPherson
LINDA C. MCPHERON

And acknowledged the execution of the foregoing deed. In witness whereof, I have hereunto subscribed my name and affixed my official seal. My commission expires October 17 1994

Linda S. Wood
LINDA S. WOOD Notary Public

Resident of Lake County.

This instrument prepared by JOHN D. BRECLAW, JOHN D. BRECLAW & ASSOCIATES Attorney at Law
735 West Glen Park Avenue, Griffith, Indiana 46319