

93013462

ASSIGNMENT OF MORTGAGE

FOR VALUE RECEIVED, the within Mortgage to Holloway Lumber & Construction Co. Inc. (Mortgagee) on the property located at 775 Carolina St., Gary, Indiana 46402

which will be recorded in the office of the Recorder of Lake County, Indiana; in Mortgage Record simultaneously and the contract described therein which it secures are hereby assigned and transferred to EMPIRE FUNDING CORP., whose address is 1640 Vauxhall Road, Union, New Jersey 07083!

Witness the hand and seal of said mortgage, this 21st day of October, 1992

Holloway Lumber & Construction Co. (SEAL)

ATTEST: Donna M. Pearson, Secy SECRETARY Donna M. Pearson

(PRINT NAME OF CORPORATION)

BY: Allan Fefferman, President

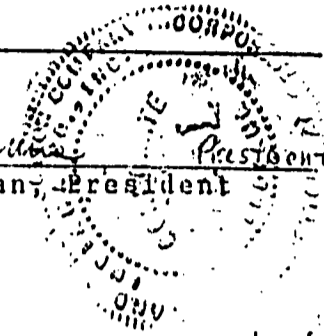

ACKNOWLEDGMENT (Individual/Partner)

STATE OF INDIANA, Lake County, ss:

Before me, the undersigned, a Notary Public in and for said county, this 21st day of October 19, 92, came and acknowledged the execution of the above assignment of mortgage.

IN WITNESS WHEREOF, I have hereunto subscribed my name and affixed my official seal.

My Commission expires Notary Public, County of residence

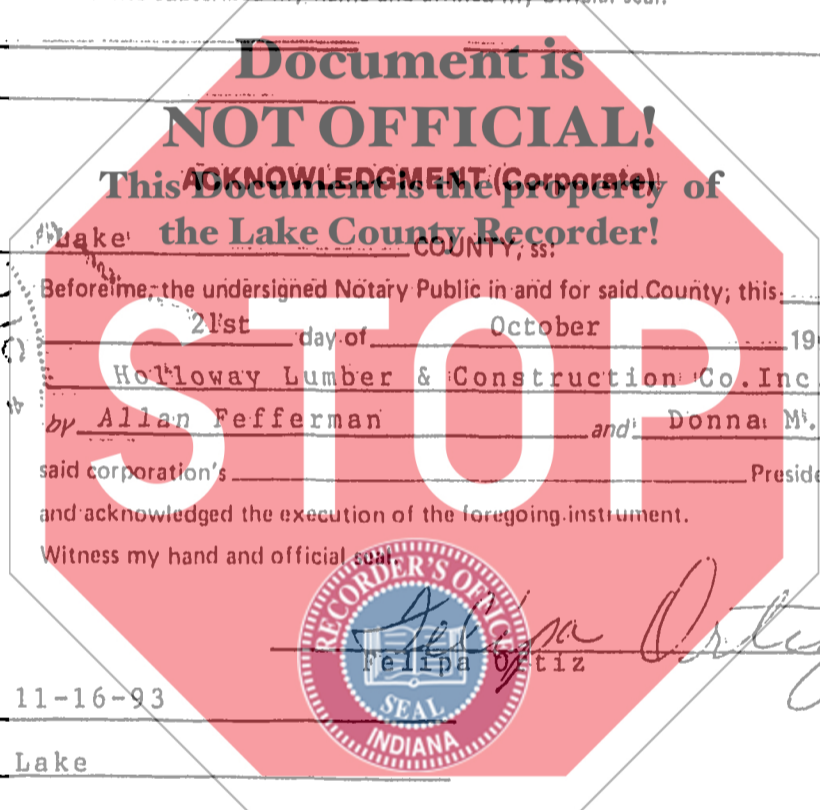

STATE OF INDIANA / S.S. NO. LAKE COUNTY FILED FOR RECORD MAR 2 8 43 AM '93 SAMUEL ORLICH RECORDER

STATE OF INDIANA, Lake County, ss: Before me, the undersigned Notary Public in and for said County, this 21st day of October 19, 92

Holloway Lumber & Construction Co. Inc. by Allan Fefferman and Donna M. Pearson said corporation's President and Secretary respectively, and acknowledged the execution of the foregoing instrument.

Witness my hand and official seal. Felipa Ortiz Notary Public

My Commission expires 11-16-93

County of residence Lake



This instrument was prepared by: Felipa Ortiz

Type Name Felipa Ortiz

EFC-ID 7/82

ASSIGNMENT OF MORTGAGE

FROM:

TO:

DATE:

EMPIRE FUNDING CORP.

RECORD AND RETURN TO:

TMI FINANCIAL INC. 8582 Katy Freeway, Suite 202 Houston, Texas 77024

Handwritten initials 'JTB'

Handwritten 'R na Asrat'

Handwritten 'My #'

Vertical stamp '93013463'

Vertical stamp '93013461'