

4.

THIS FORM HAS BEEN APPROVED BY THE INDIANA STATE BAR ASSOCIATION FOR USE BY LAWYERS ONLY. THE SELECTION OF A FORM OF INSTRUMENT, FILLING IN BLANK SPACES, STRIKING OUT PROVISIONS AND INSERTION OF SPECIAL CLAUSES, CONSTITUTES THE PRACTICE OF LAW AND MAY ONLY BE DONE BY A LAWYER.

MAIL TAX BILLS TO:

TAX KEY NO: 30-488-31

Michael Brav 93013395 QUIT-CLAIM DEED

4120 Drummond East Chicago, IN 46312

B-464808

This indenture witnesseth that JOSEPH M. BRAV

of Lake County in the State of Indiana

Releases and quit claims to MICHAEL J. BRAV

of Lake County in the State of Indiana for and in consideration of Ten Dollars (\$10.00) the receipt whereof is hereby acknowledged, the following Real Estate in Lake County in the State of Indiana, to wit:

STATE OF INDIANA/S.S.NO LAKE COUNTY FILED FOR RECORD County. Chicago Title Insurance Company. MAR 1 1 12 PM '93 SAMUEL OREIGH RECORDER

Lot Thirty-One (31), in Block Twelve (12), as marked and laid down on the recorded plat of Park Addition to Indiana Harbor, in the City of East Chicago, Lake County, Indiana, as the same appears of record in Plat Book Five (5), page Thirty-Div (32), in the Recorder's Office of Lake County, Indiana.

Commonly known as: 4120 Drummond, East Chicago, Indiana, 46312.

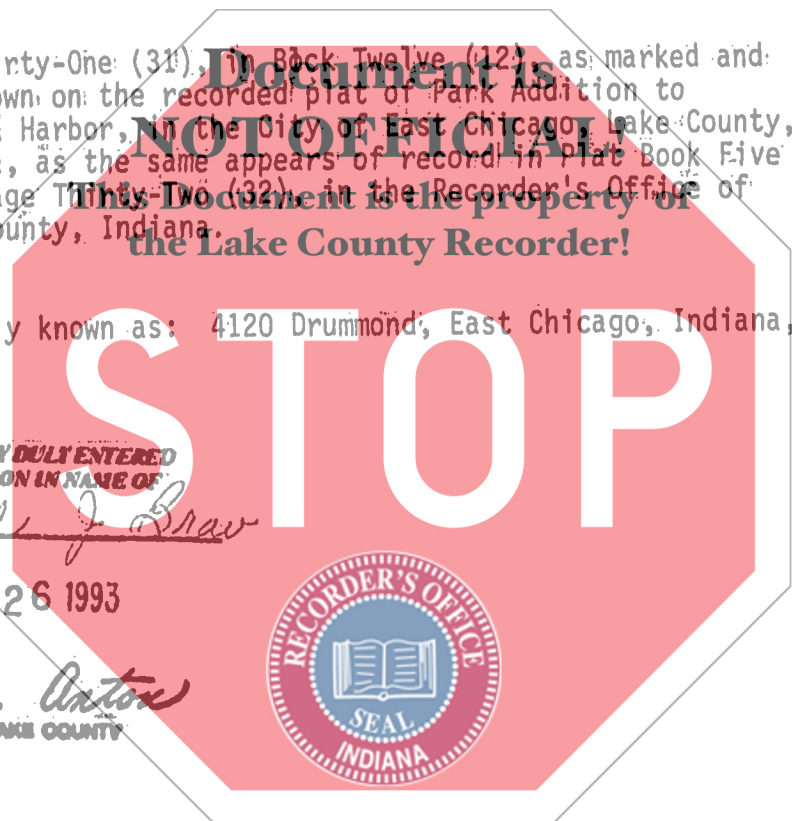

WAS ALREADY DULY ENTERED FOR TAXATION IN NAME OF

Michael J. Brav

FEB 26 1993

Anna N. Anton AUDITOR LAKE COUNTY



State of Indiana, Lake County, ss: Before me, the undersigned, a Notary Public in and for said County and State, this 13 day of Oct 1992 personally appeared:

Dated this 13 Day of Oct 1992

Joseph M. Brav JOSEPH M. BRAV

JOSEPH M. BRAV

And acknowledged the execution of the foregoing deed. In witness whereof, I have hereunto subscribed my name and affixed my official seal. My commission expires 1/28 1995

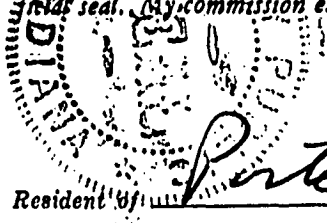

Joseph E. Costanza Notary Public

Resident of Porter County

This instrument prepared by Joseph E. Costanza, 720 W. Chicago Ave., East Chicago, IN, Attorney at Law

MAIL TO: 720 West Chicago Avenue, East Chicago, IN 46312