

*Hold. Angie*

# TAX TITLE DEED TO COUNTY

93010821

WHEREAS, LAKE County did, on the 18TH day of DECEMBER, 1989, produce to the undersigned, ANNA N. ANTON, auditor of the county of LAKE, in the state of Indiana, a certificate of sale dated the 18TH day of DECEMBER, 1989, signed by ANNA N. ANTON, who, at the date of the sale, was auditor of the county, from which it appears that said county on the 18TH day of DECEMBER, 1989, obtained, pursuant to law, the real property described in this indenture for the sum of TWO THOUSAND FIVE HUNDRED FORTY THREE dollars and 84/100 cents,

being the amount due on the real property for taxes, special assessments, penalties and costs for the years 1988 PAYABLE 1989 & PREVIOUS, namely:

- 1986 PAYABLE 1987 (ADDITIONAL AMOUNT OF TAXES ADDED TO PROPERTY
- 1987 PAYABLE 1988 SINCE COUNTY ACQUIRED LIEN \$1,751.99)
- 1988 PAYABLE 1989

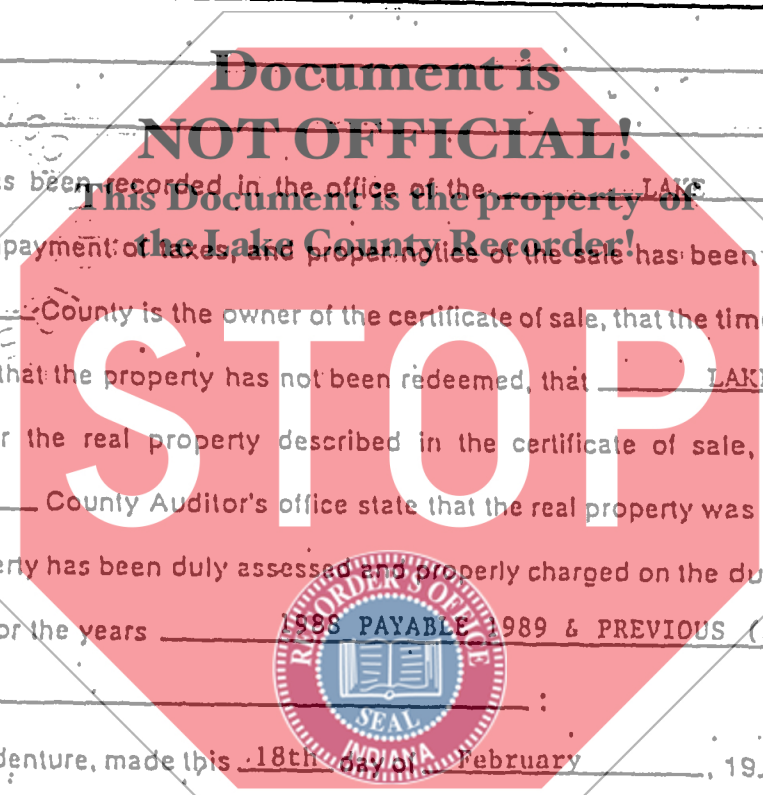

STATE OF INDIANA  
 LAKE COUNTY  
 FILED FOR RECORDER  
 FEB 18 9 05 AM '93  
 SAHU RECORDER

Such real property has been recorded in the office of the LAKE County Auditor delinquent for the nonpayment of taxes, and proper notice of the sale has been given. It appearing that LAKE County is the owner of the certificate of sale, that the time for redeeming such real property has expired, that the property has not been redeemed, that LAKE County has demanded a deed for the real property described in the certificate of sale, that the records of the LAKE County Auditor's office state that the real property was legally liable for taxation, and that the real property has been duly assessed and properly charged on the duplicate with the taxes and special assessments for the years 1988 PAYABLE 1989 & PREVIOUS (SEE ABOVE)

Therefore, this indenture, made this 18th day of February, 1993, between the state of Indiana, by ANNA N. ANTON, auditor of LAKE County, of the first part, and LAKE County, of the second part, witnesseth: That the party of the first part, for and in consideration of the premises, has granted and bargained and conveyed to the party of the second part, the real property described in the certificate of sale, situated in the county of LAKE, and state of Indiana, namely and more particularly described as follows:

- UNIT 26 KEY# 36-243-17 TURNERS 1ST ADD. S2 L.14 & ALL L.15 BL.3  
5832 ERIE AVE., HAMMOND, IN. 46320
- UNIT 26 KEY# 36-243-18 TURNERS 1ST ADD. L.16 BL.3 N2 L.17 BL.3  
5836 ERIE AVE., HAMMOND, IN. 46320

## NOT-TAXABLE

FEB 18 1993  
Anna N. Anton  
 Auditor Lake County

to have and to hold such real property, with the appurtenances belonging thereto, in as full and ample a manner as the auditor of said county is empowered by law to convey the same.

In testimony whereof, ANNA N. ANTON auditor of LAKE County, has hereunto set his hand, and affixed the seal of the board of county commissioners, the day and year last above mentioned.

Anna N. Anton  
Auditor of LAKE County

ATTEST: Jesse Halvinger  
Treasurer of LAKE County

STATE OF INDIANA }  
COUNTY OF LAKE } SS:

Before me, the undersigned, ROBERT C. ANTICH, Clerk, LAKE

Circuit Court, in and for said county, this day, personally came the above named ANNA N. ANTON, auditor of said County, and acknowledged that he signed and sealed the foregoing deed for the uses and purposes therein mentioned.

In witness whereof, I have hereunto set my hand and seal this 18th day of FEBRUARY, 1993.

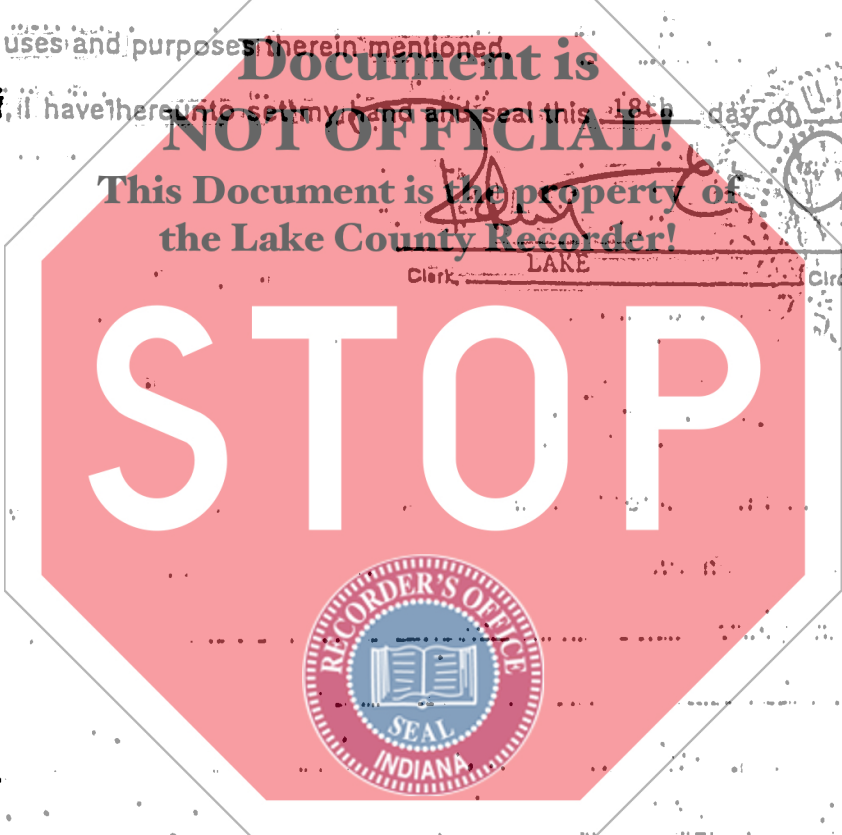

TO  
LAKE COUNTY INDIANA  
2293 N. MAIN STREET  
CROWN POINT, IN. 46307

TAX TITLE DEED  
PUBLIC SALE

Received for Record

The \_\_\_\_\_ day of \_\_\_\_\_  
A.D. 19\_\_\_\_, at \_\_\_\_\_ O'Clock \_\_\_\_\_ M., and recorded in  
Record \_\_\_\_\_  
Pages \_\_\_\_\_  
Recorder of \_\_\_\_\_ County \_\_\_\_\_

Duly Entered for Taxation \_\_\_\_\_, 19\_\_\_\_

Auditor \_\_\_\_\_