

THIS FORM HAS BEEN PREPARED FOR USE WITHIN THE STATE OF INDIANA. THE SELECTION OF A FORM OF INSTRUMENT, FILLING IN BLANK SPACES, STRIKING OUT PROVISIONS, AND INSERTION OF SPECIAL CLAUSES, MAY CONSTITUTE THE PRACTICE OF LAW AND SHOULD ONLY BE DONE BY A LAWYER.

Mail tax bills to:
838 FARMER COURT
SCHERERVILLE, INDIANA
46375

92079888

Tax Key No.: 20-13-282-33

WARRANTY DEED

This indenture witnesseth that **JOSE A. MONTEMAYOR AND ERIN L. MONTEMAYOR,**
HUSBAND AND WIFE

of **LAKE** County in the State of **INDIANA**
Convey and warrant to **Cecil Patrick and Donna Patrick,**
husband and wife

STATE OF INDIANA
LAKE COUNTY
FILED FOR RECORD
DEC 16 9 12 AM '92
ROBERT BELAND
RECORDER

of **LAKE** County in the State of **INDIANA**
for and in consideration of **TEN (\$10.00) DOLLARS AND OTHER GOOD AND VALUABLE CONSIDERATION**
the receipt whereof is hereby acknowledged, the following Real Estate in **LAKE** County
in the State of Indiana, to wit:

The real estate and premises commonly known as 838 Farmer Court, in the Town of Schererville, County of Lake, State of Indiana, and more particularly described as follows, to-wit:

Lot 137 in Novo-Selo Unit No. 3 in the Town of Schererville, as per plat thereof, recorded in Plat Book 48 page 67, in the Office of the Recorder of Lake County, Indiana, and amended by the State of Indiana recorded February 14, 1980 as Document No. 573299.

Subject to real estate taxes for 1992 payable in 1993 together with delinquency and penalty, if any, and all real estate taxes due and payable thereafter.

Subject to recorded liens, encumbrances, easements, restrictions, ditches and drains, highways and legal rights of way, and matters which would be disclosed by an accurate survey or inspection of the premises.

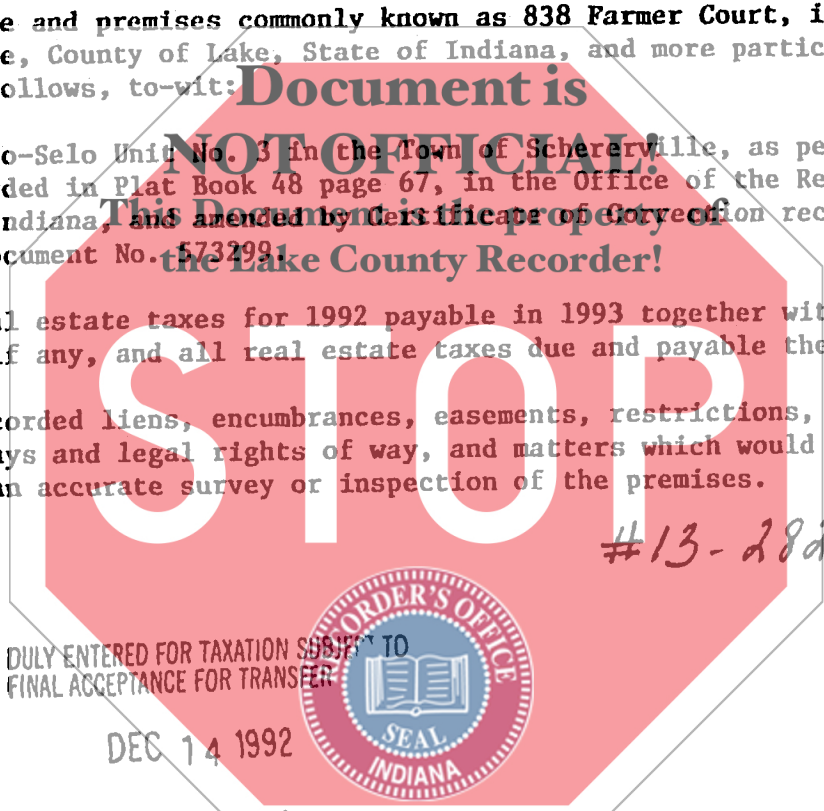

DULY ENTERED FOR TAXATION SUBJECT TO FINAL ACCEPTANCE FOR TRANSFER

DEC 14 1992

Anna M. Anton
AUDITOR LAKE COUNTY

State of Indiana, **LAKE** County, ss:
Before me, the undersigned, a Notary Public in and for said County and State, this **03rd** day of December **1992** personally appeared:

Jose A. Montemayor and Erin L. Montemayor, husband and wife

Dated this **03rd** Day of **December** **19** 92

Jose A. Montemayor
Jose A. Montemayor
Erin L. Montemayor
Erin L. Montemayor

And acknowledged the execution of the foregoing deed. In witness whereof, I have hereunto subscribed my name and affixed my official seal. My commission expires **06-07** 19**96**

Thomas G. Schiller
Thomas G. Schiller Notary Public

Resident of **LAKE** County.

This instrument prepared by **Thomas K. Hoffman, One Professional Center, Crown Point, IN 46307** Attorney at Law

00514

700
K

12-7-92