

THIS FORM HAS BEEN PREPARED FOR USE WITHIN THE STATE OF INDIANA. THE SELECTION OF A FORM OF INSTRUMENT, FILLING IN BLANK SPACES, STRIKING OUT PROVISIONS, AND INSERTION OF SPECIAL CLAUSES, MAY CONSTITUTE THE PRACTICE OF LAW AND SHOULD ONLY BE DONE BY A LAWYER.

Mail tax bill to: 92078220
9201 Franklin Dr.,
St. John, Indiana 46373

Tax Key No. _____

WARRANTY DEED

This indenture witnesseth that **JIM WEIS & SONS BUILDERS**

of **LAKE** County in the State of **INDIANA**

Convey and warrant to **JOHN R. LENCIONI and SHARON K. LENCIONI**, HUSBAND AND WIFE

of **LAKE** County in the State of **INDIANA**
for and in consideration of **TEN DOLLARS (\$10.00)** and other good and valuable consideration, the receipt whereof is hereby acknowledged, the following Real Estate in **LAKE** County in the State of Indiana, to-wit:

The real estate and premises commonly known as **9201 Franklin Dr.**, in the Town of **St. John**, County of **Lake**, State of **Indiana**, and more particularly described as follows, to-wit:

Lot 223 in Schilton in the Town of **St. John**, as per plat thereof, recorded in Plat Book 67 page 24, and amended by a plat of correction recorded in Plat Book 72 page 17, in the Office of the Recorder of **Lake County, Indiana**.

Subject to real estate taxes for 1992 payable in 1993, together with delinquency and penalty, if any, and all real estate taxes due and payable thereafter.

Subject to recorded liens, encumbrances, easements, restrictions, ditches and drains, highways and legal rights of way, and matters which would be disclosed by an accurate survey or inspection of the premises.

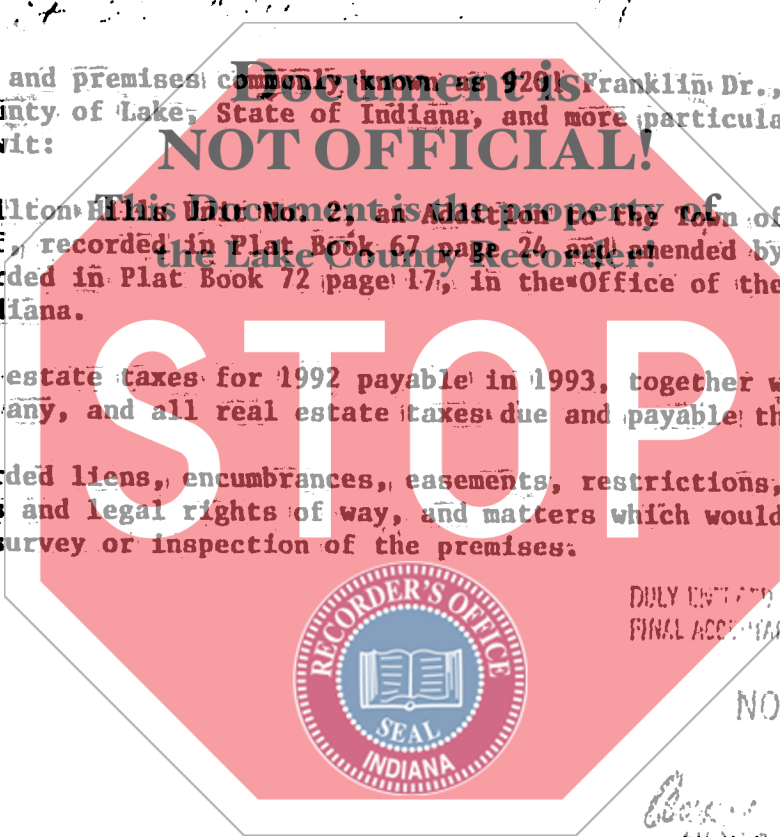

DULY LISTED FOR TAXATION SUBJECT TO FINAL ADJUSTMENT FOR DEFERRED.

NOV 30 1992

Robert R. Carter
AUDITOR LAKE COUNTY

State of **Indiana**, **LAKE** County, ss:
Before me, the undersigned, a Notary Public in and for said County and State, this **19th** day of **November** 19**92** personally appeared:

JIM WEIS & SONS BUILDERS
BY **Charles P. Weis and Mary Lee C. Weis**

Dated this **19th** Day of **November** 19**92**

JIM WEIS & SONS BUILDERS

Charles P. Weis

BY **CHARLES P. WEIS, CHAIRMAN**

Mary Lee C. Weis

BY **MARY LEE C. WEIS, SECRETARY**

And acknowledged the execution of the foregoing deed. In witness whereof, I have hereunto subscribed my name and affixed my official seal. My commission expires **January 26, 1995**

Linda J. McBride
Linda J. McBride Notary Public

Resident of **Lake** County.

01762

This instrument prepared by **Thomas K. Hoffman, One Professional Center, Crown Point, Ind. 46307** Attorney at Law