



92070906

GARY SANITARY DISTRICT

TREATMENT PLANT · SEWER DIVISION · INDUSTRIAL SURVEILLANCE DIVISION

Mailing Address: P.O. Box 388, Gary, Indiana 46402

Finance Office: 846 Broadway, Gary, Indiana 46402
219/886 2420
Customer Service: 883-1027

Administration and Plant: 3600 West 3rd Avenue, Gary, Indiana
219/944 0595
Sewer Division: 944-1211

RELEASING OF SEWER LIEN

FOR A VALUABLE CONSIDERATION, THE RECEIPT WHEREOF IS HEREBY ACKNOWLEDGED, A

CERTAIN SEWAGE LIEN EXISTING IN FAVOR OF GARY SANITARY DISTRICT
(name and full address of lienholder)

840 Broadway - Gary, IN 46402

AND AGAINST MARDIA E. EDWARDS
(name(s) of property owners)

ON THE FOLLOWING REAL ESTATE TO-WIT:

AMOUNT \$ 290.99

DOCUMENT NUMBER 889555

KEY NUMBER 25-45-0195-0010

LEGAL DESCRIPTION (include the street address and legal description)

KELLY-GLOVER VALE PARKSIDE ADD. ALL L.10 BL.2

3541 FILLMORE STREET

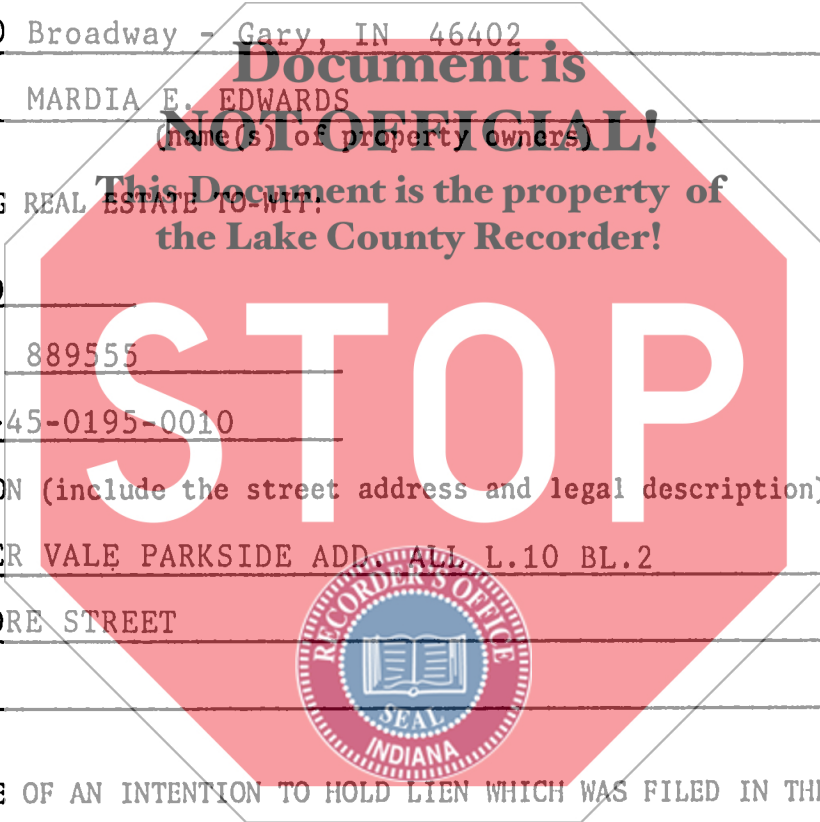

STATE OF INDIANA
LAKE COUNTY
FILED FOR RECORD
NOV 9 11 16 AM '92
ROBERT E. ANDERSON
RECORDER

A WRITTEN NOTICE OF AN INTENTION TO HOLD LIEN WHICH WAS FILED IN THE OFFICE OF THE RECORDER OF LAKE COUNTY, STATE OF INDIANA, AND SAID COUNTY IS HEREBY DECLARED FULLY SATISFIED AND RELEASED THIS 29th DAY OF September, 1992.

PREPARED BY Gay M. Lowery
TITLE Collection Clerk IV

700
a