

THIS FORM HAS BEEN PREPARED FOR USE WITHIN THE STATE OF INDIANA. THE SELECTION OF A FORM OF INSTRUMENT, FILLING IN BLANK SPACES, STRIKING OUT PROVISIONS, AND INSERTION OF SPECIAL CLAUSES, MAY CONSTITUTE THE PRACTICE OF LAW AND SHOULD ONLY BE DONE BY A LAWYER.

92070746

Tax Key No.: 20-13 434-16

Mail tax bills to:

305 Blick View Drive
Scherville, Indiana 46375

WARRANTY DEED

This indenture witnesseth that JOHN LANTZ

of LAKE County in the State of INDIANA

Convey and warrant to PETER R. FEIKEMA and DIANNE C. FEIKEMA, Husband and Wife

STATE OF INDIANA
LAKE COUNTY
FILED FOR RECORD
NOV 9 9 27 AM '92
ROBERT REICHER
RECORDER

of LAKE County in the State of INDIANA

for and in consideration of Ten Dollars and other good and valuable consideration the receipt whereof is hereby acknowledged, the following Real Estate in LAKE County in the State of Indiana, to wit:

Lot 55 in Hilbrichaus Acres Second Addition to the Town of Scherville, as per plat thereof, recorded in Plat Book 63 page 29, in the Office of the Recorder of Lake County, Indiana.

Commonly known as: 305 Blick View Drive
Scherville, Indiana 46375

Subject to past and current year real estate taxes.

Subject to easements, restrictions and covenants of record, if any.

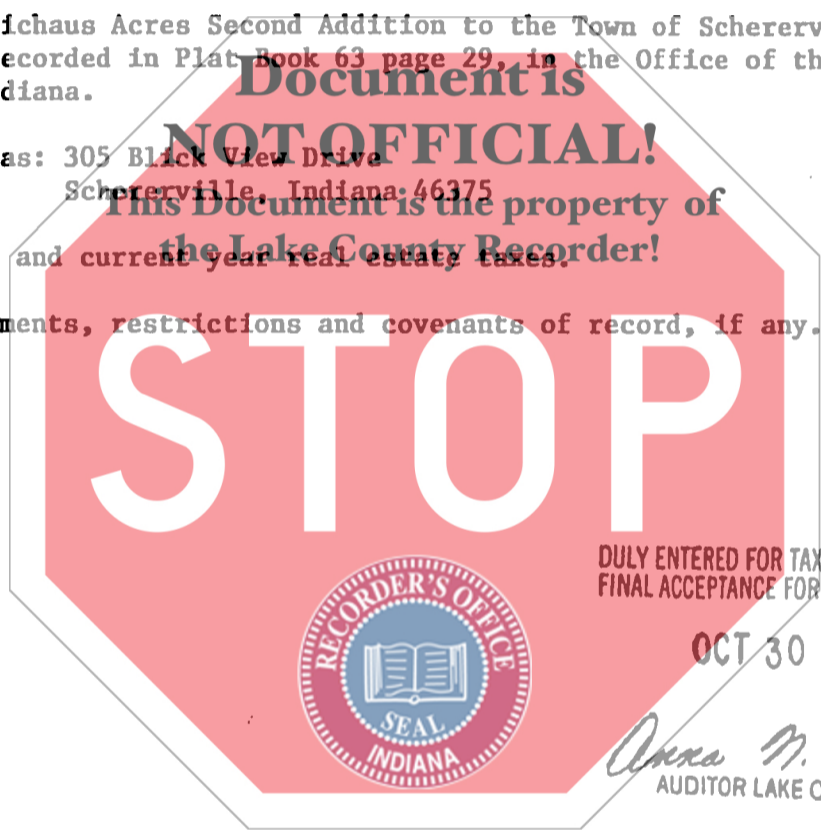

DULY ENTERED FOR TAXATION SUBJECT TO FINAL ACCEPTANCE FOR TRANSFER

OCT 30 1992

Anna M. Anton
AUDITOR LAKE COUNTY

State of Indiana, LAKE County, ss:

Dated this 12th Day of October 19 92

Before me, the undersigned, a Notary Public in and for said County and State, this 12th day of October 19 92 personally appeared:

John Lantz
JOHN LANTZ

JOHN LANTZ

And acknowledged the execution of the foregoing deed. In witness whereof, I have hereunto subscribed my name and affixed my official seal. My commission expires December 3, 19 93

Jean Henderson
Jean Henderson Notary Public

Resident of Lake County.

700
to

009.13

This instrument prepared by John D. Breclaw, JOHN D. BRECLAW & ASSOCIATES Attorney at Law
735 West Glen Park Avenue, Griffith, IN 46319
219-924-8750

10-14-92