

STATE TAXES TO: 411 Williams, St.
92069955 Hmd., IN 46320
ATTN: Robert FLAICH

Return to: J. R. WHITAKER
5231 Hohman Av.
H.M. IN 46320

STATE OF INDIANA)
COUNTY OF LAKE) ss:) IN THE LAKE SUPERIOR COURT

FILED IN
CLERK'S OFFICE

OCT 26 37-17-1

SCHOOL CITY OF HAMMOND,
INDIANA, a Municipal Corporation,
Plaintiff,

ROBERT FLAICH
CLERK LAKE SUPERIOR COURT

v. CAUSE NO. 45 D05 9207 CP 1163

CSX TRANSPORTATION, INC.;
MCI TELECOMMUNICATIONS
CORPORATION; AUDITOR OF
LAKE COUNTY (Indiana);
and TREASURER OF LAKE
COUNTY (Indiana),
Defendants.

167865

STATE OF INDIANA
LAKE COUNTY
TICOR TITLE INSURANCE
Crown Point, Indiana

ROBERT FLAICH
RECORDER
CLERK

NOV 5 9 14 AM '92

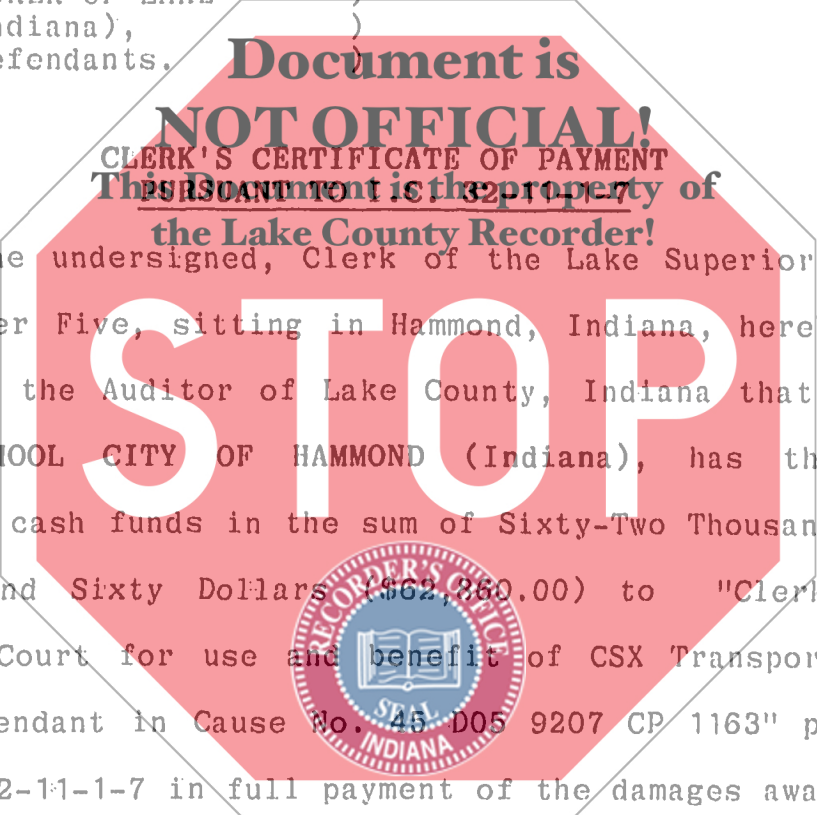

The undersigned, Clerk of the Lake Superior Court, Room Number Five, sitting in Hammond, Indiana, hereby certifies to the Auditor of Lake County, Indiana that Plaintiff, SCHOOL CITY OF HAMMOND (Indiana), has this date deposited cash funds in the sum of Sixty-Two Thousand Eight Hundred and Sixty Dollars (\$62,860.00) to "Clerk, Lake Superior Court for use and benefit of CSX Transportation, Inc., Defendant in Cause No. 45 D05 9207 CP 1163" pursuant to I.C. 32-11-1-7 in full payment of the damages awarded by the Court-appointed appraisers in the above-captioned matter pursuant to "Report of Appraisers" filed in open court on September 14, 1992, a legal description of which said

NOT-TAXABLE

OCT 30 1992

Anna N. Anton
AUDITOR LAKE COUNTY

1600
to
962
10-9-92

property is attached hereto as Exhibit "A"; thereby authorizing the Auditor of Lake County to now transfer the described real estate being condemned to Plaintiff, SCHOOL CITY OF HAMMOND (Indiana) on the tax records of the county pursuant to I.C. 32-11-1-7.

DATED this 6 day of October, 1992.

**Document is
NOT OFFICIAL!**

**This Document is the property of
the Lake County Recorder.**

ROBERT C. ANTICH, CLERK
LAKE SUPERIOR COURT, ROOM NO. 5

BY:

Robert C. Antich
Cynthia Beilone, Deputy

STOP
(SEAL)



**LEGAL DESCRIPTION
OF CSX TRANSPORTATION, INC. PROPERTY**

PARCEL I:

A strip of land 30 feet wide on each side of the center line of the right of way of the said The Chicago, Cincinnati & Louisville Railroad, as the same is now located on, over and across the Southwest Quarter of Section 6, Township 36 North, Range 9 West, which center line is described as follows, to-wit: Beginning at a point which is 30 feet West of where the South line of said Southwest Quarter intersects the West line of the right of way of the Chicago & Erie Railroad, running thence Northwesterly parallel to and 30 feet distant Westerly from the West line of the right of way of said Chicago & Erie Railroad 610.2 feet to the point of curve; thence by a three degree curve to the left 1216.9 feet to the East line of Calumet Avenue in the City of Hammond, Lake County, Indiana, at a point 30 feet East and 140.8 feet South of the Northwest corner of said Southwest Quarter in Lake County, in the State of Indiana.

Also beginning at a point one hundred seventy five (175) feet more or less, South and forty (40) feet more or less East of the Northwest corner of the Southwest Quarter of the Southwest Quarter of said Section six (6) Township thirty six (36) North, Range nine (9) West of the Second Principal Meridian, which point is the intersection of the East line of Calumet Avenue and the South line of the present right of way of The Chicago, Cincinnati & Louisville Railroad Company, in the City of Hammond, Indiana; thence in a Southeasterly direction along The Chicago, Cincinnati & Louisville Railroad Company's South right of way line a distance of seventeen hundred sixty two (1762) feet more or less to the South line of said Section six (6); thence West along said South line of Section six (6) a distance of seventy four and 9/10 (74.9) feet; thence in a Northwesterly direction sixty (60) feet distant and parallel to said South right of way line, a distance of sixteen hundred fifty three (1653) feet more or less to Calumet Avenue; thence North sixty three (63) feet more or less to the point of beginning. All of which is in Section six (6) Township thirty six (36) North, Range nine (9) West in the City of Hammond, Lake County, Indiana, except that part thereof, described as follows: Beginning at the point of intersection of the South line of Kenwood Avenue (formerly Walter Avenue) 60 feet wide, with the East line of Calumet Avenue, 80 feet wide; thence with the South line of Kenwood Avenue in an Easterly direction a distance of 425 feet, more or less, to a point in the Southwest right of way line of the



**Southwest
Quarter of
the

Southwest

Filed in Open Court

AUG 17 1992

EXHIBIT A

[Signature]
CLERK LAKE SUPERIOR COURT

Erie Railroad; thence perpendicular to the South line of Kenwood Avenue in a Southerly direction a distance of 398 feet, more or less, to a point in the Southerly right of way line of grantor; thence with said right of way line 470 feet, more or less, along the arc of a curve to the left in a Northwesterly direction, said curve having a radius of 1,820 feet, more or less, to a point in the East line of Calumet Avenue; thence with the East line of Calumet Avenue in a Northerly direction a distance of 198 feet, more or less, to the point of beginning, being all or part of the same property acquired by the Chicago, Cincinnati and Louisville Railroad Company, a predecessor of grantor, from Walter C. Larned, et al, by deed dated June 25, 1906, recorded in Book 124 page 107, and deed dated September 12, 1908, recorded in Book 149 page 6, both among the public land records of Lake County, Indiana.

Document is NOT OFFICIAL!

PARCEL II:

This Document is the property of the Lake County Recorder!

A parcel of land in the Southwest 1/4 of Section 6, Township 36 North, Range 9 West of the Second Principal Meridian, Lake County, Indiana, more particularly described as follows: BEGINNING at the Intersection of the South right-of-way line of Kenwood Street and the Westerly right-of-way line of Erie Lackawanna Railroad; thence South 37 degrees 38 minutes 01 seconds East, along said Westerly right-of-way line, 974.36 feet to the intersection of the Northerly right-of-way line of the Chicago, Cincinnati & Louisville Railroad Company; thence on a curve to the left, 784.34 feet, said curve having a radius of 1939.85 feet and a chord that bears North 42 degrees 13 minutes 01 seconds West 779.01 feet; thence North 01 degrees 06 minutes 41 seconds West, perpendicular to the South right-of-way line of Kenwood Street, 262.83 feet to the Point of Beginning.

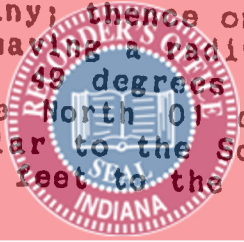

Walter C. Larned, et al

187/01

Edward J. Hutson
Registered Surveyor

Indiana - Illinois
Wisconsin



E.J. HUTSON and ASSOCIATES

PROFESSIONAL SURVEYORS
601 CHESTNUT BOULEVARD
CHESTERTON, INDIANA 46304
Phone: (219) 926-2358



F A X M E M O R A N D U M

To: Jose L. Dico From: Ed Hutson
 Company: Tice Ins. Co. Date: 8-3-92 Time: _____
 Fax Number: 662-1511 Page One of 2 including this page.

Document is NOT OFFICIAL!

This Document is the property of the Lake County Recorder!

SUBJECT: A Description for Parcel 25 - Maywood Site
School City of Hammond

Fax Copy Sent to: JACK SWINDELL
Fanning/Hobby Assoc.

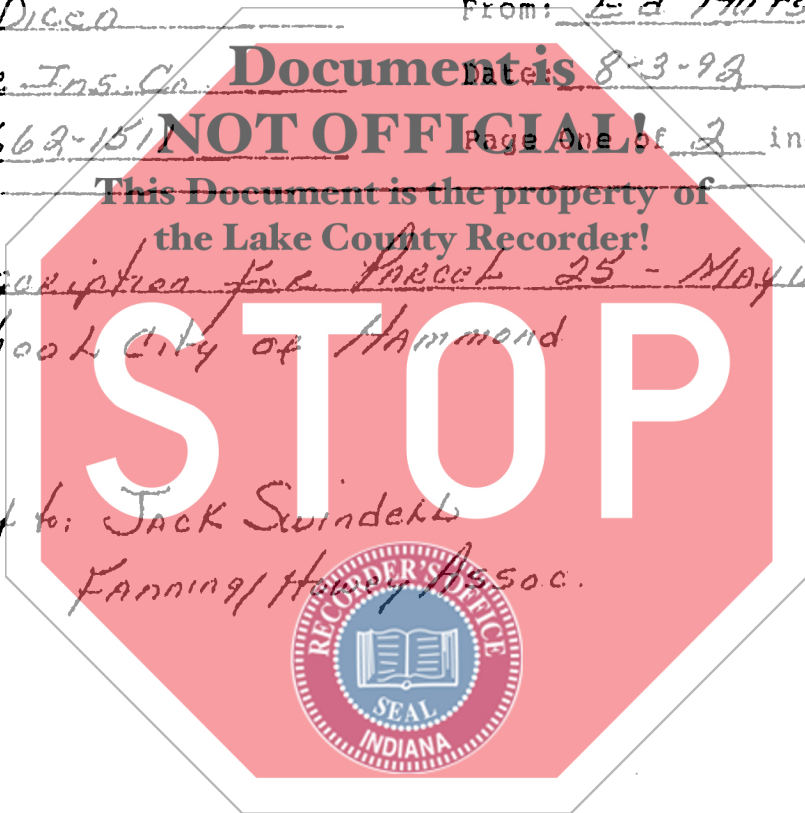

Edward J. Hutson
Registered Surveyor

Indiana - Illinois
Wisconsin



E.J. HUTSON and ASSOCIATES

PROFESSIONAL SURVEYORS
601 CHESTNUT BOULEVARD
CHESTERTON, INDIANA 46304
Phone: (219) 926-2358



DESCRIPTION

Parcel 25

A parcel of land in the Southwest 1/4 of Section 6, Township 36 North, Range 9 West of the Second Principal Meridian, Lake County, Indiana more particularly described as follows: BEGINNING at the Intersection of the South right-of-way line of Kenwood Street and the Westerly right-of-way line of Erie Lackawanna Railroad; thence South 37°38'01" East, along said Westerly right-of-way line, 974.36 feet to the Intersection of the Northerly right-of-way line of the Chicago, Cincinnati & Louisville Railroad Company; thence on a curve to the left, 784.34 feet, said curve having a radius of 1939.85 feet and a chord that bears North 49°13'01" West 779.01 feet; thence North 01°06'41" West, perpendicular to the South right-of-way line of Kenwood Street, 262.83 feet to the Point of Beginning. Containing 1.277 acres and subject to all legal highways and easements.

Re: School City of Hammond
Date: August 3, 1992
File: Maywood Site

