

THIS FORM HAS BEEN APPROVED BY THE INDIANA STATE BAR ASSOCIATION FOR USE BY LAWYERS ONLY. THE SELECTION OF A FORM OF INSTRUMENT, FILLING IN BLANK SPACES, STRIKING OUT PROVISIONS AND INSERTION OF SPECIAL CLAUSES, CONSTITUTES THE PRACTICE OF LAW AND MAY ONLY BE DONE BY A LAWYER.

MAIL TAX BILLS TO:
259 North Lake St.
Gary, IN 92069333

QUIT CLAIM DEED

LAKE COUNTY TITLE INS. CO.
ONE PROFESSIONAL CENTER
STATE #15
COURT HOUSE, IN 46007

This indenture witnesseth that **RAYMOND L. CURTIS**

of **Porter** County in the State of **Indiana**

Releases and quit claims to LAKE COUNTY TRUST, under trust agreement dated June 27, 1979 and known as Trust Number 2860

of **Lake** County in the State of **Indiana**
for and in consideration of **One Dollar (\$1.00) and other good and valuable consideration the receipt whereof is hereby acknowledged, the following Real Estate in Lake County in the State of Indiana, to wit:**

Lot 39, Block 2, Second Addition to Calumet City, in the City of Gary, as shown in Plat Book 2, Page 40, Lake County, Indiana.

Commonly known as 259 North Lake Street, Gary, Indiana.
the Lake County Recorder!

Key No. 42-42-43, Unit #25, Gary Corp.

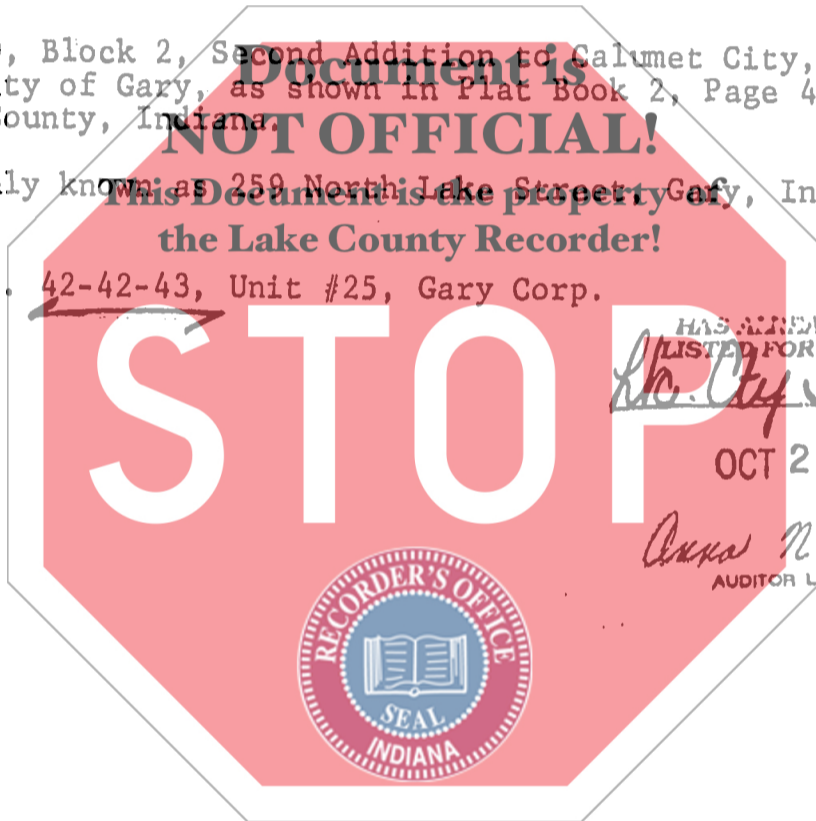

HAS ALREADY BEEN LISTED FOR TAXATION
L.C. City U# 2860

OCT 29 1992

Anna N. [Signature]
AUDITOR LAKE COUNTY

Robert [Signature]
RECORDER
7 12 15 PM '92

STATE OF INDIANA
LAKE COUNTY
FILED FOR RECORD
NO. []

State of Indiana, **Lake** County, ss:
Before me, the undersigned, a Notary Public in and for said County and State, this **9th** day of **October** 19**92** personally appeared:

Raymond L. Curtis

Dated this **9th** Day of **October** 19**92**

Raymond L. Curtis Seal
Raymond L. Curtis

Seal

Seal

Seal

Seal

Seal

And acknowledged the execution of the foregoing deed. In witness whereof, I have herewith subscribed my name and affixed my official seal. My commission expires **January 18** 19**92**

Maria R. Hyden
Maria R. Hyden Notary Public

Resident of **Lake** County

This instrument prepared by **Steve H. Tokarski**
7803 West 75th Avenue, Suite 1, Schererville, IN 46375

MAIL TO:

1.00