

92053356

Mail Tax Bills To:  
1940 Calumet Avenue  
Hammond, (Whiting P.O.), IN  
46394

STATE OF INDIANA )  
                          ) SS:  
COUNTY OF LAKE )

**AFFIDAVIT OF SURVIVORSHIP**

Comes now ELEANOR M. PIATEK, being duly sworn upon her oath and states as follows:

That ANTHONY PIATEK AND ELEANOR M. PIATEK, were the owners in fee simple of the following described real estate located in Lake County, Indiana, more particularly described as follows:

The South 40 feet of Lot 3 in Block 11 in Forsyth Water Gardens, in the City of Hammond, as per plat thereof, recorded in Plat Book 14 page 19, in the Office of the Recorder of Lake County, Indiana.

Commonly known as: 1940 Calumet Avenue, Whiting, IN. Key No. 33-147-~~X~~9

That the decedent, ANTHONY PIATEK, and ELEANOR M. PIATEK were Husband and Wife at the time they acquired title, as tenants by the entireties.

That the martial relationship, which existed between this affiant and ANTHONY PIATEK, her Husband, continued unbroken from the time they so acquired title to said real estate until the death of ANTHONY PIATEK, on the 19th day of February, 1987, at which time this affiant acquired title to the real estate as surviving tenant by the entireties.

That the gross value of the estate of the decedent, ANTHONY PIATEK, as determined for the purpose of Federal Estate Taxes and State Inheritance Tax was less than the value required for the filing and the decedent's estate was not subject to tax.

*Eleanor M. Piatek*  
ELEANOR M. PIATEK

Subscribed and sworn to before me, a Notary Public this 21st day of July, 1992.

MY COMMISSION EXPIRES:  
January 12, 1993

*David E. Mears*  
DAVID E. MEARS, NOTARY PUBLIC  
LAKE COUNTY RESIDENT

DULY ENTERED FOR TAXATION SUBJECT TO FINAL ACCEPTANCE OF STATE BOARD OF TAXATION. Prepared By: DAVID E. MEARS, Attorney at 27 Ridge Road, Highland, IN 46322; (219) 972-0990.

AUG 20 1992

*Anna N. Antow*  
AUDITOR LAKE COUNTY

335A

6000K  
E

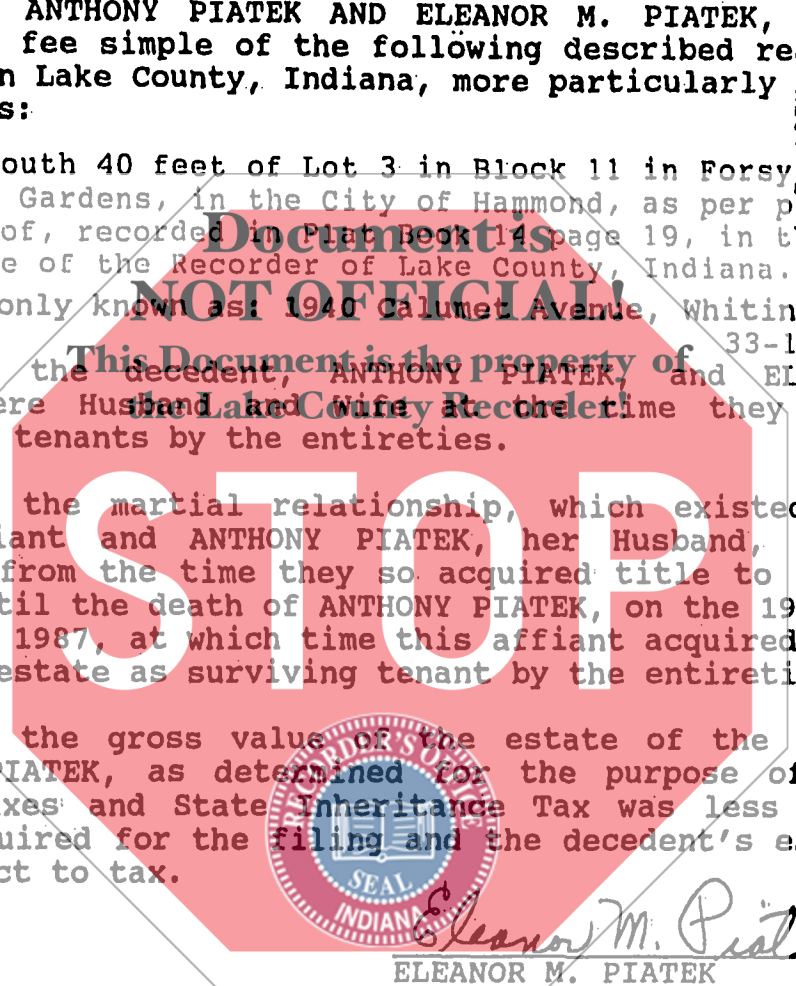

STATE OF INDIANA  
LAKE COUNTY  
FILED FOR RECORD

J 38 AM '92