

2

92053352

TAX TITLE DEED TO COUNTY

WHEREAS, LAKE County did, on the 18TH day of DECEMBER, 1989, produce to the undersigned, ANNA N. ANTON, auditor of the county of LAKE, in the state of Indiana, a certificate of sale dated the 18TH day of DECEMBER, 1989, signed by ANNA N. ANTON, who, at the date of the sale, was auditor of the county, from which it appears that said county on the 18TH day of DECEMBER, 1989, obtained, pursuant to law, the real property described in this indenture for the sum of _____ SIX THOUSAND SEVEN HUNDRED TWENTY ONE dollars and 83/100 cents,

being the amount due on the real property for taxes, special assessments, penalties and costs for the years 1988 PAYABLE 1989 & PREVIOUS, namely: _____
1986 PAYABLE 1987 (ADDITIONAL AMOUNT OF TAXES ADDED TO PROPERTY
1987 PAYABLE 1988 SINCE COUNTY ACQUIRED LIEN
1988 PAYABLE 1989 \$9,891.66)

Such real property has been recorded in the office of the LAKE County Auditor delinquent for the nonpayment of taxes, and proper notice of the sale has been given. LAKE County is the owner of the certificate of sale, that the time for redeeming such real property has expired, that the property has not been redeemed, that LAKE County has demanded a deed for the real property described in the certificate of sale, that the records of the LAKE County Auditor's office state that the real property was legally liable for taxation, and that the real property has been duly assessed and properly charged on the duplicate with the taxes and special assessments for the years 1988 PAYABLE 1989 & PREVIOUS (SEE ABOVE)

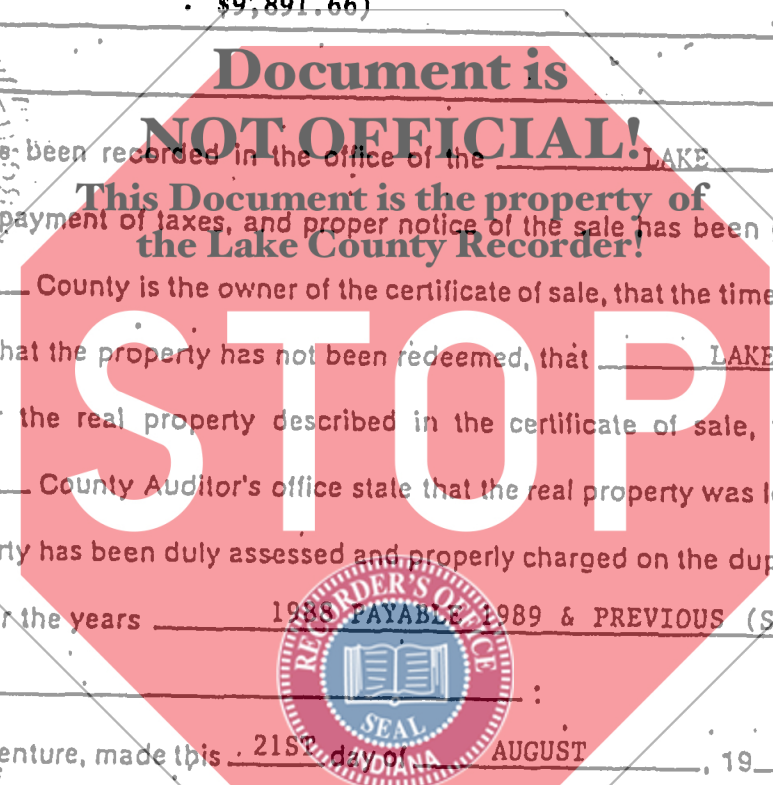

STATE OF INDIANA
LAKE COUNTY
FILED FOR RECORDING
AUG 21 9 32 AM 1992
ROBE RECORDED

Therefore, this indenture, made this 21ST day of AUGUST, 1992, between the state of Indiana, by ANNA N. ANTON, auditor of LAKE County, of the first part, and LAKE County, of the second part, witnesseth: That the party of the first part, for and in consideration of the premises, has granted and bargained and conveyed to the party of the second part, the real property described in the certificate of sale, situated in the county of LAKE, and state of Indiana, namely and more particularly described as follows: _____

26-36-239-19 TOWNSEND & GODFREY'S ADD. EX. N. 1 FT. L. 24, 25, 26, 27 BL. 2
 & EX. N 1 FT. OF E 1/2 L. 28 BL. 2
 469-87 SIBLEY ST., HAMMOND, IN. 46320

NOT-TAXABLE

AUG 21 1992

Anna N. Anton
AUDITOR LAKE COUNTY

0129

M/C

to have and to hold such real property, with the appurtenances belonging thereto, in as full and ample a manner as the auditor of said county is empowered by law to convey the same.

In testimony whereof, ANNA N. ANTON Auditor of LAKE County, has hereunto set his hand, and affixed the seal of the board of county commissioners, the day and year last above mentioned.

Anna N. Anton
Auditor of LAKE County

ATTEST: Gene Tolson
Treasurer of LAKE County

STATE OF INDIANA }
- COUNTY OF LAKE } SS:

Before me, the undersigned, ROBERT C. ANTICH, Clerk LAKE Circuit Court, in and for said county, this day, personally came the above named ANNA N. ANTON, auditor of said County, and acknowledged that he signed and sealed the foregoing deed for the uses and purposes therein mentioned.

In witness whereof, I have hereunto set my hand and seal this 21ST day of AUGUST 1992.

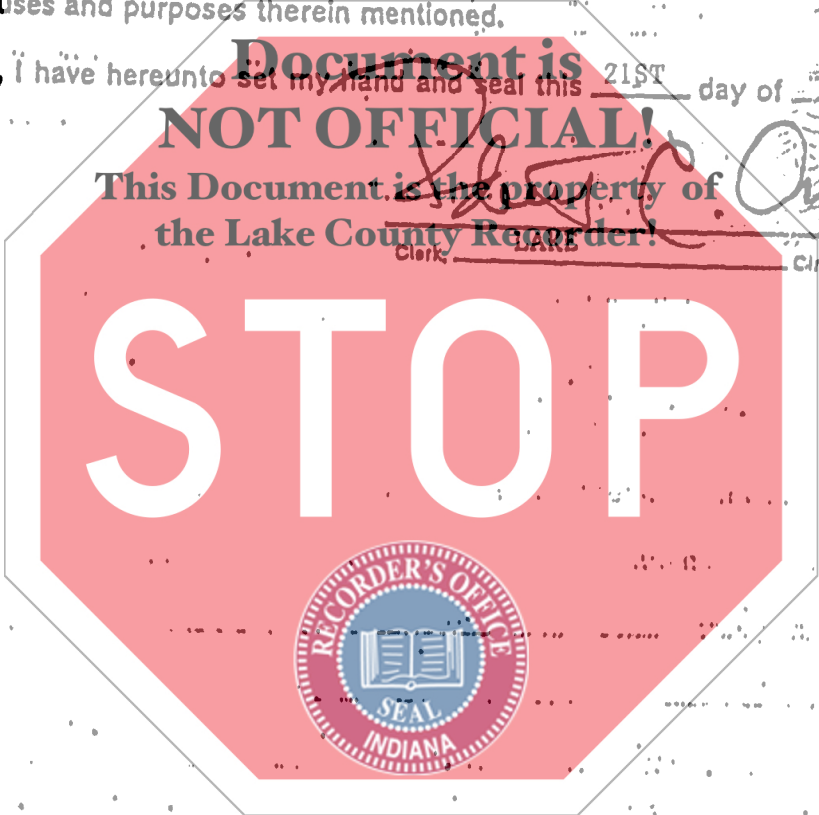

Robert C. Antich
Clerk LAKE Circuit Court

TO
LAKE COUNTY INDIANA
2293 N. MAIN STREET
CROWN POINT, IN. 46307

TAX TITLE DEED
PUBLIC SALE

Received for Record

The ___ day of _____

A.D. 19___, at ___ O'Clock ___ M., and recorded in

Record ___

Pages ___

Recorder of ___ County

Duly Entered for Taxation

___, 19___

Auditor