

2

92053351

TAX TITLE DEED TO COUNTY

WHEREAS, LAKE County did, on the 18TH day of DECEMBER, 19 89, produce to the undersigned, ANNA N. ANTON, auditor of the county of LAKE, in the state of Indiana, a certificate of sale dated the 18TH day of DECEMBER, 19 89, signed by ANNA N. ANTON, who, at the date of the sale, was auditor of the county, from which it appears that said county on the 18TH day of DECEMBER, 19 89, obtained, pursuant to law, the real property described in this indenture for the sum of ELEVEN THOUSAND NINE HUNDRED EIGHTY FOUR dollars and 63/100 cents,

being the amount due on the real property for taxes, special assessments, penalties and costs for the years 1988 PAYABLE 1989 & PREVIOUS, namely:

- 1986 PAYABLE 1987 (ADDITIONAL AMOUNT OF TAXES ADDED TO PROPERTY
- 1987 PAYABLE 1988 SINCE COUNTY ACQUIRED LIEN \$7,504.92)
- 1988 PAYABLE 1989

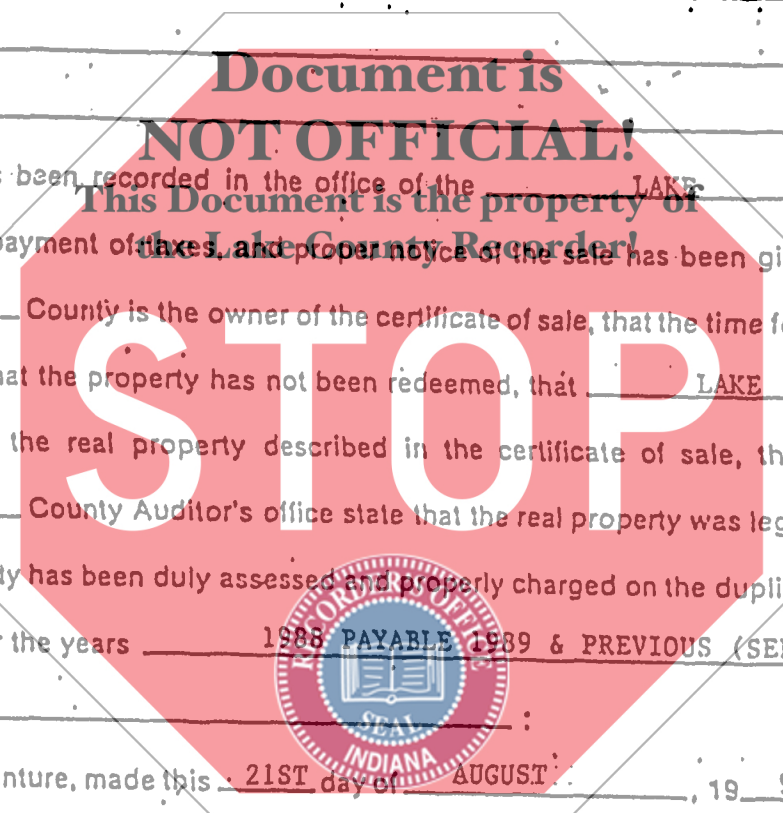

STATE OF INDIANA
 LAKE COUNTY
 FILED FOR RECORD
 AUG 21 3 37 AM '92
 ROBERT J. CLAND
 RECORDER

Such real property has been recorded in the office of the LAKE County Auditor delinquent for the nonpayment of taxes, and proper notice of the sale has been given. It appearing that LAKE County is the owner of the certificate of sale, that the time for redeeming such real property has expired, that the property has not been redeemed, that LAKE County has demanded a deed for the real property described in the certificate of sale, that the records of the LAKE County Auditor's office state that the real property was legally liable for taxation, and that the real property has been duly assessed and properly charged on the duplicate with the taxes and special assessments for the years 1988 PAYABLE 1989 & PREVIOUS (SEE ABOVE)

Therefore, this indenture, made this 21ST day of AUGUST, 19 92, between the state of Indiana, by ANNA N. ANTON, auditor of LAKE County, of the first part, and LAKE County, of the second part, witnesseth: That the party of the first part, for and in consideration of the premises, has granted and bargained and conveyed to the party of the second part, the real property described in the certificate of sale, situated in the county of LAKE, and state of Indiana, namely and more particularly described as follows: **NOT TAXABLE**

AUG 21 1992
Anna N Anton
 AUDITOR LAKE COUNTY

- 41-49-336-17 APPR 2924 W RIDGE RD., GARY, IN. 46408
WOODLAWN 2ND. SUB. L.17 BL.7
- 41-49-336-18 APPR 2918 W RIDGE RD., GARY, IN. 46408
WOODLAWN 2ND. SUB. L.18 BL.7
- 41-49-336-20 APPR 2908 W RIDGE RD., GARY, IN. 46408
WOODLAWN 2ND. SUB. L.20 BL.7
- 41-49-336-21 APPR 2900 W RIDGE RD., GARY, IN. 46408
WOODLAWN 2ND. SUB. L.21 BL.7
- 41-49-336-22 3880 TANEY ST., GARY, IN. 46408
WOODLAWN 2ND SUB. L.22 BL.7
L.23 BL.7 S 1/2 L.24 BL.7

11293
Mc

to have and to hold such real property, with the appurtenances belonging thereto, in as full and ample a manner as the auditor of said county is empowered by law to convey the same.

In testimony, whereof, ANNA N. ANTON auditor of LAKE County, has hereunto set his hand, and affixed the seal of the board of county commissioners, the day and year last above mentioned.

Anna N. Anton
Auditor of LAKE County

ATTEST: Gene Habinger
Treasurer of LAKE County

STATE OF INDIANA }
- COUNTY OF LAKE } SS:

Before me, the undersigned, ROBERT C. ANTICH, Clerk LAKE Circuit Court, in and for said county, this day, personally came the above named ANNA N. ANTON, auditor of said County, and acknowledged that he signed and sealed the foregoing deed for the uses and purposes therein mentioned.

In witness whereof, I have hereunto set my hand and seal this 21ST day of AUGUST 19 92.

Document is NOT OFFICIAL!
This Document is the property of the Lake County Recorder!
Robert C. Antich
Clerk, LAKE Circuit Court

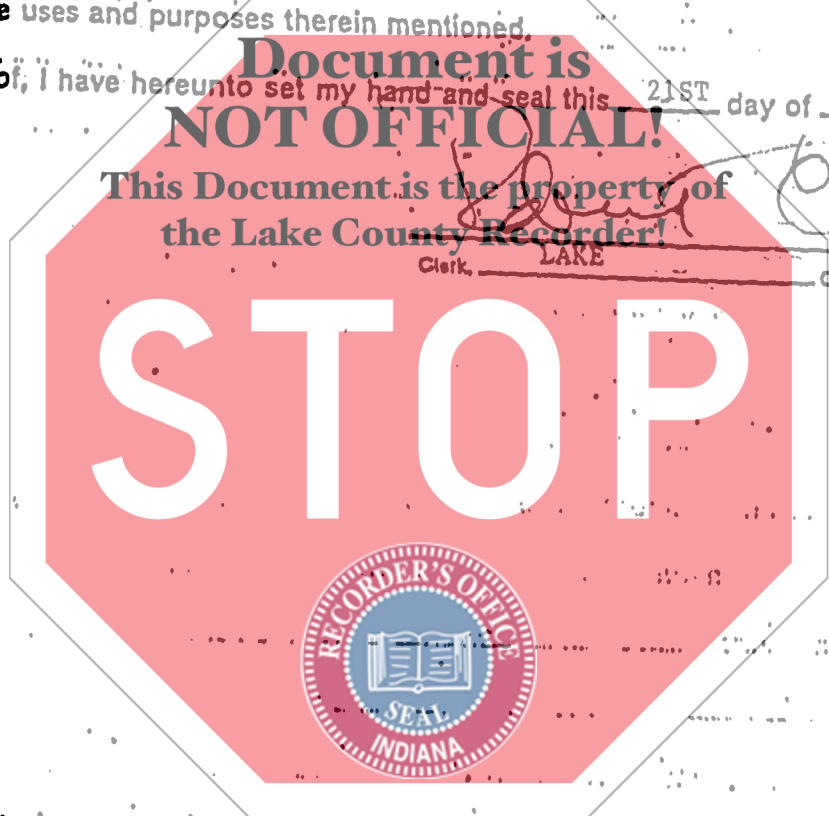

TO
LAKE COUNTY INDIANA
2293 N. MAIN STREET
CROWN POINT, IN. 46307

TAX TITLE DEED
PUBLIC SALE

Received for Record

The ___ day of _____, A.D. 19___, at ___ O'Clock ___ M., and recorded in
Record _____
Pages _____
Recorder of _____ County

Duly Entered for Taxation
_____, 19___

Auditor