

167788



# TICOR TITLE INSURANCE

TICOR TITLE

92052759

Return To: \_\_\_\_\_

CROWN POINT OFFICE *JBM*

Tax bills to: 4500 Ryan Court, Gary, IN 46403

## WARRANTY

## This Indenture Witnesseth

That VICTOR C. JOHNSON AND LINDA A. JOHNSON, HUSBAND AND WIFE

of KENT County, and State of MICHIGAN

### CONVEY AND WARRANT

To LAWRENCE MATHEW WRIGHT AND MARY ELLEN WRIGHT, AS JOINT TENANTS WITH RIGHTS OF SURVIVORSHIP

of COOK County, in the State of ILLINOIS

for the sum of Ten Dollars and other valuable consideration

the following described REAL ESTATE in LAKE County, in the State of Indiana, to-wit: \_\_\_\_\_

LOT 35, EXCEPT THE EASTERLY 10 FEET BY PARALLEL LINES THEREOF, IN BLOCK 8 IN GLEN L. RYAN'S SECOND SUBDIVISION, IN THE CITY OF GARY, AS PER PLAT THEREOF, RECORDED IN PLAT BOOK 30 PAGE 24, IN THE OFFICE OF THE RECORDER OF LAKE COUNTY, INDIANA.

Commonly known as: 4500 RYAN COURT, GARY, IN 46403

Subject to past and current year real estate taxes.

Subject to easements, restrictions and covenants of record, if any.

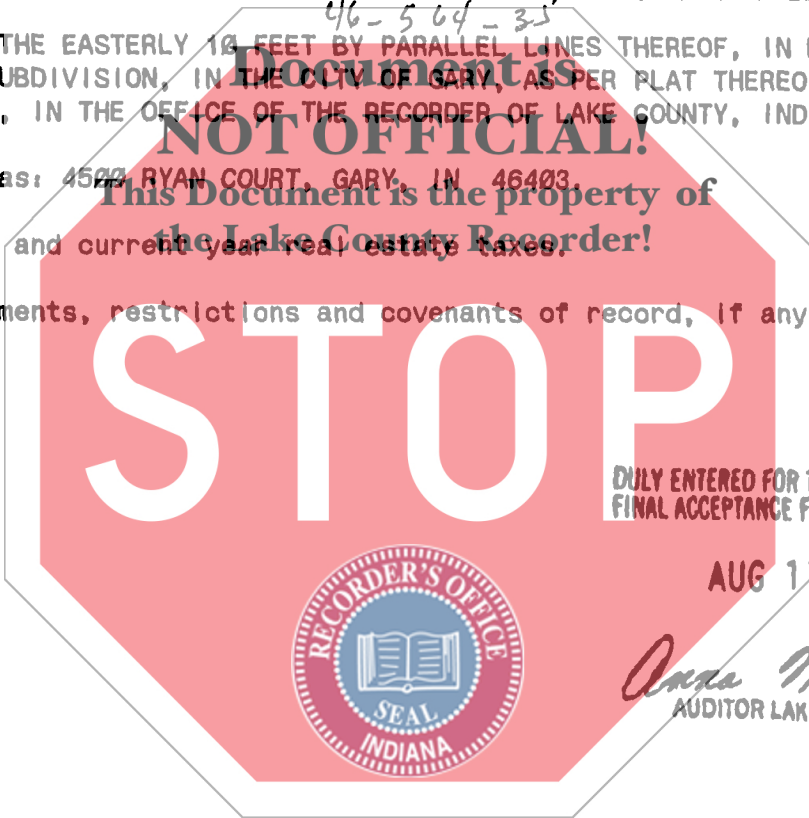

DULY ENTERED FOR TAXATION SUBJECT TO FINAL ACCEPTANCE FOR TRANSFER

AUG 17 1992

*Angie N. Anton*  
AUDITOR LAKE COUNTY



IN WITNESS WHEREOF, The said VICTOR C. JOHNSON AND LINDA A. JOHNSON, HUSBAND AND WIFE

Have hereunto set THEIR Hand S and seal this 3rd day of August, 1992

*Victor C. Johnson* (SEAL) *Linda A. Johnson* (SEAL)  
VICTOR C. JOHNSON LINDA A. JOHNSON  
\_\_\_\_ (SEAL) \_\_\_\_\_ (SEAL)  
\_\_\_\_ (SEAL) \_\_\_\_\_ (SEAL)

STATE OF INDIANA, LAKE County, ss:

Before me, the undersigned, a Notary Public in and for said County and State, personally appeared the within named VICTOR C. JOHNSON AND LINDA A. JOHNSON, HUSBAND AND WIFE

who acknowledged the execution of the foregoing Deed to be THEIR voluntary act and deed.

WITNESS, my hand and Seal this 3rd day of August, 1992  
My commission expires October 24, 1992  
*Gloria Miller*  
GLORIA MILLER Notary Public

County of Residence LAKE C/O Lawrence M. Wright  
Mail Tax Statements to 17220 S. Torrence Av. Lansing, IL 60438

This instrument prepared by ATTY. THOMAS K. HOFFMAN

00393

*700*