

Mail tax bills to:  
3512 LaPorte Street  
Highland, Indiana 46322  
**92050184**

**WARRANTY DEED**

This Indenture Witnesseth that JANET JANOTT, of Lake County in the State of Indiana, CONVEYS and WARRANTS to STEVEN L. POLSTER and DEBRA S. POLSTER, husband and wife, of Lake County in the State of Indiana, for and in consideration of Ten (10.00) Dollars and other good and valuable consideration, the receipt whereof is hereby acknowledged, the following Real Estate in the State of Indiana,

to-wit:

The East 43 feet of Lot 2 and the West 28.50 feet of Lot 3, Block 1, Highland Addition to Highland, as shown in Plat Book 26, page 19, in Lake County, Indiana, commonly described as 3512 LaPorte Street, Highland, Indiana.

This conveyance is subject to easements, covenants, rights of way, reservations, exceptions, encroachments, grants, building lines, and restrictions of record; real estate taxes for the year 1991 payable in 1992, together with all years subsequent thereto.

Key No. 27-176-2

Dated this 24th day of July, 1992.

Document is NOT OFFICIAL

This Document is the property of the Lake County Recorder!

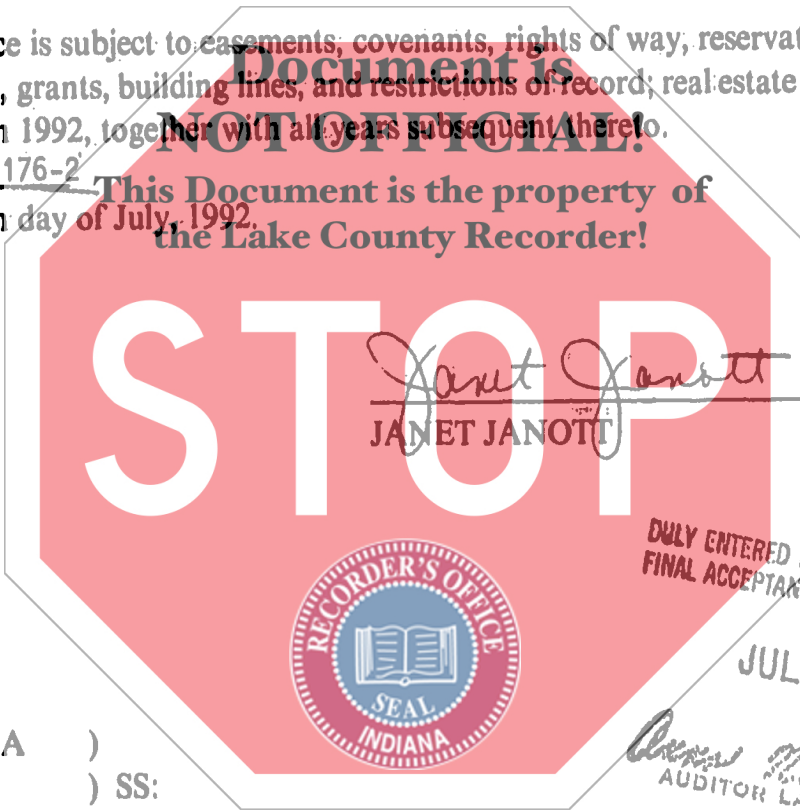

*Janet Janott*  
JANET JANOTT

Aug 1 23 PM '92  
ROBERT H.

DULY ENTERED FOR TAXATION SUBJECT TO FINAL ACCEPTANCE FOR TRANSFER.

JUL 31 1992

*Debra S. Polster*  
AUDITOR LAKE COUNTY

STATE OF INDIANA )  
                                  ) SS:  
COUNTY OF LAKE )

Before me, the undersigned, a Notary Public in and for said County and State, this 24th day of July, 1992, personally appeared JANET JANOTT, and acknowledged the execution of the foregoing deed.

In Witness whereof, I have hereunto subscribed my name and affixed my official seal.

*Julia J. Quisenberry*  
Julia J. Quisenberry, Notary Public  
Resident of Newton County, Indiana

My Commission Expires:

December 16, 1994

This Instrument Prepared By: Jason L. Horn, Attorney at Law  
9337 Calumet Avenue, Munster, IN 46321

01877

700  
OK

CHICAGO TITLE INSURANCE COMPANY  
INDIANA DIVISION  
STATE OF INDIANA  
FILED FOR RECORDS