

92042035

Warranty Deed

Parcel 2
Key No. 42-235-25

THIS INDENTURE WITNESSETH, That Donna Pavel and Nick Vasil

COMMUNITY TITLE CO
FILE NO. 11887

of Lake County, in the State of Indiana Convey and Warrant

to William S. Beith and Rhonda K. Beith, Husband and Wife

of Lake County, in the State of Indiana, for and in consideration of the sum of

Ten dollars (\$10.00) and other good and valuable consideration.

the receipt whereof is hereby acknowledged, the following described Real Estate in Lake County, in the State of Indiana, to-wit:

Lot 25 in Block 9 in George and William Earle's Second Glen Park Addition to Gary, as per plat thereof. Recorded February 9, 1911 in Plat Book 9 page 19, in the Office of the Recorder of Lake County, Indiana, at 396 1/2 Washington Street, Gary, Indiana.

Tax Key No. 42-235-25 Unit No. 25

Subject to real estate taxes for 1991, due and payable in 1992 and thereafter, and subject to all covenants, conditions, restrictions and easements of record.

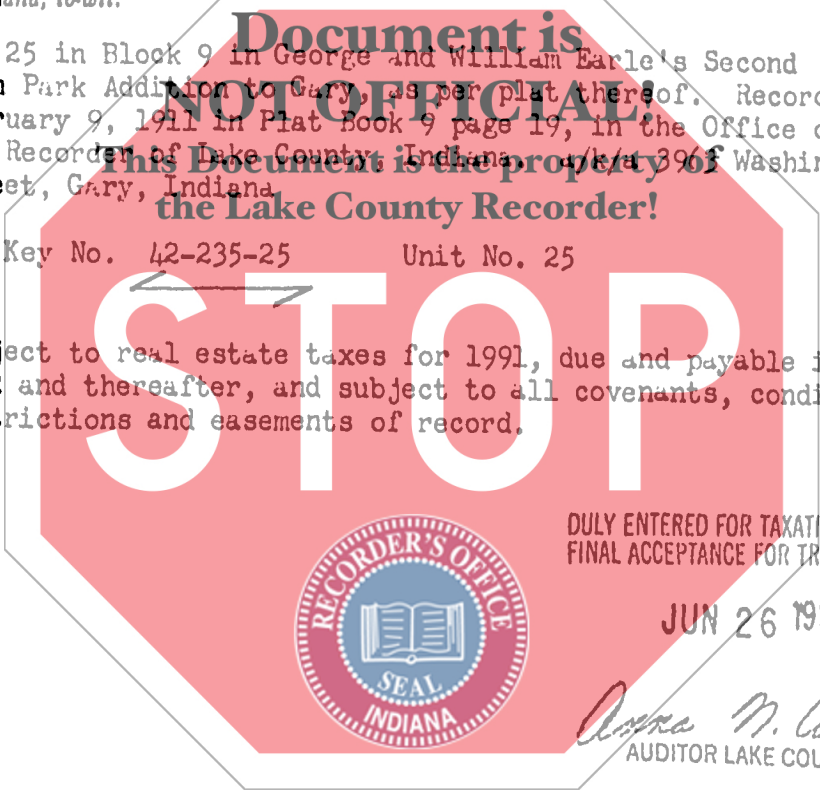

DULY ENTERED FOR TAXATION SUBJECT TO FINAL ACCEPTANCE FOR TRANSFER

JUN 26 1992

Anna M. Anton
AUDITOR LAKE COUNTY

ROBERT
JUN 30 2 29 PM '92

In Witness Whereof, The said Donna Pavel and Nick Vasil

1151

900
LM

has hereunto set their hands and seal, this 10th day of June 19 92

Donna Pavel (Seal) Nick Vasil (Seal)
(Donna Pavel) (Nick Vasil)

_____ (Seal) _____ (Seal)

_____ (Seal) _____ (Seal)

STATE OF INDIANA,

Lake

COUNTY, ss:

Before me, the undersigned, a Notary Public in and for said County, this

10th day of June 19 92, came

Document is NOT OFFICIAL!

Donna Pavel and Nick Vasil,

and acknowledged the execution of the foregoing instrument.

This Document is the property of the Lake County Recorder!

Witness my hand and official seal.

8/3/92

Don W. Shuman

Notary Public

My Commission expires
Resident of Lake County, IN

This instrument prepared by: Donna Pavel

STOP

