

166920 - Hansen

92041753

ASSIGNMENT OF REAL ESTATE MORTGAGE

TICOR TITLE INSURANCE
Merillville, Indiana

KNOW ALL MEN BY THESE PRESENTS: THAT DONALD WEBBER MORTGAGE COMPANY, INC organized and existing under and by virtue of the laws of the State of Indiana and authorized to do business in Indiana and having its principal office and place of business in the Town of Highland, State of Indiana, Party of the First Part, for value received, has granted, bargained, sold assigned, transferred and set over, and by these presents does grant, sell assign, bargain, transfer and set over without recourse and without warranty, ~~either expressed or implied, of any kind,~~ unto: Commercial Federal Mortgage Corporation
4470 Farnam Street 2nd Floor Omaha NE 68131
Party of the Second Part, its successors and assigns, a certain indenture of mortgage dated the 13th day of APRIL, 1992 made by

TED R. HANSEN, JR.
to it, securing the payment of one promissory note therein described for the sum of SEVENTY NINE THOUSAND FOUR HUNDRED SEVEN AND NO/100-----DOLLARS. (\$ 79,407.00)

and all right, title and interest in and to the premises situated in the County of LAKE, and State of Indiana and described in said mortgage as follows:

LOT 1, EXCEPT THAT PART THEREOF LYING EAST OF A LINE WHICH IS 197.25 FEET WEST OF AND PARALLEL WITH THE CENTER LINE OF COURT STREET, AND EXCEPT THAT PART THEREOF LYING WEST OF A LINE WHICH IS 280.25 FEET WEST OF AND PARALLEL WITH THE CENTER LINE OF COURT STREET IN GEO. SCHMAL ESTATES, IN THE CITY OF CROWN POINT, AS PER PLAT THEREOF RECORDED IN PLAT BOOK 30 PAGE 73, IN THE OFFICE OF THE RECORDER OF LAKE COUNTY, INDIANA.

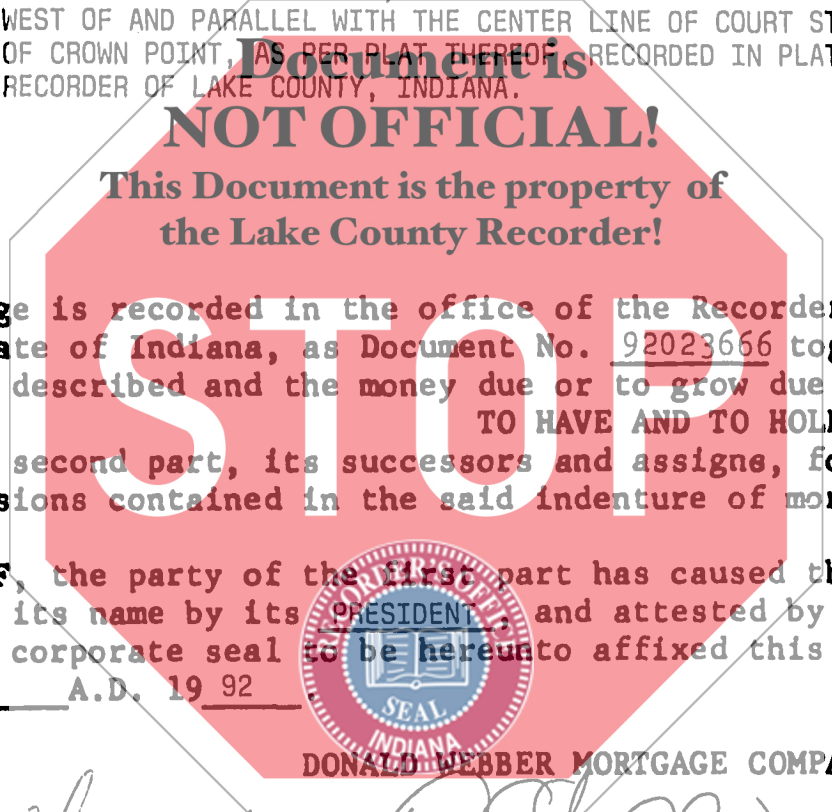

ROBERT
JUN 30 9 07 AM
STATE
FILED

Which said mortgage is recorded in the office of the Recorder of LAKE County, in the State of Indiana, as Document No. 92023666 together with the said note therein described and the money due or to grow due thereon, with the interest: **TO HAVE AND TO HOLD** the same unto the said party of the second part, its successors and assigns, forever; subject only to the provisions contained in the said indenture of mortgage.

IN WITNESS WHEREOF, the party of the first part has caused this instrument to be executed in its name by its PRESIDENT, and attested by its ~~XXXXX~~ COMPLIANCE OFFICER ~~Secretary~~ and its corporate seal to be hereunto affixed this 13th day of APRIL A.D. 1992

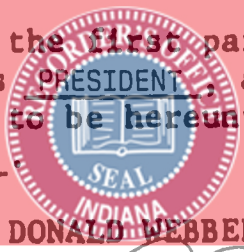

DONALD WEBBER MORTGAGE COMPANY, INC.

ATTEST: Cynthia L. Gerlach BY: D. E. Webber
SEAL CYNTHIA L. GERLACH, COMPLIANCE OFFICER D. E. WEBBER, PRESIDENT
STATE OF INDIANA
COUNTY OF LAKE

I, the undersigned, a Notary Public in and for the County and State aforesaid DO HEREBY CERTIFY that the persons whose names are subscribed to the foregoing instrument are personally known to me to be duly authorized officers of DONALD WEBBER MORTGAGE COMPANY, INC. personally known to me to be the same persons whose names are subscribed to the foregoing instrument as such officers, appeared before me this day in person and acknowledged that they signed and delivered the said instrument as their free and voluntary act and as the free and voluntary act of said corporation, for the uses and purposes therein set forth.

Given under my hand and notarial seal this 13th day of APRIL, 1992.

My Commission expires:
JANUARY 6, 1995
COUNTY OF RES.: LAKE
Donna J. Kozubal
DONNA J. KOZUBAL Notary Public

THIS DOCUMENT WAS PREPARED BY D. E. WEBBER, PRESIDENT OF DONALD WEBBER MORTGAGE COMPANY, INC. 2834 HIGHWAY AVENUE, HIGHLAND, IN 46322

700
to