

168705

Deed - Regular

THIS FORM HAS BEEN APPROVED BY THE INDIANA STATE BAR ASSOCIATION FOR USE BY LAWYERS ONLY. THE SELECTION OF A FORM OF INSTRUMENT, FILLING IN BLANK SPACES, STRIKING OUT PROVISIONS AND INSERTION OF SPECIAL CLAUSES, CONSTITUTES THE PRACTICE OF LAW AND MAY ONLY BE DONE BY A LAWYER.

Mail tax bills to: **92041723**

WARRANTY DEED

2938 - 165th Street
Hammond, IN 46323

STATE OF INDIANA
RECORDER'S OFFICE
JUN 30 9 05 AM '92

This indenture witnesseth that HELEN JAPKOWSKI and EUGENE R. JAPKOWSKI,

of Lake County in the State of Indiana

Convey and warrant to HUMBERTO M. FERNANDEZ and CELIA FERNANDEZ, Husband and Wife

of Lake County in the State of Indiana
for and in consideration of Ten Dollars (\$10.00) and other good and valuable consideration the receipt whereof is hereby acknowledged, the following Real Estate in Lake County in the State of Indiana, to wit:

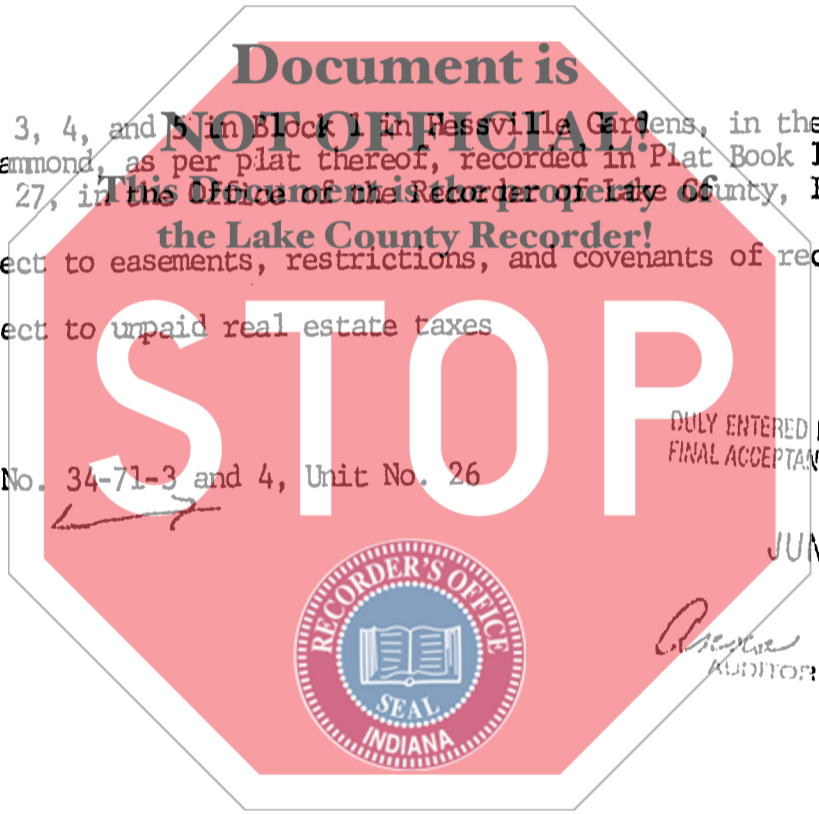

Lots 3, 4, and 5 in Block 1 in Hessville Gardens, in the City of Hammond, as per plat thereof, recorded in Plat Book 16, Page 27, in the Office of the Recorder of Lake County, Indiana.

Subject to easements, restrictions, and covenants of record.

Subject to unpaid real estate taxes

Key No. 34-71-3 and 4, Unit No. 26

DULY ENTERED FOR TAXATION SUBJECT TO FINAL ACCEPTANCE FOR TRANSFER.

JUN 24 1992

Angela M. Antos
AUDITOR LAKE COUNTY

State of Indiana, Lake County, ss:

Before me, the undersigned, a Notary Public in and for said County and State, this 15th day of June 1992 personally appeared:

HELEN JAPKOWSKI and EUGENE R. JAPKOWSKI

Dated this 15th day of June 1992

Helen Japkowski Seal
HELEN JAPKOWSKI

Eugene R. Japkowski Seal
EUGENE R. JAPKOWSKI

And acknowledged the execution of the foregoing deed. In witness whereof, I have hereunto subscribed my name and affixed my official seal. My commission expires 1-26 1995

Linda J. McBride
Linda J. McBride Notary Public

Resident of Lake County.

This instrument prepared by Steve H. Tokarski

01236
Attorney at Law

7803 West 75th Avenue, Suite 1 Schererville, IN 46375