

CONSULT YOUR LAWYER BEFORE SIGNING THIS INSTRUMENT— THIS INSTRUMENT SHOULD BE USED BY LAWYERS ONLY
92041311

KNOW ALL MEN BY THESE PRESENTS.

Schneider
#458051
ARA

That

Travelers Mortgage Services, Inc. n/k/a
GE Capital Mortgage Services, Inc.
2339 Route 70 West
Cherry Hill, NJ 08034

Insert residence, if individual or principal office, if corporation, giving street and street number.

DO HEREBY CERTIFY that the following Mortgage IS PAID; and do hereby consent that the same be discharged of record

Mortgage dated the 24th day of November, 1987, made by Robert J. Schneider and Janis A. Schneider to Travelers Mortgage Services, Inc.

In the principal sum of \$ 104,000.00 and recorded on the 30th day of November 19 87 in Liber of Section of Mortgages, page in the office of the Clerk of the County of Lake Document # 951926

CHICAGO TITLE INSURANCE COMPANY
INDIANA DIVISION

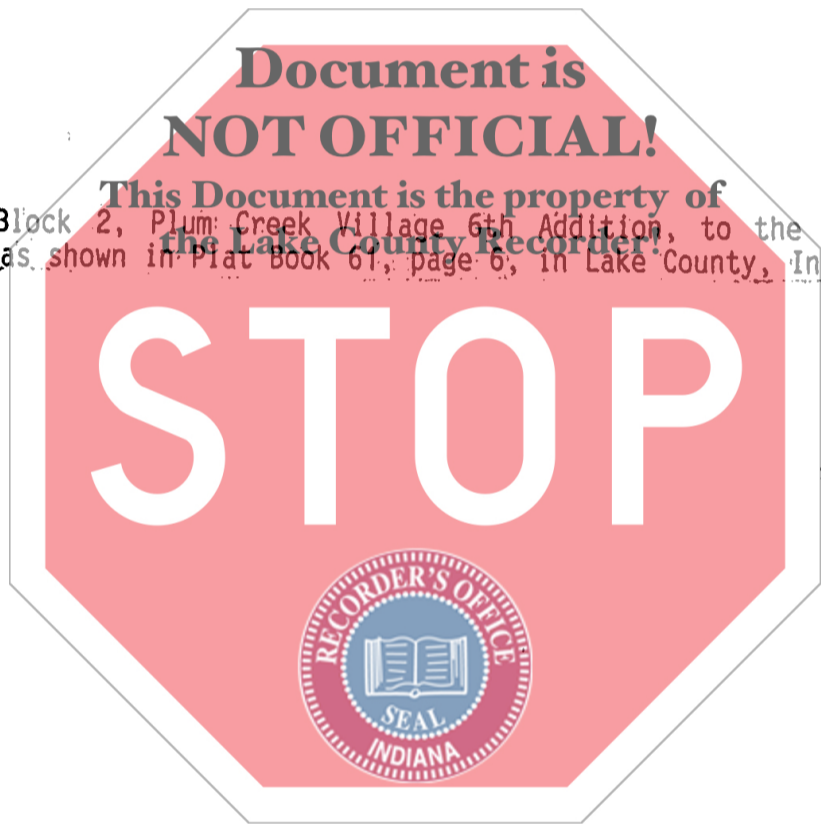

Lot 39, Block 2, Plum Creek Village 6th Addition, to the Town of Schererville, Indiana, as shown in Plat Book 61, page 6, in Lake County, Indiana.

STATE OF INDIANA
LAKE COUNTY
FILED FOR RECORD
JUN 26 10:08 AM '92
ROBERT J. SCHNEIDER
RECORDER
INDIANA

which mortgage has not been Further assigned of record
Dated the 4th day of June, 19 92

Insert "further" when required.

IN PRESENCE OF

Travelers Mortgage Services, Inc. n/k/a
GE Capital Mortgage Services, Inc.
[Signature]
Emil D. Aceto, Asst. Vice President

Section 321 of the Real Property Law expressly provides who must execute the certificate of discharge in specific cases and also provides, among other things, that (1) no certificate shall purport to discharge more than one mortgage, (except that mortgages affected by instruments of consolidation, spreader, modification or correction may be included in one certificate if the instruments are set forth in detail in separate paragraphs), (2) if the mortgage has been assigned, in whole or in part, the certificate shall set forth, (a) the date of each assignment in the chain of title of the person or persons signing the certificate, (b) the names of the assignor and assignee, (c) the interest assigned, and (d) if the assignment has been recorded, the book and page where it has been recorded or the serial number of such record, or (e) if the assignment is being recorded simultaneously with the certificate of discharge, the certificate of discharge shall so state, and (f) if the mortgage has not been assigned of record, the certificate shall so state; (3) if the mortgage is held by any fiduciary, including an executor or administrator, the certificate of discharge shall recite the name of the court and the venue of the proceedings in which his appointment was made or in which the order or decree vesting him with such title or authority was entered.

900

STATE OF NEW YORK, COUNTY OF ss:

On the day of 19 , before me personally came

to me known to be the individual described in and who executed the foregoing instrument, and acknowledged that executed the same.

Jersey.

STATE OF NEW YORK, COUNTY OF Camden ss:

On the 4th day of June 1992 , before me personally came Emil D. Aceto

to me known, who, being by me duly sworn, did depose and say that he resides at No. 2339 Route 70 West Cherry Hill, NJ 08034

that he is the Asst. Vice President of GE Capital Mortgage Services, Inc.

the corporation described in and which executed the foregoing instrument; that he knows the seal of said corporation; that the seal affixed to said instrument is such corporate seal; that it was so affixed by order of the board of directors of said corporation, and that he signed his name thereto by like order.

STATE OF NEW YORK, COUNTY OF ss:

On the day of 19 , before me personally came

to me known to be the individual described in and who executed the foregoing instrument, and acknowledged that executed the same.

STATE OF NEW YORK, COUNTY OF ss:

On the day of 19 , before me personally came

the subscribing witness to the foregoing instrument, with whom I am personally acquainted, who, being by me duly sworn, did depose and say that he resides at No.

; that he knows to be the individual

described in and who executed the foregoing instrument; that he, said subscribing witness, was present and saw

execute the same; and that he, said witness, at the same time subscribed his name as witness thereto.

Document is NOT OFFICIAL!

This Document is the property of the Lake County Recorder!

Tammy Brown

TAMMY BROWN
NOTARY PUBLIC OF NEW JERSEY
MY COMMISSION EXPIRES NOVEMBER 12, 1996

Satisfaction of Mortgage

Title No. _____

TO

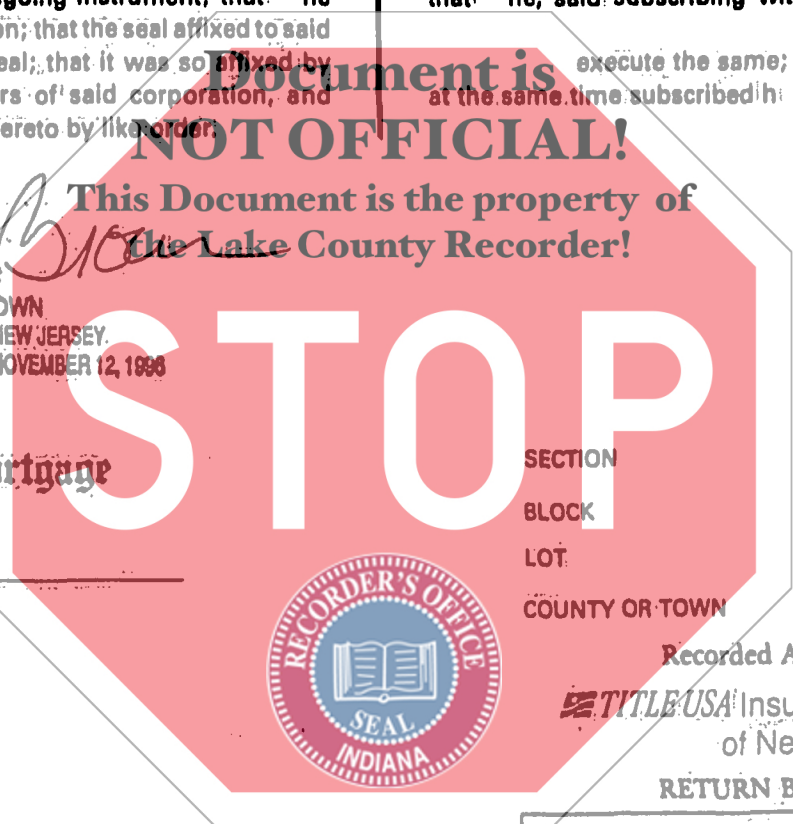

SECTION
BLOCK
LOT
COUNTY OR TOWN

Recorded At Request of
TITLE USA Insurance Corporation
of New York

RETURN BY MAIL TO:

Standard Form of New York
Board of Title Underwriters
Distributed by
TITLE USA Insurance Corporation
of New York

Zip No.

RESERVE THIS SPACE FOR
USE OF RECORDING OFFICE