

THIS FORM HAS BEEN APPROVED BY THE INDIANA STATE BAR ASSOCIATION FOR USE BY LAWYERS ONLY. THE SELECTION OF A FORM OF INSTRUMENT, FILING IN BLANK SPACES, STRIKING OUT PROVISIONS AND INSERTION OF SPECIAL CLAUSES, CONSTITUTES THE PRACTICE OF LAW AND MAY ONLY BE DONE BY A LAWYER.

Mail tax bills to:
Mary Alice Snyder
1938 Hamilton St.
Portgae, IN 46368

92040792

Tax Key No. _____

WARRANTY DEED

This indenture witnesseth that TERRY BEWLEY

of Porter County in the State of Indiana

Conveys and warrants to MARY ALICE SNYDER

STATE OF IN
LAKE
FILED FC
JUN 25 6 45 AM '92
ROBERT
REC
AND

of Porter County in the State of Indiana
for and in consideration of Ten dollars and other good and valuable considerations
the receipt whereof is hereby acknowledged, the following Real Estate in Lake County
in the State of Indiana, to wit:

The North 59.26 feet of Lots 1 & 2, Meadow Grove Addition to the City of Hammond, as shown in Plat Book 13, page 8, Lake County, Indiana.

Commonly known as: 6544 Meadow Lane, Hammond, Indiana

Key No. 35-66-1

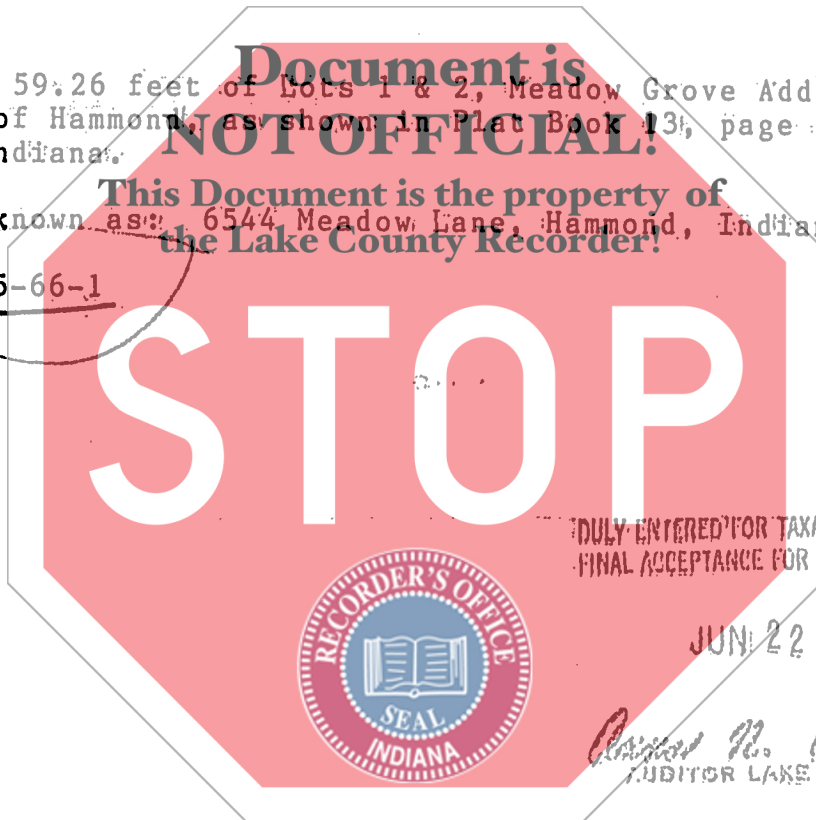

State of Indiana, Porter County, ss:

Before me, the undersigned, a Notary Public in and for said County and State, this 14th day of May 1992 personally appeared:

TERRY BEWLEY

Dated: this 14th Day of May 1992

Terry L. Bewley

TERRY BEWLEY

And acknowledged the execution of the foregoing deed. In witness whereof, I have hereunto subscribed my name and affixed my official seal. My commission expires March 6 1996

Betty Jean Gesin
Betty Jean Gesin Notary Public

Resident of Lake County

This instrument prepared by Mark A. Roscoe, 3437 Airport Road, Portage, IN 46368 Attorney at Law

MAIL TO: Harper & Rogers Atty's
304 W U.S. Hwy 6
Valpo, IN 46383

01193