

THIS FORM HAS BEEN APPROVED BY THE INDIANA STATE BAR ASSOCIATION FOR USE BY LAWYERS ONLY. THE SELECTION OF A FORM OF INSTRUMENT, FILLING IN BLANK SPACES, STRIKING OUT PROVISIONS AND INSERTION OF SPECIAL CLAUSES, CONSTITUTES THE PRACTICE OF LAW AND MAY ONLY BE DONE BY A LAWYER.

Mail tax bills to: 92038791

Tax Key No.: 13-260-5

8863 MATHEWS
CROWN POINT, IN.

WARRANTY DEED

COMMUNITY TITLE CO.
FILE NO. L4749

This indenture witnesseth that GARRY E. HUMAN AND CYNTHIA M. HUMAN

of LAKE County in the State of INDIANA

Convey and warrant to KARAM ABBASSI

of COOK County in the State of ILLINOIS

for and in consideration of Ten Dollars (\$10.00) and other good and valuable consideration the receipt whereof is hereby acknowledged, the following Real Estate in LAKE County in the State of Indiana, to wit:

STATE OF INDIANA
LAKE COUNTY
FILED FOR RECORD
JUN 16 1 59 PM '92
ROBERT H. HUBBARD

LOT 321 IN PINE ISLAND RIDGE, UNIT 15, AS PER PLAT THEREOF, RECORDED JULY 12, 1976 IN PLAT BOOK 46 PAGE 73, IN THE OFFICE OF THE RECORDER OF LAKE COUNTY, INDIANA.

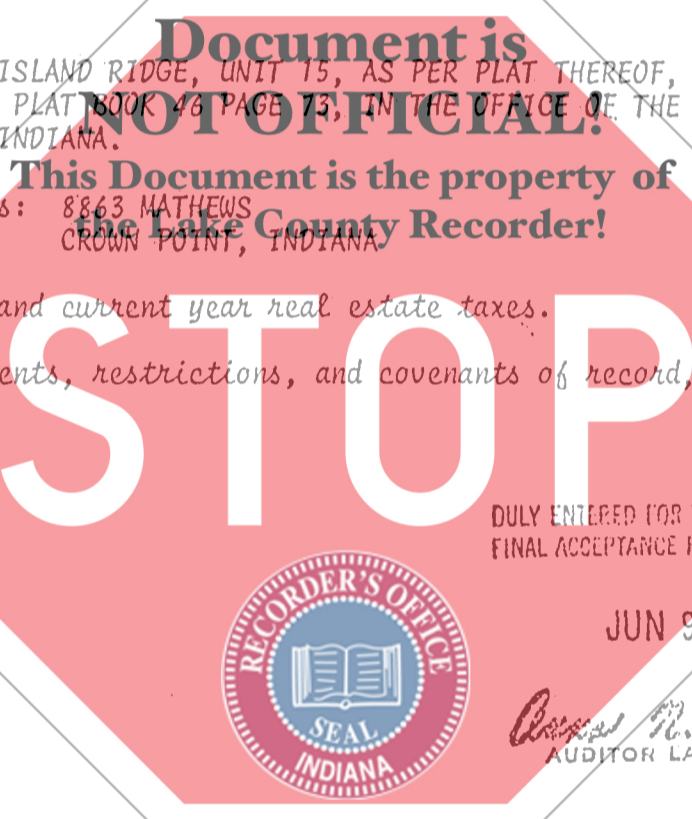

Commonly known as: 8863 MATHEWS
CROWN POINT, INDIANA

Subject to past and current year real estate taxes.

Subject to easements, restrictions, and covenants of record, if any.

DULY ENTERED FOR TAXATION SUBJECT TO FINAL ACCEPTANCE FOR TRANSFER.

JUN 9 1992

Anna M. Butler
AUDITOR LAKE COUNTY

State of Indiana, Lake County, ss:
Before me, the undersigned, a Notary Public in and for said County and State, this 15th day of May 19 92 personally appeared:

GARRY E. HUMAN AND CYNTHIA M. HUMAN

Dated this 15th Day of May 1992

Garry E. Human

Garry E. Human

Cynthia M. Human

Cynthia M. Human

And acknowledged the execution of the foregoing deed. In witness whereof, I have hereunto subscribed my name and affixed my official seal. My commission expires August 3, 19 92

Daniel W. Slusser
Daniel W. Slusser Notary Public

Resident of Lake County.

This instrument prepared by PAUL GIORGI, 2100 N. Main Street, Crown Point, Indiana 46307 Attorney at Law

700
AM
00255