

953 E. South St.
C.P. 46307

92037828

Real Estate Mortgage

This Indenture Witnesseth, That *Catherine H. Nash*

of *Lake* County, in the State of *Indiana*
Mortgage and Warrant to *Madeline Mary Merkel*

of *Lake* County, in the State of *Indiana*, the following described
Real Estate in *Lake* County, in the State of Indiana, as follows, to-wit:

Lot 61, Breauval Unit 2, Cron Pt. In.
as shown in Plat Book 39 page 71 in Lake
County In.

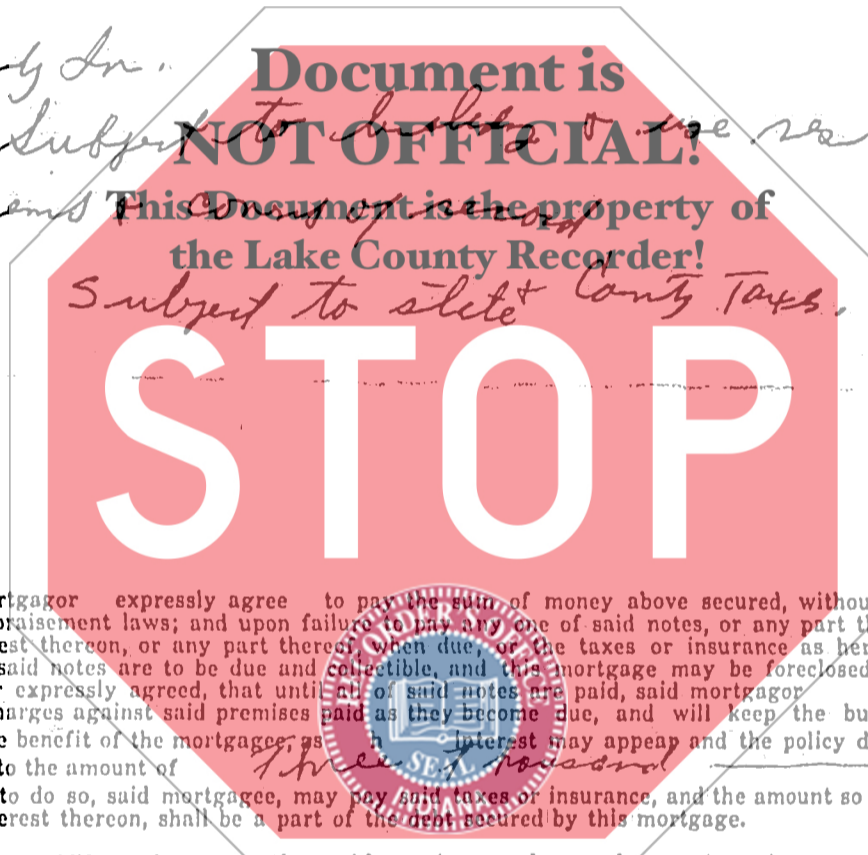

ROBERT E. BRUNFEL
RECORDER

JUN 17 8 35 AM '94

and the mortgagor expressly agree to pay the sum of money above secured, without relief from valuation or appraisal laws; and upon failure to pay any one of said notes, or any part thereof, at maturity, or the interest thereon, or any part thereof, when due, or the taxes or insurance as hereinafter stipulated, then all of said notes are to be due and collectible, and this mortgage may be foreclosed accordingly. And it is further expressly agreed, that until all of said notes are paid, said mortgagor will keep all legal taxes and charges against said premises paid as they become due, and will keep the buildings thereon insured for the benefit of the mortgagee, as interest may appear and the policy duly assigned to the mortgagee, to the amount of *Three Thousand* Dollars, and failing to do so, said mortgagee, may pay said taxes or insurance, and the amount so paid, with per cent interest thereon, shall be a part of the debt secured by this mortgage.

In Witness Whereof, the said mortgagor ha hereunto set hands and seal this day of 19
Catherine H. Nash (Seal) _____ (Seal)
Madeline M. Merkel (Seal) _____ (Seal)
_____ (Seal) _____ (Seal)

STATE OF INDIANA, *Lake* COUNTY, ss:

Before me, the undersigned, a Notary Public in and for said County, this *9th* day of *June* 19*94*, came *CATHERINE H. NASH*

and acknowledged the execution of the foregoing instrument.
Witness my hand and official seal.

My Commission expires *8-15-94* *Estell R. Brunfel* Notary Public

This instrument prepared by: