

THIS FORM HAS BEEN APPROVED BY THE INDIANA STATE BAR ASSOCIATION FOR USE BY LAWYERS ONLY. THE SELECTION OF A FORM OF INSTRUMENT, FILLING IN BLANK SPACES, STRIKING OUT PROVISIONS AND INSERTION OF SPECIAL CLAUSES, CONSTITUTES THE PRACTICE OF LAW AND MAY ONLY BE DONE BY A LAWYER.

Mail tax bills to:

Tax Key No.: 35-330-9

92036280

# WARRANTY DEED

This indenture witnesseth that PETER J. MC MINDS and JOSEPHINE M. MC MINDS  
A/K/A JOSEPHINE MC MINDS

of LAWRENCE County in the State of INDIANA

Convey and warrant to ADEL HADDAD and PATRICIA HADDAD

of LAKE County in the State of INDIANA

for and in consideration of TEN DOLLARS (\$10.00) and other good and valuable consideration, the receipt whereof is hereby acknowledged, the following Real Estate in the State of Indiana, to wit:

Lot 11 and the South 1/2 of Lot 10, Block 7, Rolling Mill Addition to Hammond, as shown in Plat Book 1, page 105, Lake County, Indiana.

SUBJECT to all liens, taxes, easements, restrictions and covenants of record.

MORE COMMONLY KNOWN AS: 4325 Henry Street, Hammond, IN.

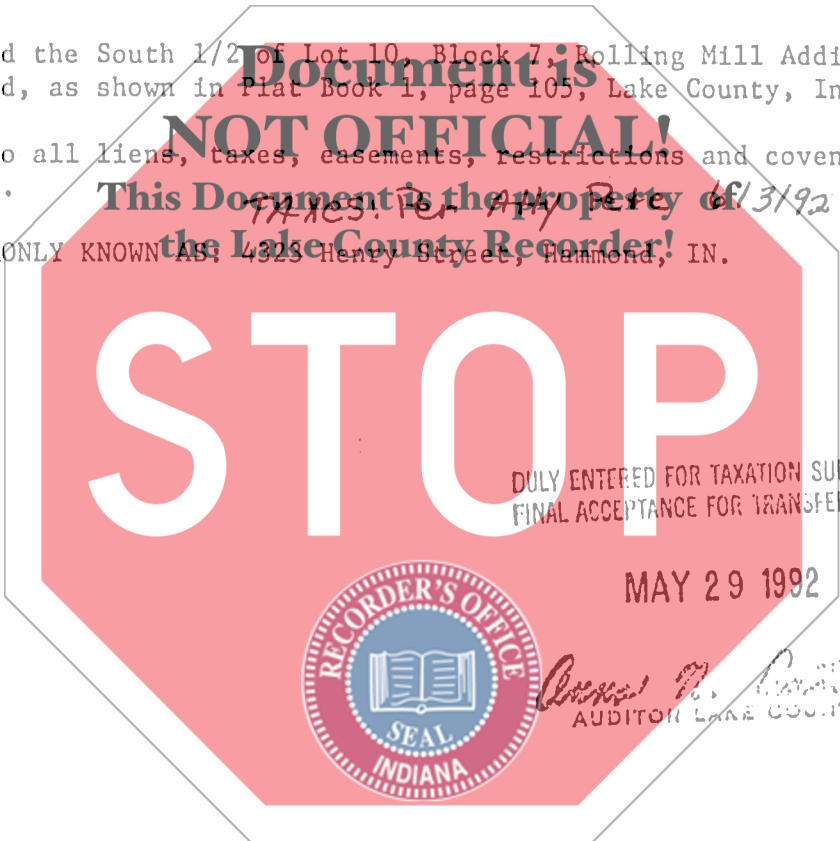

STATE OF INDIANA  
LAKE COUNTY  
FILED FOR RECORD  
JUN 5 12 53 PM '92  
ROBERT HEGG  
CLERK

State of Indiana, LAKE County, ss:

Dated this 20th Day of May 1992

Before me, the undersigned, a Notary Public in and for said County and State, this 20th day of May 19 92 personally appeared:

Peter J. McMind  
PETER J. MC MINDS

MARY ANNE AHLBORN with POWER OF ATTORNEY FOR PETER J. MC MINDS and JOSEPHINE M. MC MINDS

Josephine M. McMind  
JOSEPHINE M. MC MINDS

And acknowledged the execution of the foregoing deed. In witness whereof, I have hereunto subscribed my name and affixed my official seal. My commission expires 11/27/1995

VICTORIA A. HADRICK  
NOTARY PUBLIC STATE OF INDIANA  
LAKE COUNTY  
MY COMMISSION EXP. NOV 27, 1995  
Resident of LAKE County.

This instrument prepared by VLADIMIR GASTEVICH,

01254 Attorney at Law

MAIL TO:

Robert A. Pelt  
One Professional Ctr. Ste. 315 C/P-46307

COPYRIGHT THE ALLEN COUNTY INDIANA BAR ASSOCIATION, INC.

Nov. 8/87